

State of South Carolina

199

Pursuant to a warrant from John Thomas Esq. Commissioner of Locations the 7th of Aug. 1784. I have admeasured & laid out unto John Busham Junr. a Tract containing Six Hundred acres of Land Situated in Ninety six Dist. Below the ancient Boundary line on Saluda River Bounded N^o on the Widow Brooks Land W^o on Benajahs Thomsons Land all other sides by S^o River and hath such Stake & marks as the annexed plat Represents Survey the 2nd of Nov. 1784.



To J^o Thomas Esq. Commissioner of Locations
Recorded the 9th of Nov. 1784

State of South Carolina
Pursuant to a warrant from John Thomas Esq. Commissioner of Locations dated the 13th of Oct. 1784. I have admeasured and laid out unto Benajahs Thomsons a Tract of 388 acres of Land Situated in ninety six District Below the ancient Boundary line on Saluda River Bounded E^o on the Widow Brooks & John Busham & on Samuel Browns S^o on said River and hath such Stake and marks as the above plat Represents Survey the 2nd of Nov. 1784.

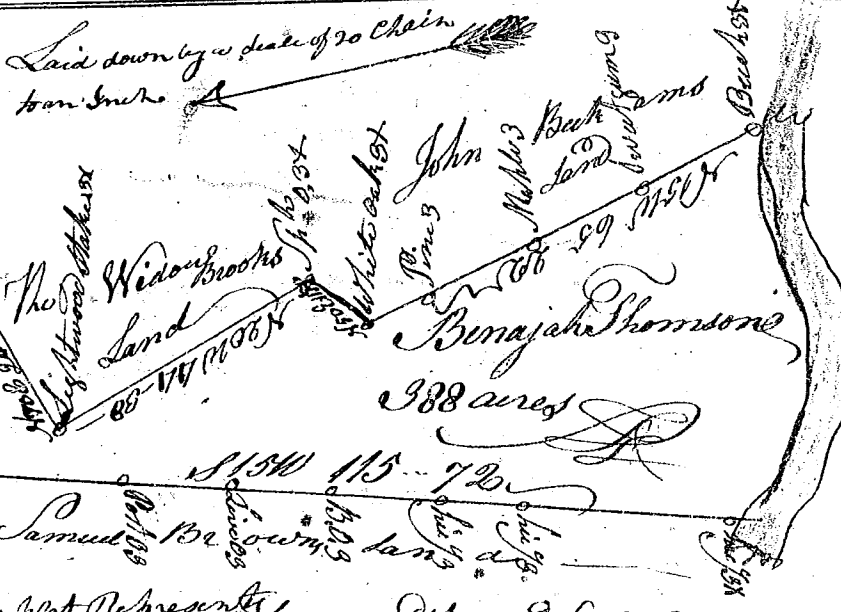

Recorded the 9th of Nov. 1784
To J^o Thomas Esq. Commissioner of Locations
Recorded the 14th of Nov. 1784

State of South Carolina

Pursuant to a Warrant from John Thomas Esq. Commissioner of Locations dated the 2nd day of October 1784. I have Admeasured and laid out unto Zachariah Bullish a tract of Land containing One Hundred and Eight acres Situate on ~~Sandy~~ District the N^o Side of Salsol River Beginning on a water ash on an Island in S^o River above Easterwoods ford. Thence N 35 W 24 Chain to a Stake Thence N 55 E 20 Chain to a Stake on Butlers line Thence E with P line 30 Chain to a Stake on Butlers line Thence S W along S^o line 30 Chain to a Stake on the River Thence up S^o River to the Beginning East of the Old Boundary and hath such Stake & marks as the annexed plat Represents Survey the 2nd of Oct. 1784.



Recorded the 14th of Nov. 1784
To J^o Thomas Esq. Commissioner of Locations
Recorded the 14th of Nov. 1784