

State of South Carolina 96 District
 East of the ancient Boundary line
 Pursuant to a warrant from John Thomas Esq
 Commissioner of Locations for the South side of Saluda
 River, I have admeasured and laid out unto John
 Little a tract of land containing two hundred & twenty
 acres bounded W. by Benj. Hollands N. by James White
 all other sides vacant and hath such shape and
 marks as the annexed plat represents. Surveyed
 the 11th August 1784. J. Waters
 Recorded the 6th day of October 1784

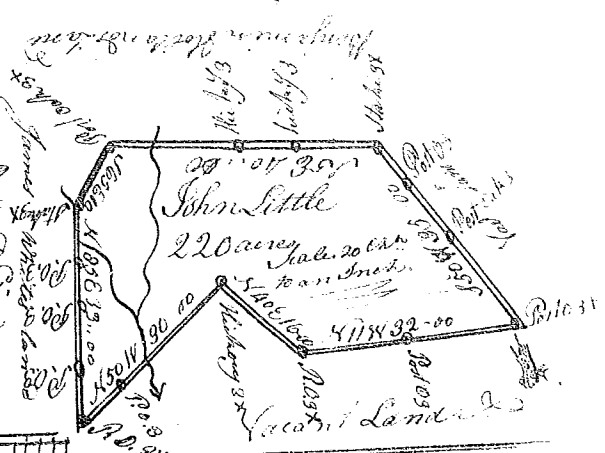

State of South Carolina 96 District
 East of the ancient Boundary line
 Pursuant to a warrant from John Thomas Esq
 Commissioner of Locations for the north
 side of Saluda River dated the 11th June
 1784. I have admeasured & laid out unto
 Drew Smith a tract of land containing
 six hundred & twenty five
 acres lying on a small branch
 of Dutchmans Cree & bounded
 by Charles Smiths land
 all other sides vacant land
 and hath such shape and marks
 as the annexed plat represents
 Surveyed June 1st 1784
 Recorded the 6th day of October 1784

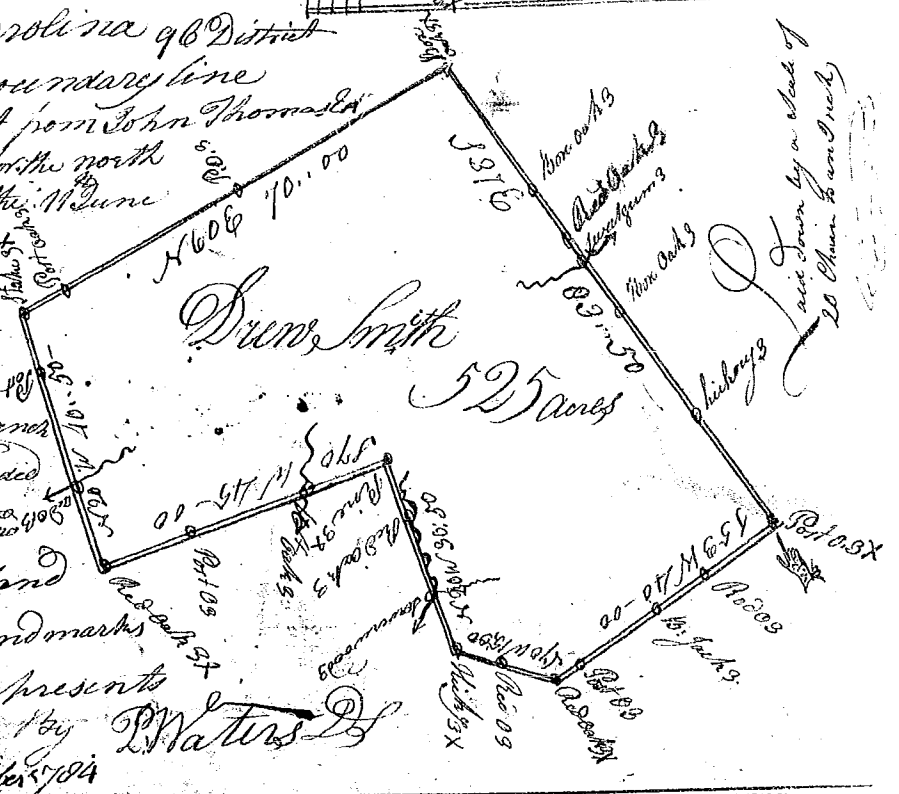

State of South Carolina Ninety Six District on the
 East side of the ancient Boundary Pursuant to
 a warrant from John Thomas Esq Commissioner of
 Locations for the South side of Saluda River dated the
 5th July 1784. I have admeasured and laid out unto
 Thomas Palmer a tract of land containing one
 hundred & fifty two acres. Lying on a small branch
 of Sugar Creek bounding E. on James Oldphank
 N.E. by Lewis Pennells & Littlefield N.W. by P. Little
 field All other sides vacant and hath such
 shape and marks as the annexed plat re-
 presents Surveyed the 11th Aug. 1784
 Recorded the 6th day of October 1784



State of South Carolina Pursuant to a warrant
 from John Thomas Esq. Commissioner of Locations
 dated the 20th day of July 1784. I have admeasured and
 William Benson a tract of one hundred & eighty seven
 acres of land situated in Ninety Six District west of the ancient
 Indian Boundary on the north side of Saluda River &
 Beaverdam creek of the S. River including ground
 for improvement bounding by the various courses
 of the S. River all other sides vacant and hath
 shape & marks as the annexed plat represents
 Recorded the 6th day of Oct. 1784 Surveyed the 20th day of July 1784

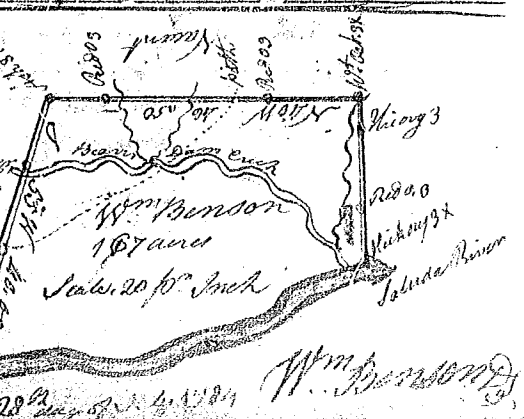

Recorded the 6th day of Oct. 1784