

State of South Carolina Ninety six District
 East of the Ancient Boundary line

Pursuant to a warrant from John Thomas Esq.
 Commissioner of Locations bearing date the 31st July 1784
 I have Admeasured & laid out unto Charles Hunt, a tract
 of Land containing One hundred & Seventy six acres
 Bounded N. by Enore River N.W. by Vacant Land N.E. by Thos
 Couch & Co. by Langston land, and hath such shape and
 marks as the annex^d plat Represents Survey^d 14th Aug 1784
 Recorded the 6th day of Oct^r 1784 L. Waters D^y

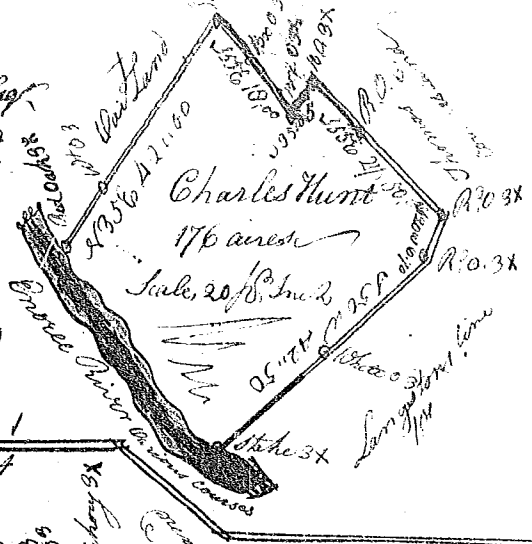

State of South Carolina Ninety six District

On the East side of the Old Boundary

Pursuant to a Warrant from John Thomas
 Esq. Commissioner of Locations on the North side
 of Saluda River dated the 1st day of June 1784

I have Admeasured & laid out unto Moses
 Purviance a tract of land containing one
 Hundred & Sixty acres. Lying on Dutchmans
 creek. Bounded S. by William Elder N. by
 Vacant Land, and hath such shape and marks
 as the annex^d plat Represents Survey^d 2nd Aug 1784
 Recorded the 6th day of Oct^r 1784 L. Waters D^y

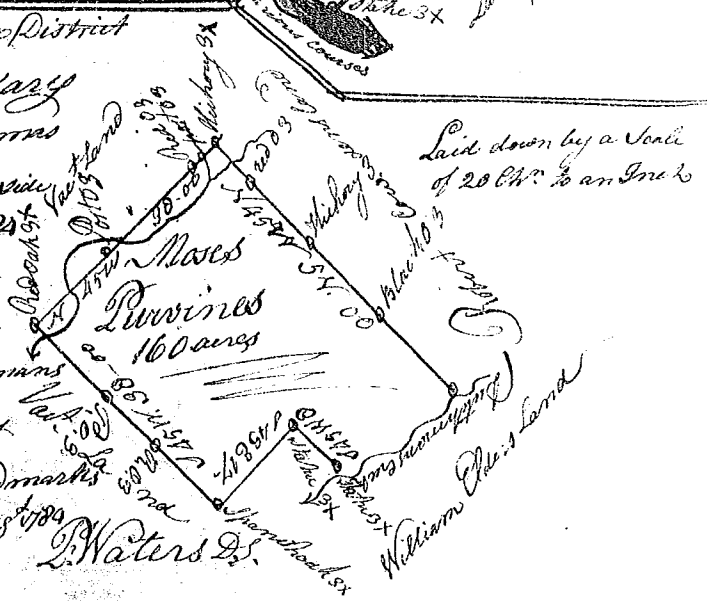

State of South Carolina 96 District

East of the ancient Boundary line

Pursuant to a warrant from John
 Thomas Esq. Commissioner of Locations on
 the North side of Saluda River dated the 5th
 day of June 1784. I have Admeasured & laid
 out unto Elisha Ford a tract of land con-
 taining four hundred acres lying on Ford
 Creek bounded on every side by Vacant Land
 and hath such shape & marks as the
 annex^d plat Represents Survey^d 2nd July 1784
 Recorded the 6th day of Oct^r 1784 L. Waters D^y

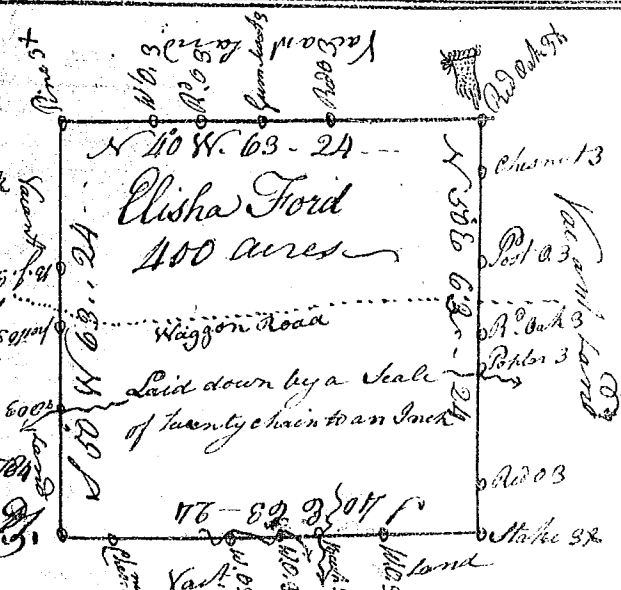

State of South Carolina Ninety six District.

East of the ancient Boundary. Pursuant to a warrant
 from John Thomas Esq. Commissioner of Locations for the
 North side Saluda River. Dated 11th Aug^t 1784. I have Admeas-
 ured & laid out unto John Little a tract of land contain-
 ing fifty eight acres lying on fairforest bounded N by the said
 J. Little East Sam. Grey the other side an old line. and hath such
 shape and marks as the annex^d plat Represents Survey^d 14th Aug 1784
 Recorded the 6th day of Oct^r 1784 L. Waters D^y

