

State of South Carolina, East of the ancient boundary line
 Pursuant to a warrant from John Thomas Esq. Commissioner
 of Locations dated the 21 day of May 1784 I have
 admeasured and laid out unto Thomas
 Blasingame a tract of Land containing
 four hundred acres lying on
 a small branch of fairforest
 called Salies branch bounded
 S.E. by M. Bees land, somewhat
 N.W. by Littlefield's land on all
 other sides vacant land, and
 hath such other shape and
 Marks as the annexed plat
 Represents.

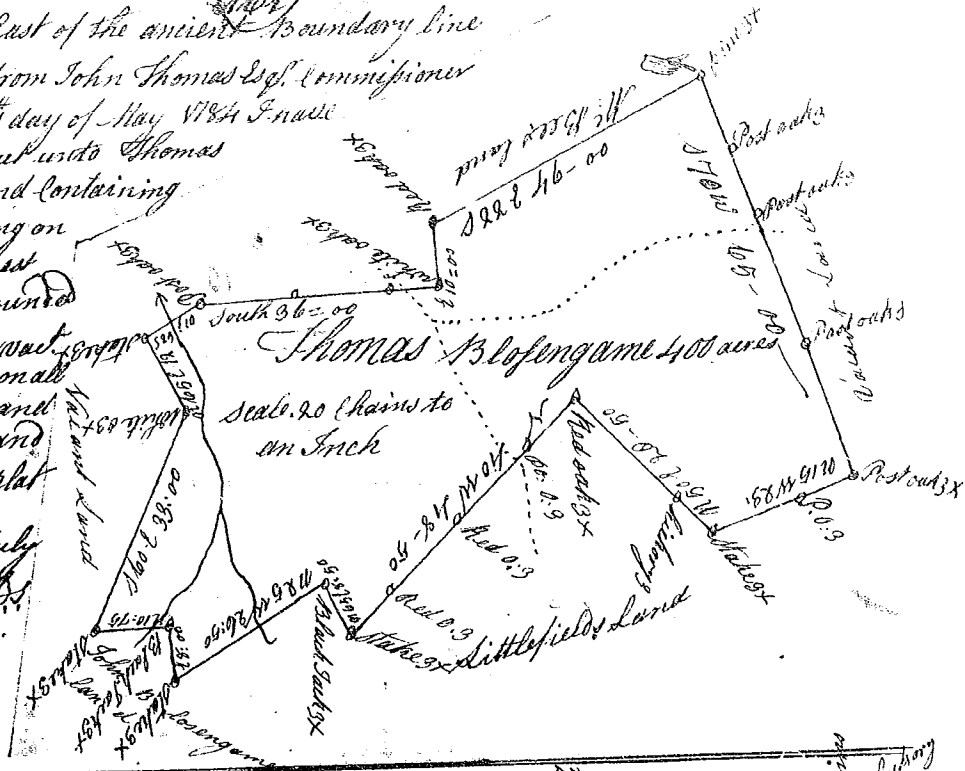

Surveyed the 2. day of July
 1784. Phil. Waters, Esq.
 Recorded 28 Sept. 1784

South Carolina
 Pursuant to a warrant from John Thomas Esq.
 Commissioner of Locations for the district of Ninety six
 North side of Saluda River, I have laid out unto Zachariah
 Kirkland a tract of containing twenty five acres of land
 Situate on the South side of broad River in said District
 bounding N on Jacob Hogie's land N.W. on Henry's land
 S.E. on Broad River, and hath such shape and Marks as the above Plat represents
 Surveyed the 10th September 1784 M. Winn Esq.
 Recorded 7.8th Sept. 1784
 Dat. M. Winn, Com. sent

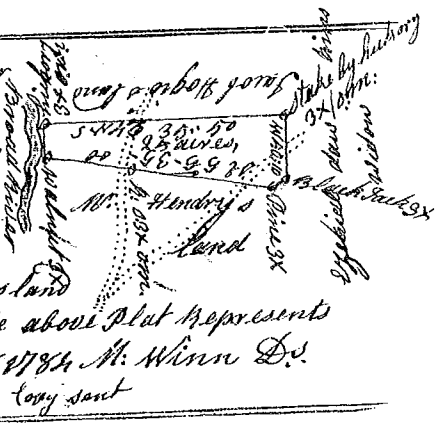

State of South Carolina
 Ninety six district East of
 the ancient boundary line

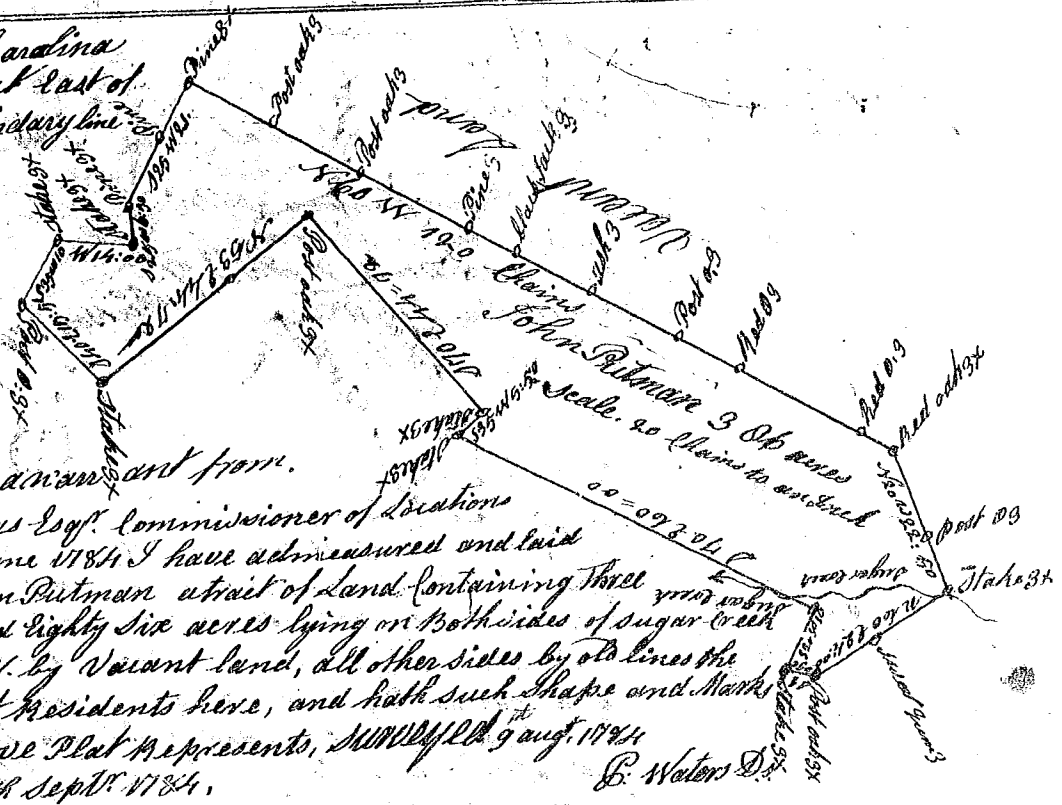

Pursuant to a warrant from
 John Thomas Esq. Commissioner of Locations
 dated 16th June 1784 I have admeasured and laid
 out unto John Putman a tract of land containing three
 hundred and eighty six acres lying on both sides of sugar creek
 bounded S.W. by Vacant land, all other sides by old lines the
 owners not residents here, and hath such shape and Marks
 as the above Plat represents, Surveyed 9 Aug. 1784
 Recorded 28th Sept. 1784,
 B. Waters Esq.