

State of South Carolina,

Pursuant to a warrant from John Thomas Esq. Commissioner of Locations I have admeasured and laid out unto John Savage a tract of 378 acres of Situate in Ninety six district on the waters of Broad River on Browns little Creek bounding on all sides N.E. on land laid out to Isaac Gregory N.W. on land laid out, all other sides on Vacant lands and land laid out, and hath such shape and Marks as the annexed Plat represents,
Surveyed 16 August 1784

David Hopkins

Recorded the 7th day Sept. 1784

D.S.

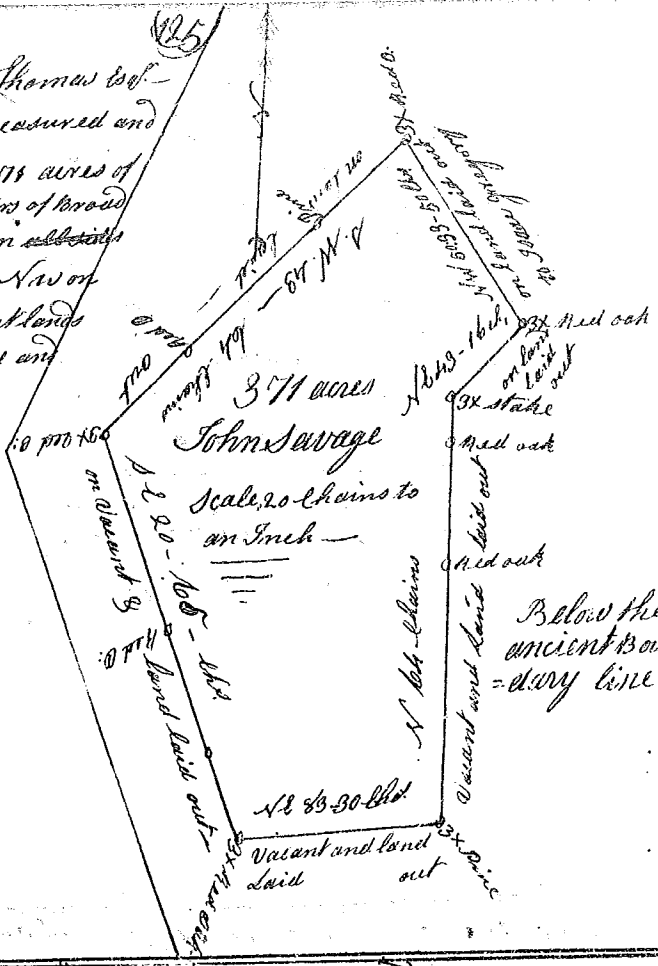

State of South Carolina

Pursuant to a warrant from John Thomas Esq. Commissioner of Locations, I have Admeasured and laid out unto William Sharp a tract of three hundred and Eight acres of land Situate in Ninety six District, bounded N.E. by Broad River S.W. by Private River N.W. on land laid out for

claimed by Mr. Cunningham and hath such shape and marks as the Annexed plat Represents. Certify the 30th day of August 1784 - David Hopkins Esq.
Recorded the 8th Sept. 1784

Laid out by a scale of 20 Chains to an Inch

William Sharp
300 acres

Deliver to Capt. Sims



State of South Carolina 96 Dist. Pursuant to a warrant to me Directed by John Thomas Esq. Commissioner of Locations for the District of the North side of Saluda River. I have Surveyed and laid out unto Hannah Young a tract of land Containing 400 Acres, Situate lying and being above the ancient boundary line on Weststrongs Creek of Saluda River. Bounded N.W. by Mrs. Anstons Land all other sides Vacant, and has such shape and marks as the Annexed plat Represents.
Surveyed by me the 18th June 1784

James Seaton D.S.

Recorded the 8th Sept. 1784

