

State of South Carolina 96 Dist. on the East side ancient Boundary line Pursuant to a warrant under the hand and seal of John Thomas Esq. Commissioner of Locations for the North side Saluda River bearing date the 9th day of June 1784 I have admeasured and laid out unto John Smith a plantation or tract of Land containing six hundred and forty acres, lying and being on a small branch of Fairforest call'd. Whitey Branch Bounded S.E. by Charles Brice's land S.W. by part by Henry White's and Vacant Land, all other sides by Vacant Land and hath such other Shape and Marks as the annexed Plat represents Survey'd June 28 1784

Recorded 17th Sept. 1784  
 Del<sup>d</sup> to Peter Smith

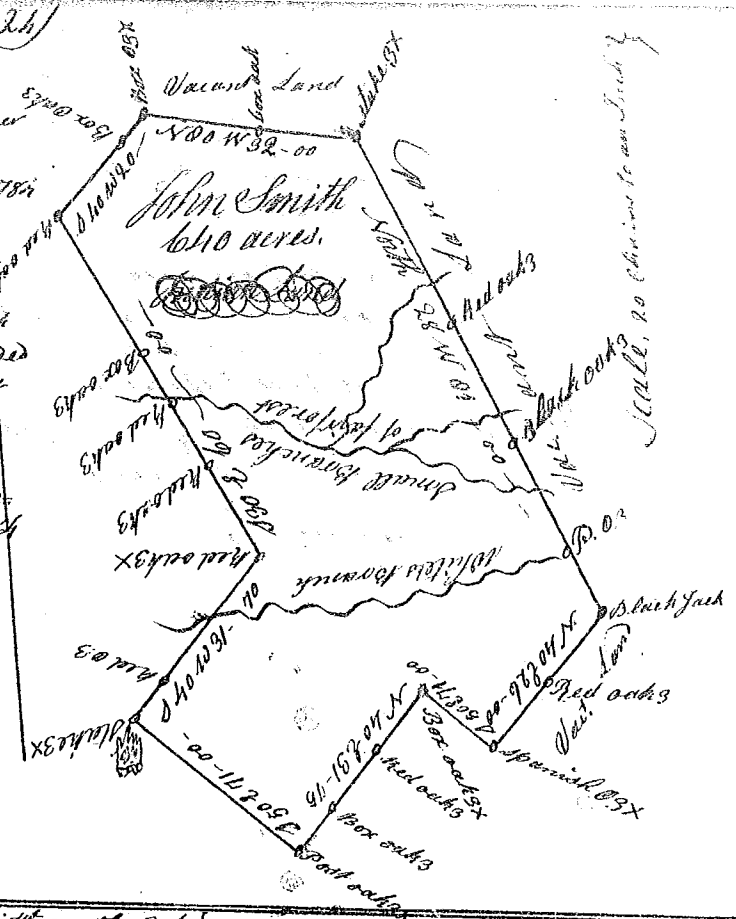
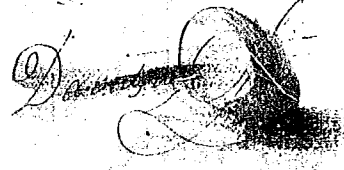

State of South Carolina 96 Dist. on the East side of Ancient Boundary Pursuant to a warrant from John Thomas Esq. Bearing date the first day of June 1784, I have Admeasured and laid out unto Fleming Smith a Tract of Land containing two hundred Acres lying on a Creek called Rebel's Creek a Branch of Fairforest, Bounded So. by Peter Smith's land Westwardly by George Stovall's Land, all other sides Vacant Land. And hath such Shape and marks as the Annexed Plat Represents. Survey'd this 24<sup>th</sup> June 1784

Recorded the 7<sup>th</sup> day of Sept. 1784  
 Del<sup>d</sup> to Peter Smith

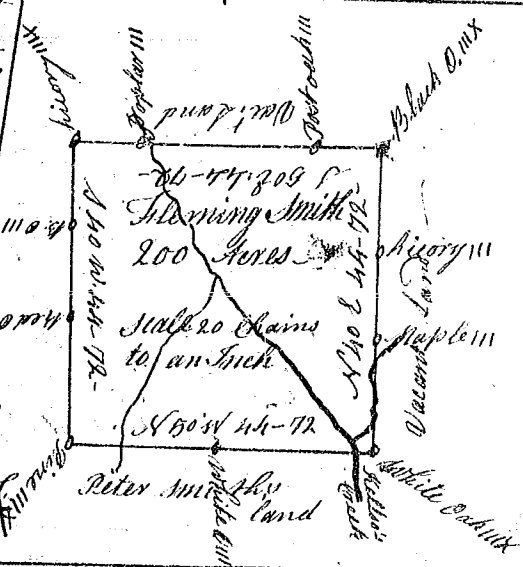

State of South Carolina Ninety six District On the East side of Ancient Boundary line Pursuant to a warrant from John Thomas Esq. Commissioner of Locations bearing date June the first 1784 I have Admeasured and lay<sup>d</sup> out unto Charles Brice a tract of land containing Eighty acres, Bounded to the S.E. by John Smith's Land & Henry White's Land and other sides on James Lusk's Land & Henry White's Shape and marks as the Annexed Plat Represents. Survey'd the 7<sup>th</sup> July 1784

Recorded the 7<sup>th</sup> Sept. 1784  
 Del<sup>d</sup> to Peter Smith

