

State of South Carolina

Pursuant to a warrant from John Thomas Esq. dated the 21 day of May 1784 I have admeasured and laid out unto Allen Gowen a tract of Two hundred and fourteen acres of Land situate in ninety six District on the sink hole fork of Sugar River Bounding N.W. of land laid out to Thomas Benson S.E. of land laid out to Michal Miller and on all other sides on vacant land and hath such shape and Marks as the annexed Plat Represents

Surveyed the 16th July 1784
Wm Benson D.

Recorded the 30 of Augt 1784
Deliver to Capt. Gowen

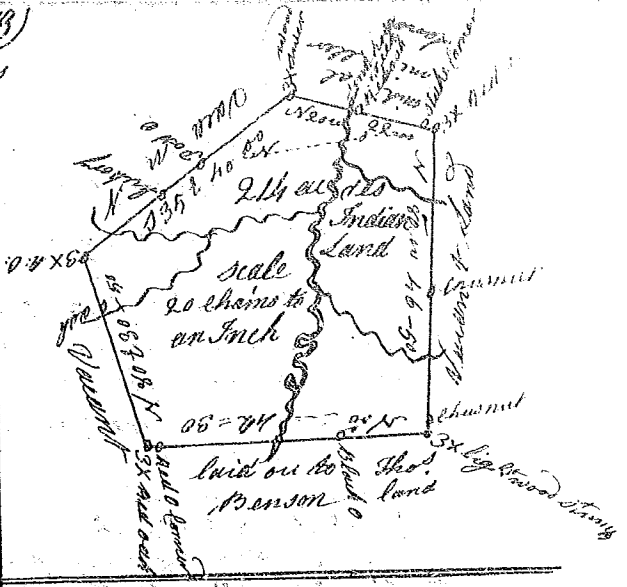

State of South Carolina

Pursuant to a warrant from John Thomas Esq. Commissioner of Locations dated the 21 day of May 1784 I have admeasured and laid out unto Jesse Chandler a tract of six hundred and forty acres of land situate in Ninety six district on Horse Creek waters of Needy River Bounding on all sides on vacant Land and hath such shape and Marks as the above annexed plat Represents, Surveyed 15th day June 1784

Wm Benson D.
Recorded the 31 day of Augt 1784

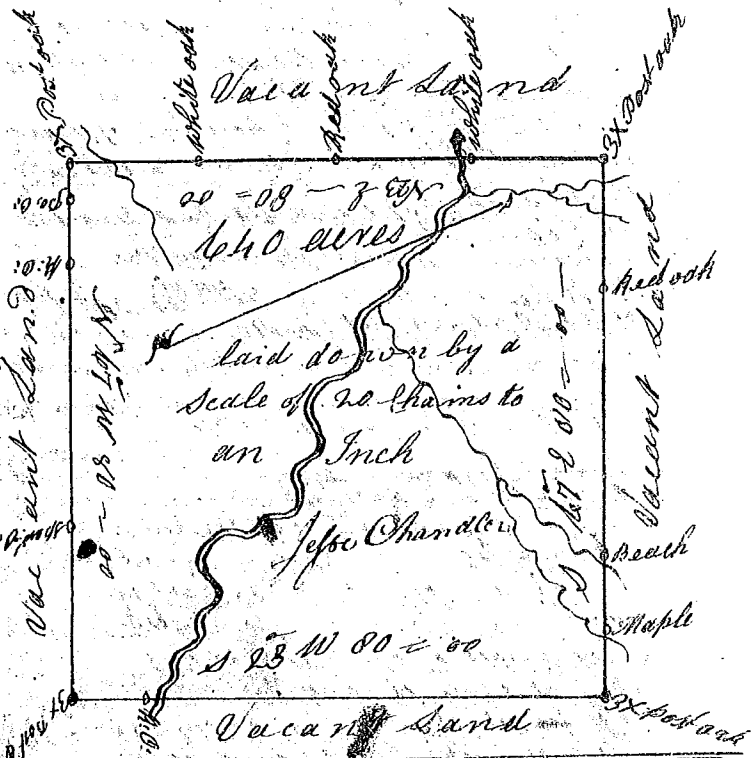

State of South Carolina

Pursuant to a warrant from John Thomas Esq. Commissioner of Locations dated the 21 day of May 1784 I have admeasured and laid out unto Robert Goodlett Esq. a tract of three hundred acres of land situate in Ninety six district on three forks of Sugar River Including Hugh Warrens Cabin Bounding on all sides on Vacant Land and hath such shape and Marks as the annexed Plat Represents Surveyed 28 May 1784

Wm Benson D.
Recorded the 31 day Augt 1784

