

State of South Carolina. Pursuant to a Warrant from John Thomas Esq. Commissioner of Locations (dated May the 25th 1784) I have Admeasured and laid out unto John Motlow a Tract of Land containing four hundred Acres situate in Ninety Six District West of the Old Indian Boundary on both sides of Ruddy River Bounding N & S on Land laid out for Col. Thomas Rawlinson Lt. and N.E. on Land laid out for Nathaniel New, all other sides on Vacant Land and hath such form and Marks as the above Plat represents
 Surveyed the 3rd day of July 1784
 George Salmon Esq. Dist.
 Recorded the 30th day of July 1784

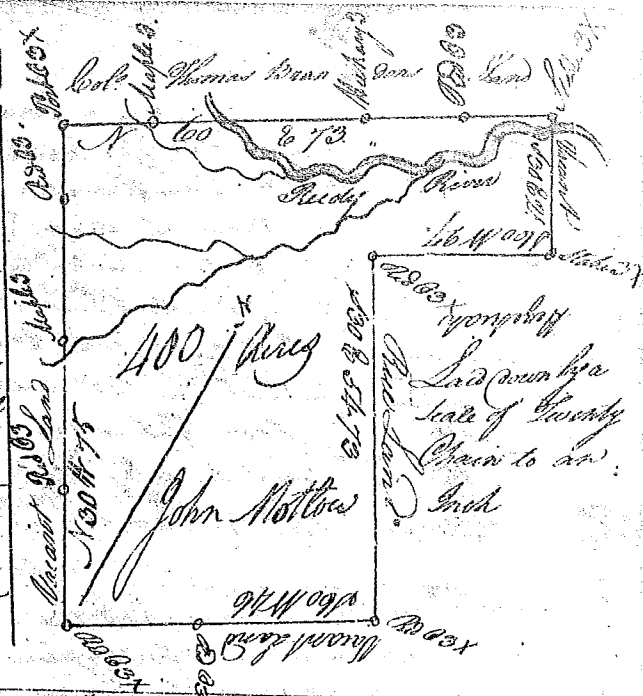

State of South Carolina

Pursuant to a warrant from John Thomas Esq. Commissioner of Locations dated the 21st day of May 1784 I have Admeasured and laid out unto John Childers Esq. a tract of Land containing two hundred acres situate in Ninety Six District on the N. side of Tupper River west of the Old Indian boundary bounding S & E on Land laid out for Jeremiah Dutton S.W. on Land laid out for Moses Wood, all other sides Vacant Land and hath such form and Marks, as the above plat represents

Surveyed the 24th day of June 1784
 George Salmon Esq.
 Recorded the 30th day of July 1784

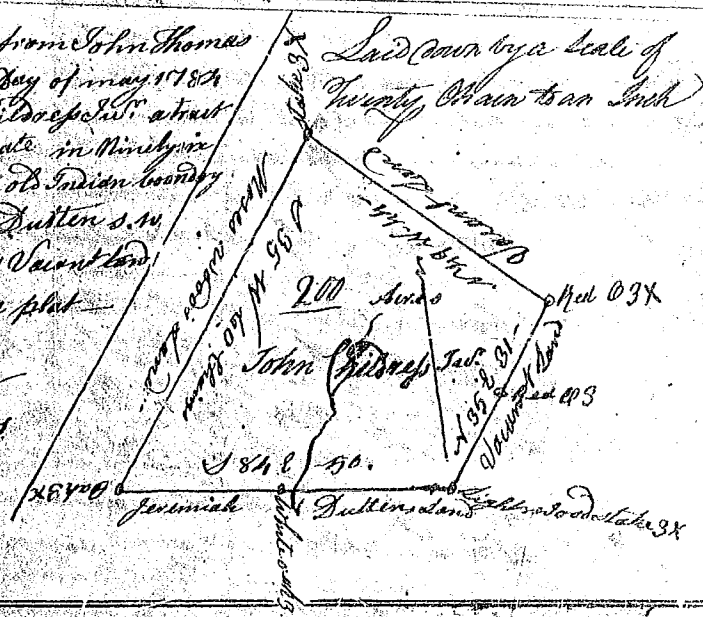

State of South Carolina Pursuant to a Warrant from John Thomas Esq. Commissioner of Locations (dated May the 25th 1784) I have Admeasured and laid out unto John Langston Esq. a Tract of Land containing six hundred and thirty nine Acres, situate in Ninety Six District West of the Old Indian Boundary on both sides of Langston's Creek of Ruddy River near Francis's Settlement Bounded on all sides by Vacant Land and hath such form and marks as the above Plat represents
 Surveyed the 11th of June 1784
 George Salmon Esq. Dist.



Recorded the 30th day of July 1784

Laid out by a scale of Twenty Chains to an Inch