

State of South Carolina Pursuant to a Warrant from John Thomas Esq. Commissioner of Locations dated May the 21st 1784 I have measured and laid out unto John Davis a Tract of Land containing Two Hundred and fifty Acres situate in Ninety six District west of the 1st Indian Boundary on both sides of Enoree River about two Miles below the Lower Indian path River on all sides on Vacant Land and hath such form and Marks as the above plat represents Surveyed the 24th day of June 1784
 Recorded July the 29th 1784 George Salmon D.S.

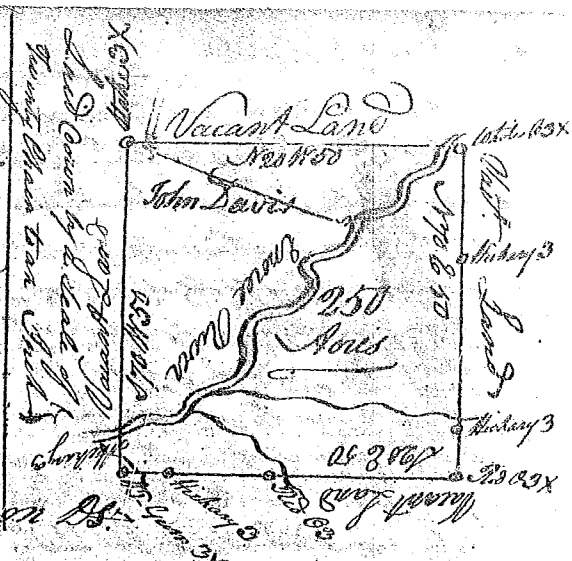

State of South Carolina Pursuant to a Warrant from John Thomas Esq. Commissioner of Locations dated May the 21st 1784 I have measured and laid out unto Joseph Duron a Tract of Land containing Two Hundred and thirty six Acres situate in Ninety six District west of the 1st Indian Boundary on both sides of Checharon River of which in the lower Indian path River on the N. & S. on land laid out for Isaac Brown and on the S.W. N.E. on land laid out Henry Wood all other sides on Vacant Land and hath such form and Marks as the above Plat represents. Surveyed the 29th of June 1784
 Recorded on the 30th day of July 1784 George Salmon D.S.

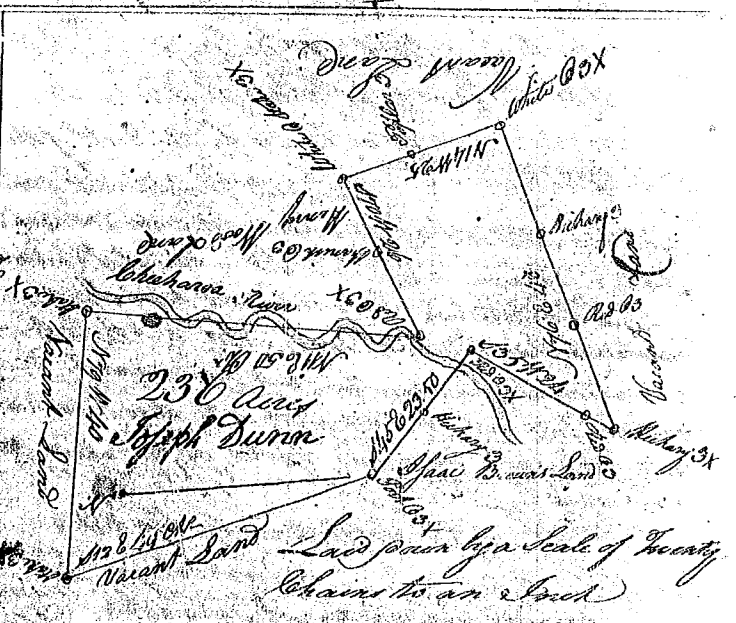

State of South Carolina Pursuant to a warrant from John Thomas Esq. Commissioner of Locations dated May the 21st 1784 I have measured and laid out unto John Childrup a Tract of Land containing six Hundred and fourteen Acres situate in Ninety six District west of the 1st Indian Boundary on both sides of Childrup River down of Enoree River bounding on the N. on land laid out for Isaac Brown on all other sides on Vacant Land and hath such form and Marks as the above Plat represents

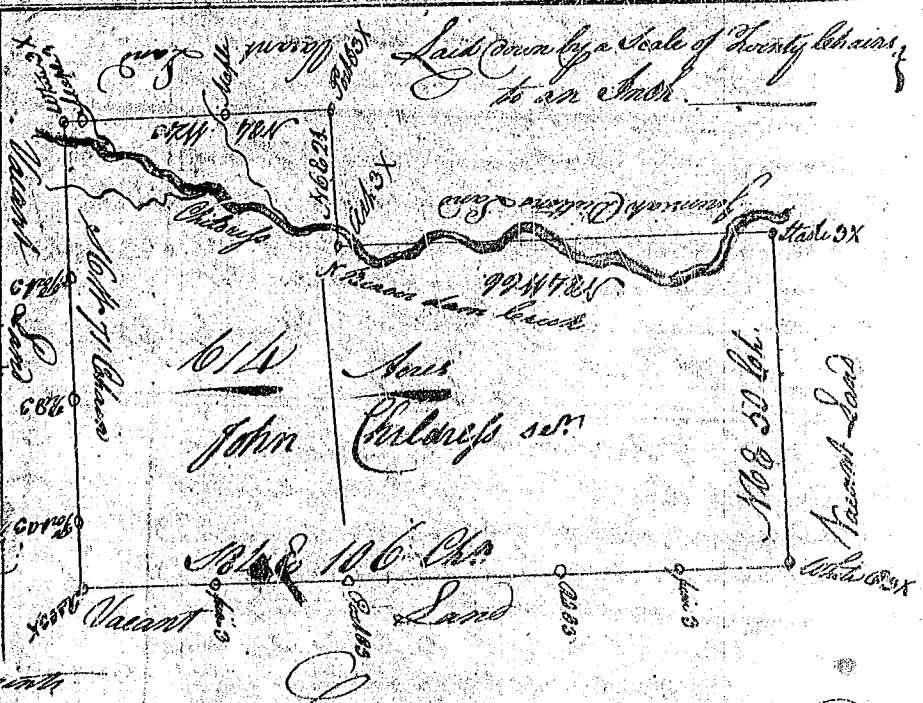

Surveyed the 18th of June 1784

Recorded the 30th of July 1784

George Salmon D.S.