

State of South Carolina

Pursuant to a warrant from John Thomas Esq. Commissioner of Locations dated the 28<sup>th</sup> of May 1784 I have measured and laid out unto James Nicholls Trust of Three Hundred and Six Acres land situate in Ninety six District on Musk Creek bounding on all sides by Vacant Land and both such shape and marks as the above Plat represents

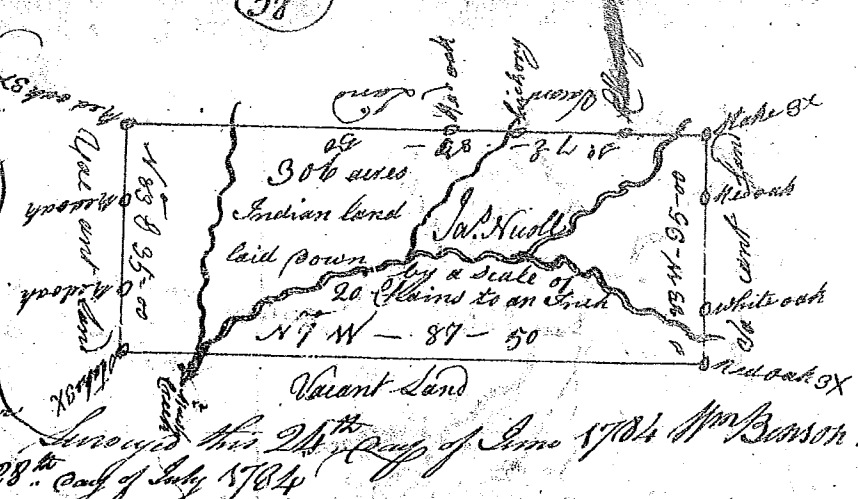

Surveyed this 28<sup>th</sup> of June 1784 by George Salmon Esq. Recorded the 28<sup>th</sup> of July 1784

State of South Carolina

Pursuant to a warrant from John Thomas Esq. Commissioner of Locations dated May 28<sup>th</sup> 1784 I have measured and laid out unto James White a tract of Land containing Two Hundred Acres situate in Ninety six District West of the old Indian Boundary on both sides of Saluda Creek of Enoree River about one mile above the old Line bounding on all sides on Vacant Land and both such form and marks as the above Plat represents

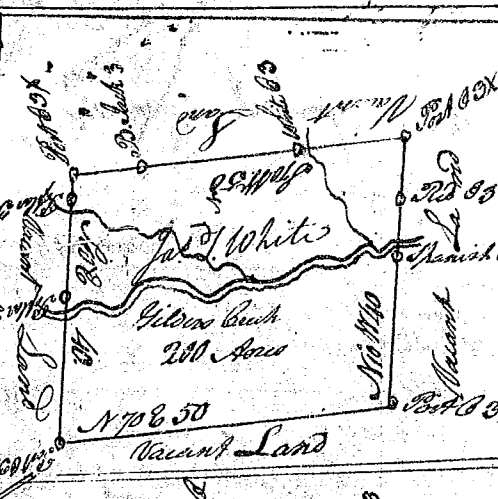

Surveyed the 17<sup>th</sup> of June 1784 by George Salmon Esq. Recorded the 28<sup>th</sup> of July 1784

State of South Carolina

Pursuant to a warrant from John Thomas Esq. Commissioner of Locations dated May 28<sup>th</sup> 1784 I have measured and laid out unto Samuel M. Jenkins a tract of Land containing Two Hundred Acres situate in Ninety six District west of the Indian Boundary on both sides of the middle fork of Saluda River about two miles above James River bounding on all sides on Vacant Land and both such form and marks as the above Plat represents



Surveyed the 27<sup>th</sup> of May 1784 by George Salmon Esq. Recorded the 28<sup>th</sup> of July 1784

State of South Carolina

Pursuant to a warrant from John Thomas Esq. Commissioner of Locations dated May 28<sup>th</sup> 1784 I have measured and laid out unto Joseph M. Jenkins a tract of Land containing Six Hundred and forty acres situate in Ninety six District West of the Indian Boundary on both sides of the Middle Fork of Saluda River including the creek on the East bounding on all other sides on Vacant Land and both such form and marks as the above Plat represents

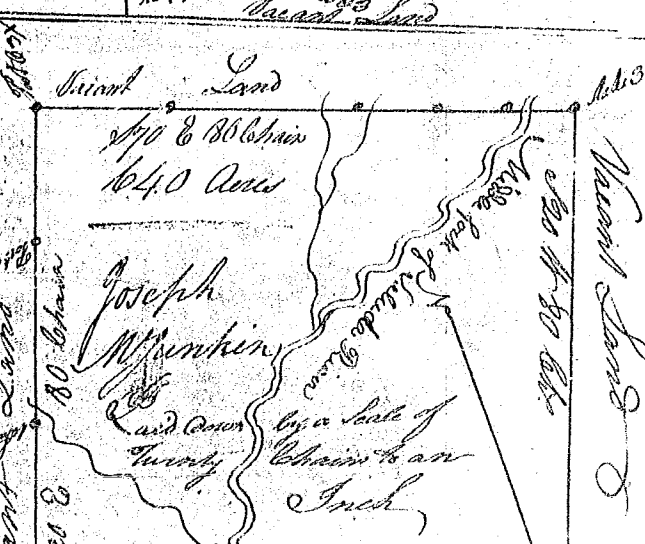

Surveyed the 27<sup>th</sup> of May 1784 by George Salmon Esq. Recorded the 28<sup>th</sup> of July 1784