

State of South Carolina,

County of Greenville.

KNOW ALL MEN BY THESE PRESENTS, That

in the State aforesaid, For, an

(the receipt whereof is hereby ack
sell and release unto the said

or lot of land, situate
lots 122, 123, 124, 125, and
acres more or less betw
head bridge, bounded by
and Pierce Street su

TOGETHER
in anywise incid

And
and forever defe

Heirs and Assign
person whomsoev

WITNESS

year of

Signed, Sealed

W. H. Martin

F. J. Williams

State of S

PERSONAL
the within name
written deed; an

SWORN to befo
of June

W. I. Green
State of S

I,

Mrs. did this day appear
any compulsion, dr

all her right and claim of
GIVEN under my hand and
day of

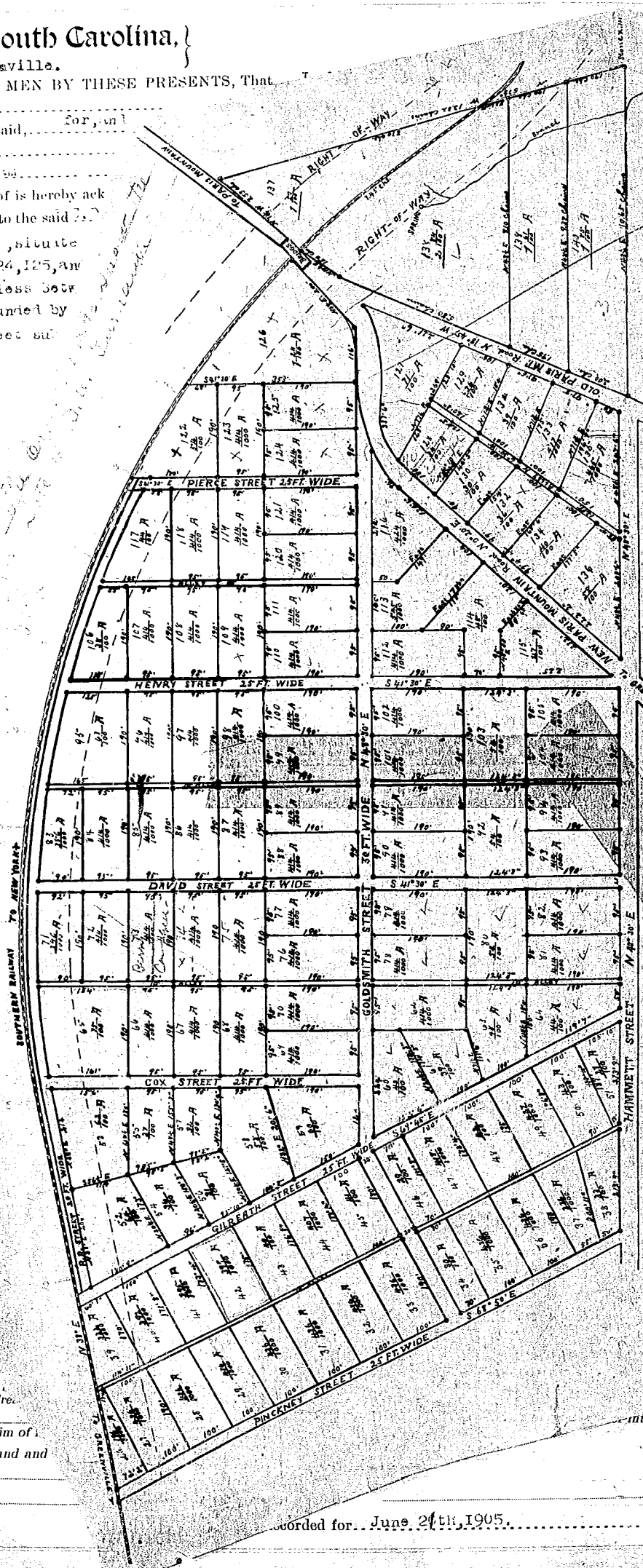

MAP SHOWING SUBDIVISION INTO BUILDING LOTS, OF LOTS 36, 37, 38, 39 & 40
OF THE HUGHES TRACT (1864 & 1865) OF THE LATE C. H. HAMMETT'S
ESTATE, LYING IN THE WEST-WEST CORNER OF THE PARIS MOUNTAIN ROAD
SURVEYED AND LAID OUT BY ME FOR THE S. C. LAND OFFICE, GREENVILLE, S. C.
JULY 3, 1905.

See Deed Book
H 1147-1149-1150-1151-1152
for further info

The first thirteen parcels, comprising 101
located on this plat

ay concern, that
tarily, and without
the within named
interest and estate, and also