

hold and I do hereby bind myself my heirs Executors and administrators to warrant and forever defend the sd Tracts of land to the said Croft his heirs and assigns against myself my heirs and assigns and every other person or persons whatsoever claiming or to claim any part thereof In witness whereof I do hereunto set my hand & seal this 16th April 1838. Signed in presence of Elk Pollard Hilgard Lee Wm Pollard Seal

South Carolina } Personally came Hilgard Lee before me the subscribing Justice and
 Greenville Dist } being sworn as the law directs saith on oath that he was present
 and saw William Pollard sign seal and deliver the within deed of conveyance
 to George Croft for the use and purpose therein mentioned and that Elk
 Pollard was a subscribing witness with himself - Sworn to and subscribed
 this 16th April 1838. Hilgard Lee
 Benjⁿ Nelson J.P. } Recorded for 10th Sept 1839.

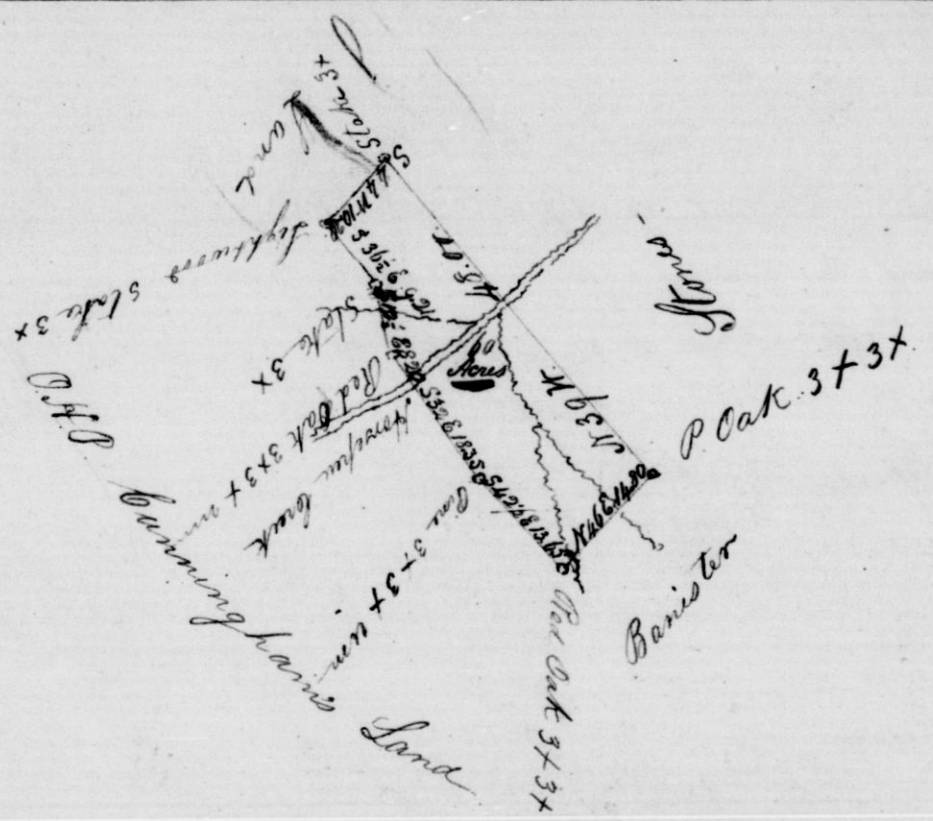

Laid down by a scale of 20 Ch for each

South Carolina } By request of William Goldsmith Esq. I have resurveyed for
 Greenville District } Dr. William Rabe a tract of land containing 60 acres situate
 in Greenville District on both sides of Horsepen Creek of Guilford's Creek waters of
 Emore River and hath such shape marks and boundaries as the above plat represents
 Resurveyed August 31st 1839 M. C. Cunningham D.S.

Recorded 11 Sept 1839

119 State of South Carolina } Know all men by these presents that I
 Greenville District } William Goldsmith of the State & District
 aforesaid in consideration of the sum of Three Hundred Dollars paid to me
 by William Rabe of the State & District aforesaid Have granted bargained sold
 & released & by these presents do grant bargain sell & release unto the said of
 William Rabe a certain tract or parcel of land containing fifty acres be the same
 more or less situate in the State & District aforesaid on both sides of Horsepen
 Creek Waters of Emore River it being a part of a tract originally granted to
 Jonathan Downes and sold to me by John Watson Esq. Ordinary of Greenville
 1st May 1837 - bounded by Banister Stone Land N. E. & N. W. and by C. H. P. Cunningham
 S. W. & S. E. Beginning on a R. O. 37 37 on Banister Stone line thence N 46 3/4 W 116 50
 to a P. O. 37 37 thence N 38 W. 48 to a stake 37 thence S 44 W. 10 20 37 37 on