

State of South Carolina
Pursuant to a warrant
from John Thomas
Esquire Commissioner
of Locations dated
the 26 day of August
1784. I have admeasured

and laid out unto Joseph
McCool a tract of land
Containing two hundred and
sixty two acres situate in ninety
six District west of the ancient boundary on the
N^o. side of Saluda River on both sides of
Middle Tyger River bounding on all sides
with such shape and marks as the above plat represents surveyed the
26 day of August 1784 by W^m William Benson D^s.
A True copy of Record
Recorded for the 28 August 1836

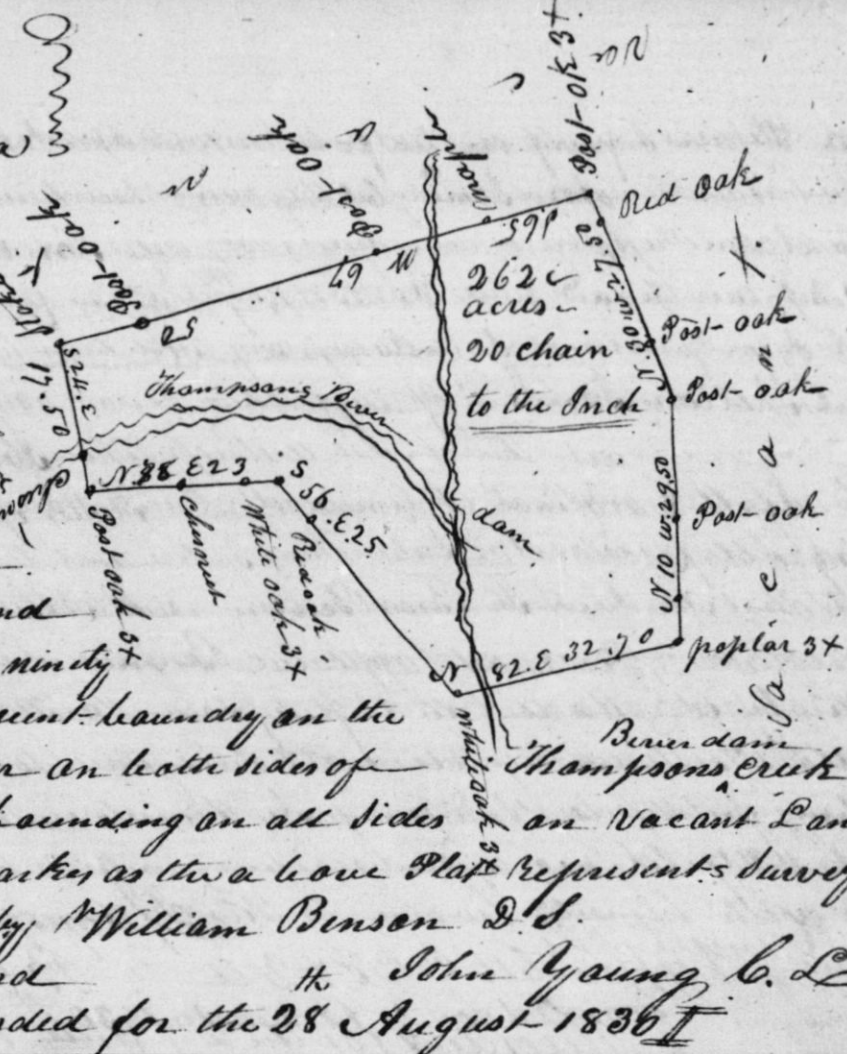

³⁵⁰
The State of South Carolina } To wit I know all men by these
Greenville Districts } presents that I Martha Wynne of the
District and State aforesaid am justly indebted to Roger Louland and
Company in the sum of sixty three dollars and twenty nine cents and also
am indebted to Samuel Brayton in the sum of twenty two dollars and
seventy five cents and in consideration as well of the said due to the said
Roger Louland & Co as the said debt due to the said Samuel Brayton
which the said Roger Louland & Co. have paid for me or bound them
selves to pay have granted, bargained, sold, released and conveyed and
by these presents do grant bargain sell and release and convey unto the
said Roger Louland and Company and their heirs and assigns one
share or Childs part of the tract of Land on which my mother now
lives lying on the western Road adjoining lands belonging to the
Estate of the late Capt William Young on one side and land now
belonging to Dr. Robinson and William B. Johnson which my mother
by the will of my Father is intitled to keep and enjoy during
her life and which after her death is to be equally divided a-
mong the Children To Have and To Hold all such part of the
said Land as I may at the death of my mother be intitled too to
my distributive share of the said tract should it be sold for par-
tition And full power and authority is here by given and
granted to the said Roger Louland & Co. to use my name in
the recovery thereof to sue for the same and in every respect to