

VEL 1218 PAGE 288

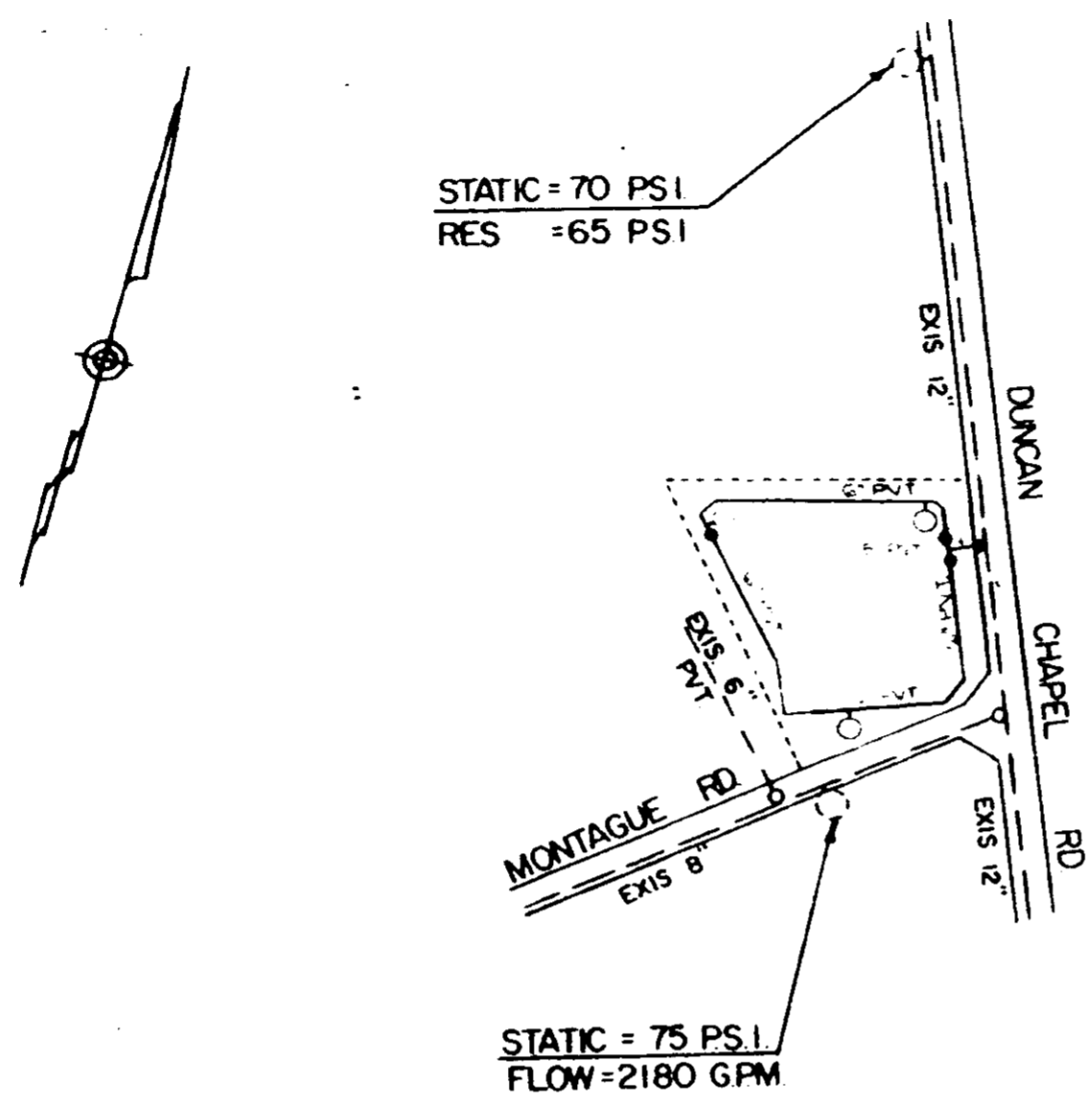

NOTE: 6" & 8" VALS OPEN RIGHT
FIRE HYDRANTS TO BE
3-WAY & OPEN RIGHT

EASEMENT
Court Ridge Associates, A
Georgia General Partnership
to
Commissioners of Public Works
of the City of Greenville, S. C.
July 3, 1984
BB No. 431-2-5

COURT RIDGE CONDOMINIUMS
FEBRUARY, 1984 SCALE: 1" = 400'
REVISED JULY, 1984

RECORDED JUL 31 1984 2 + 1156 + 11. 3308

1525

4325 (V-2)