

216

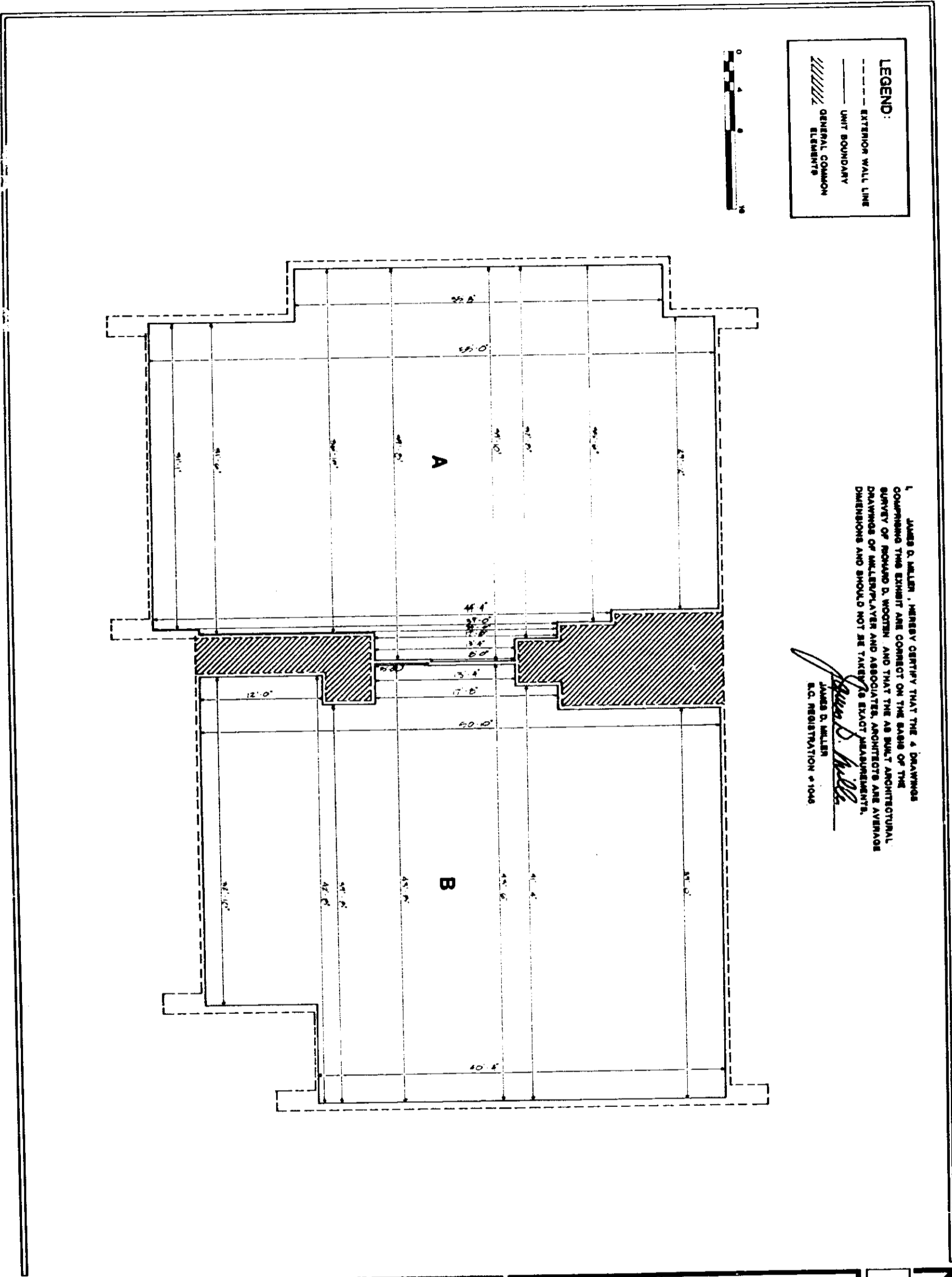

I, JAMES D. MILLER, HEREBY CERTIFY THAT THE 4 DRAWINGS COMPRISING THIS EXHIBIT ARE CORRECT ON THE BASIS OF THE SURVEY OF HOWARD D. WOOTEN AND THAT THE AS BUILT ARCHITECTURAL DRAWINGS OF MILLER/PLAYER AND ASSOCIATES, ARCHITECTS ARE AVERAGE DIMENSIONS AND SHOULD NOT BE TAKEN AS EXACT MEASUREMENTS.

*James D. Miller*  
 JAMES D. MILLER  
 S.C. REGISTRATION # 1046

EXHIBIT B  
 PAGE 4

PELHAM POINTE  
 PROFESSIONAL PARK  
 HORIZONTAL PROPERTY REGIME  
 SECOND FLOOR PLAN

NO.	DATE	REVISIONS

**MILLER/PLAYER & ASSOCIATES**  
 ARCHITECTS AND PLANNERS, LTD.  
 1010 east north street, Greenville, S.C.  
 James D. Miller, A.S.A. / Orville E. Poyer, III / Robert C. Cochran



216

REPRODUCED FROM ORIGINAL