

Name and Post Office Address of Grantor: Mid South Mortgage Company
P. O. Box 6751
Columbia, SC 29260

Toll Line or Exchange Line tributary to: Greenville, South Carolina
(Name) (Exchange)

The Property is bounded where the line enters and leaves this property by the property of:
Dewitt T. Moree on the North
and Towmes Street on the West

Authority: HF3-8078S Classification: R45C

Area: South Carolina

Approved: _____
Title: Segment Manager-Engineering/LAC

Tax Map No. 4-1-11

NORTH

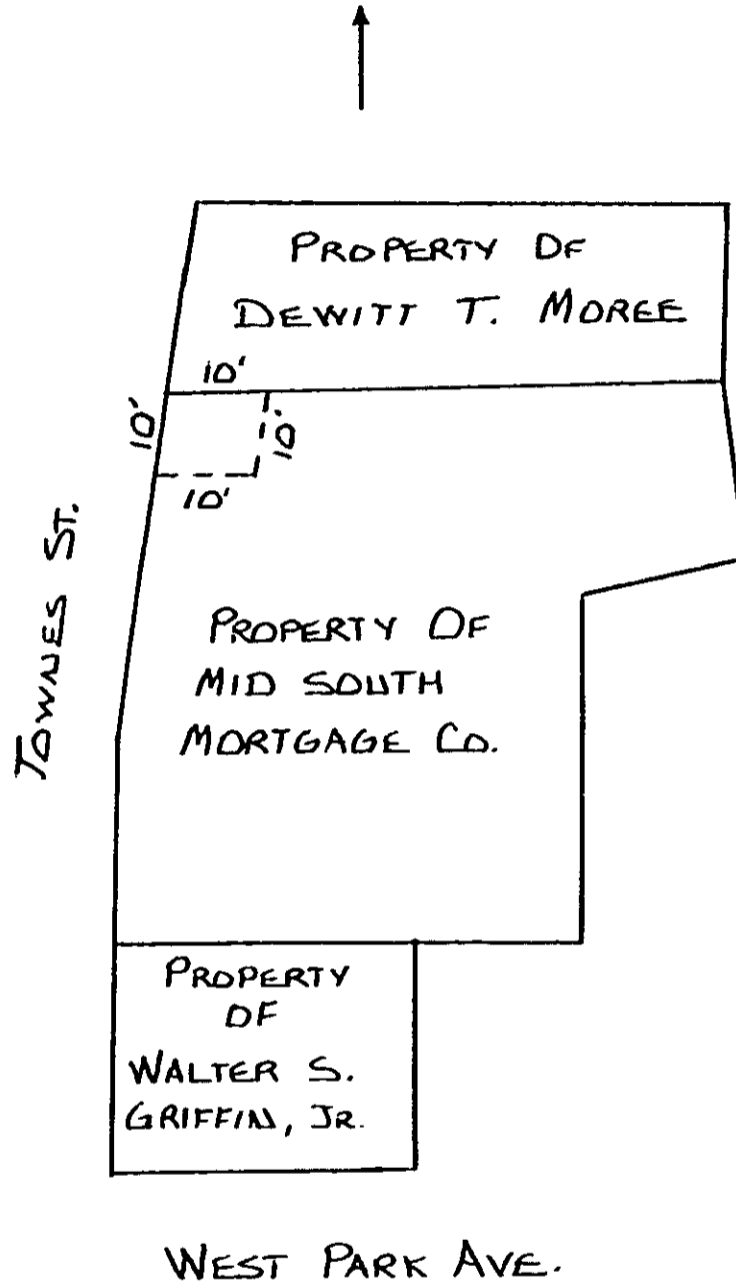

RECORDED JAN 24 1984 at 3:03 P/M

Filed for record in the office of
the R. M. C. for Greenville
County, S. C. at 3:03 P/M
P/M Jan. 24, 1984
and recorded in Deed Book 61
1205 at page

22923

JAN 24 1984

22923

Handwritten signature

22923