

1183

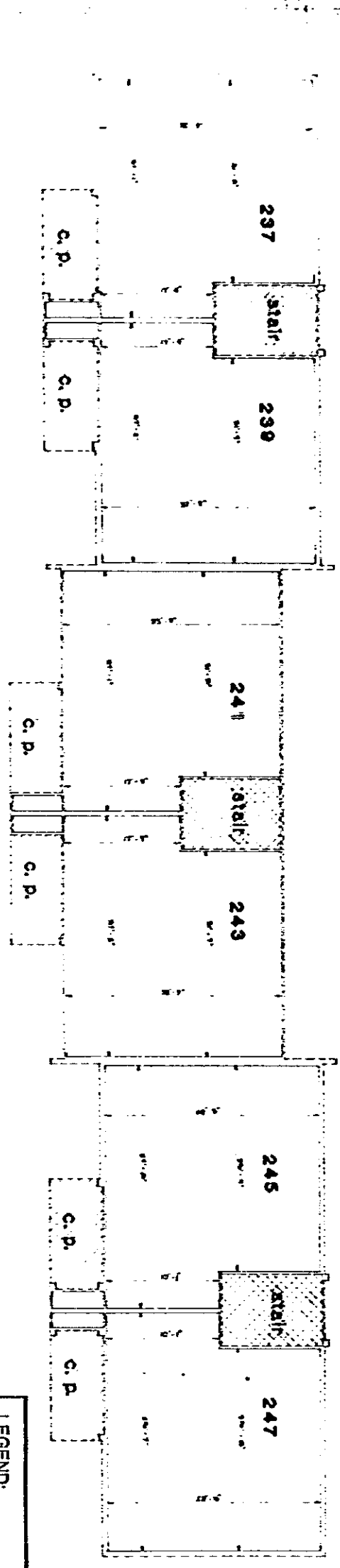

FIRST FLOOR PLAN

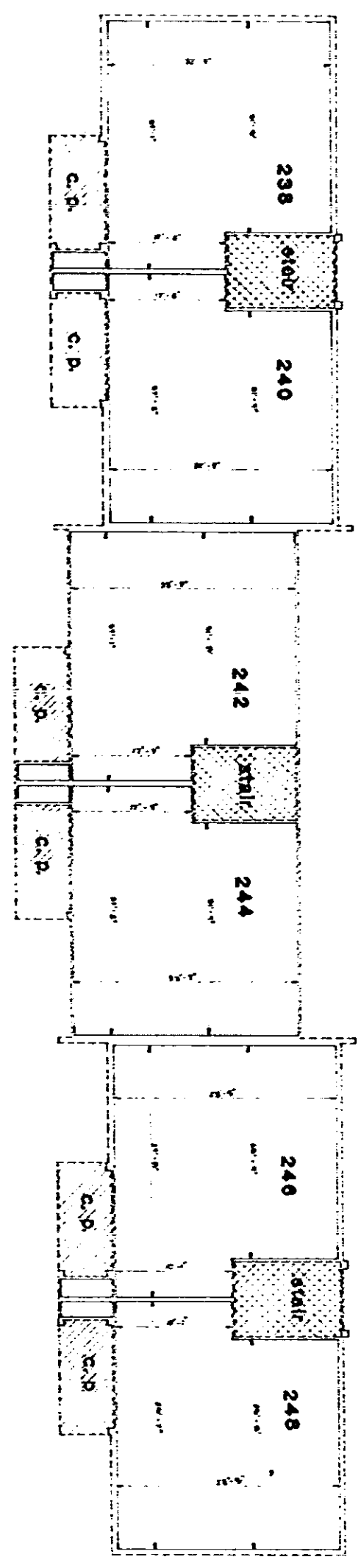

SECOND FLOOR PLAN  
RICHLAND

I, ORVILLE V. PLAYER, II, HEREBY CERTIFY THAT THE FOREGOING COMPRISE THE EXACT AND CORRECT ON THE BASIS OF THE SURVEY OF W.M. WILLIAMS, JR. AND THAT THE AS BUILT ARCHITECTURAL DRAWINGS OF MILLER/PLAYER AND ASSOCIATES, ARCHITECTS ARE AVERAGE DIMENSIONS AND SHOULD NOT BE TAKEN AS EXACT MEASUREMENTS.

ORVILLE V. PLAYER, II  
S.C. REGISTRATION #1180

**LEGEND:**

- EXTERIOR WALL LINE
- - - UNIT BOUNDARY
- /// GENERAL COMMON ELEMENTS
- XXXX LIMITED COMMON ELEMENTS
- C.P. DENOTES CONCRETE PORCH



27	RIVERBEND CONDOMINIUMS PHASE TWO HORIZONTAL PROPERTY REGIME EXHIBIT B		<b>MILLER/PLAYER &amp; ASSOCIATES</b> ARCHITECTS AND PLANNERS, LTD. 1010 east north street • greenville, s.c. <small>James B. Miller, A.L.A. / Orville V. Player, II / Robert C. Cobble</small>
----	--	--	--

27