

FOUNDATION PLAN
CALHOUN

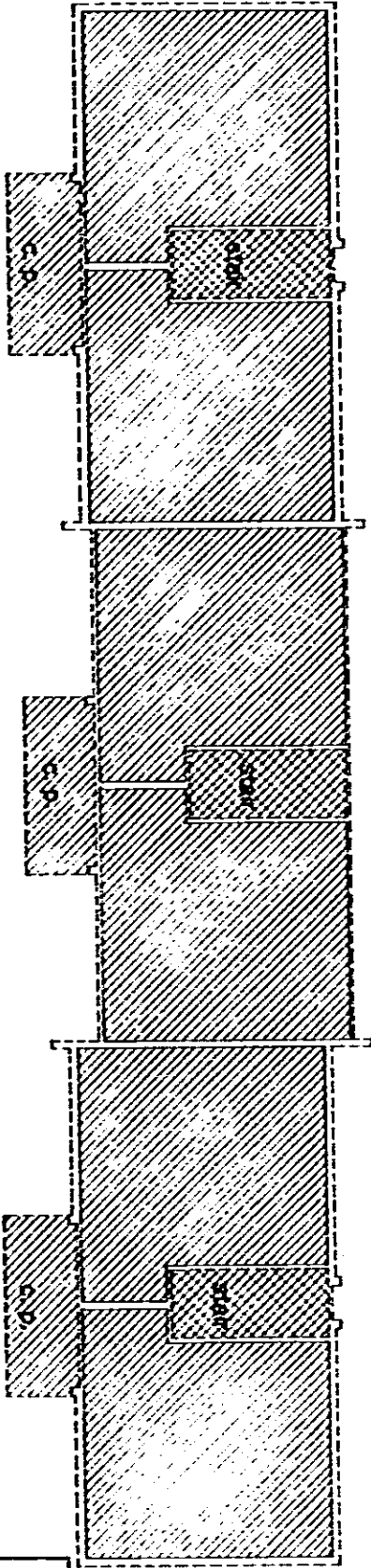

LEGEND:

- EXTERIOR WALL LINE
- - - UNIT BOUNDARY
- /// GENERAL COMMON ELEMENTS
- XXXX LIMITED COMMON ELEMENTS
- C. P. DEMOTES CONCRETE PORCH

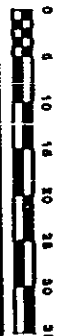

I, ORVILLE V. PLAYER, II, HEREBY CERTIFY THAT THE DRAWINGS COMPREHENDING THIS EXHIBIT ARE CORRECT ON THE BASIS OF THE SURVEY OF W.A. WILLIAMS, JR. AND THAT THE AS BUILT ARCHITECTURAL DRAWINGS OF MILLER/PLAYER AND ASSOCIATES, ARCHITECTS ARE IN ACCORDANCE WITH THE ORIGINAL ARCHITECTS' AND ENGINEERS' DRAWINGS AND SHOULD NOT BE TAKEN AS EXACT MEASUREMENTS.

ORVILLE V. PLAYER, II
S.C. REGISTRATION #11898

8

RIVERBEND CONDOMINIUMS
PHASE TWO
HORIZONTAL PROPERTY REGIME
EXHIBIT B

DATE	11/11/88
BY	ORVILLE V. PLAYER, II
CHECKED BY	ORVILLE V. PLAYER, II
SCALE	AS SHOWN



MILLER/PLAYER & ASSOCIATES
ARCHITECTS AND PLANNERS, LTD.
1010 East North Street, Greenville, S.C.

James D. Miller, A.L.A. / Orville V. Player, II / Robert C. Cochran



1189 499

1189 499