

0 4 9 2

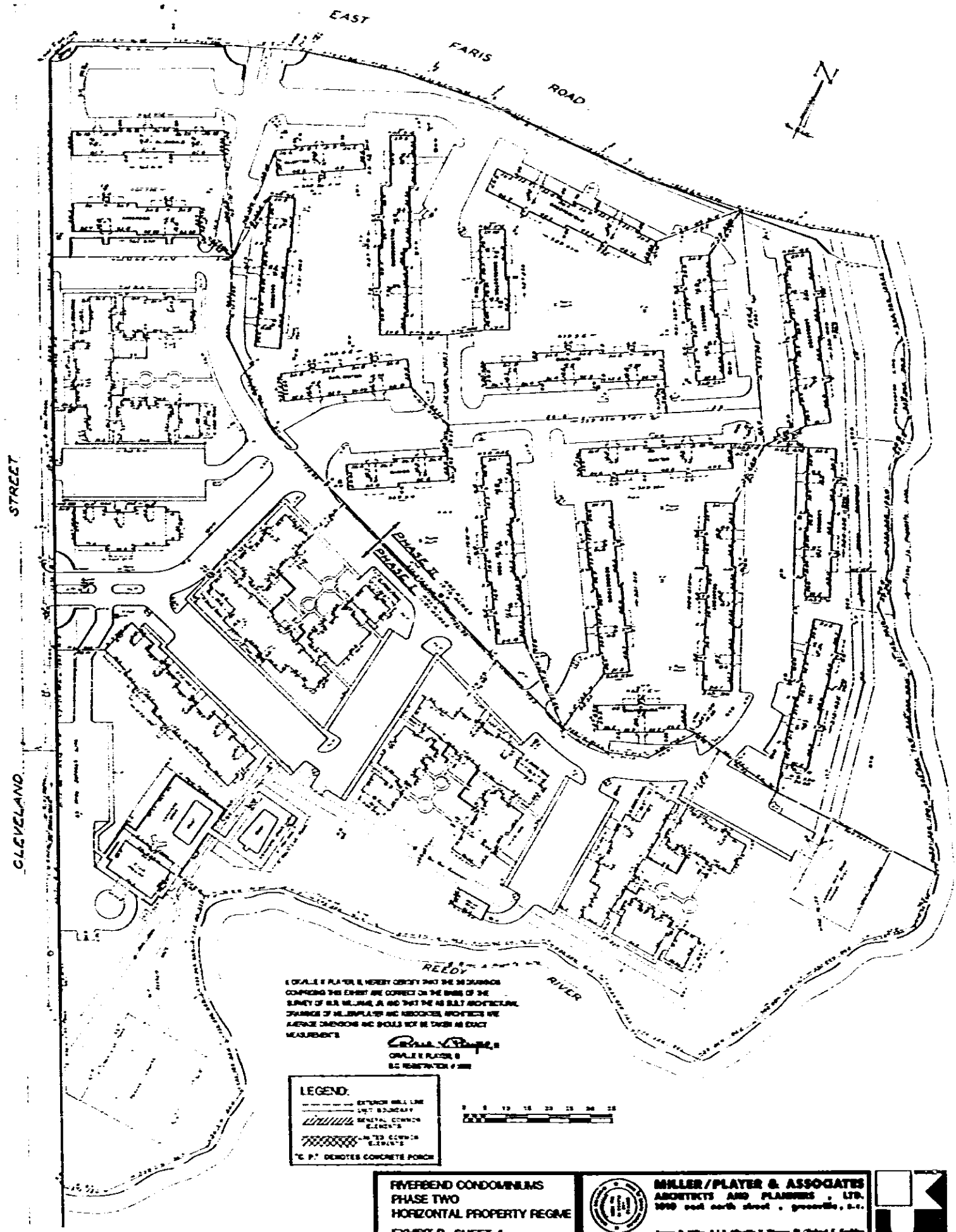

I, ORVILLE H. PLAYER, HEREBY CERTIFY THAT THE MEASUREMENTS  
 COMPRISING THIS EXHIBIT ARE CORRECT ON THE BASIS OF THE  
 SURVEY OF R.H. MILLER, JR. AND THAT THE ARCHITECTURAL  
 DRAWINGS OF MILLER/PLAYER & ASSOCIATES ARCHITECTS AND PLANNERS ARE  
 ACCURATE DIMENSIONS AND SHOULD NOT BE TAKEN AS EXACT  
 MEASUREMENTS.

ORVILLE H. PLAYER, II  
 O.H. REGISTERED # 288

**LEGEND:**  
 - - - - - EXTERIOR WALL LINE  
 - - - - - UNIT BOUNDARY  
 // // // // // GENERAL COMMON ELEMENTS  
 // // // // // UNIT COMMON ELEMENTS  
 "C.P." DENOTES CONCRETE PORCH



**RIVERBEND CONDOMINIUMS  
 PHASE TWO  
 HORIZONTAL PROPERTY REGIME  
 EXHIBIT B SHEET 1**

**MILLER/PLAYER & ASSOCIATES**  
 ARCHITECTS AND PLANNERS - LTD.  
 1000 east north street - greenville, S.C.  
 James B. Miller, S.A.A. / Orville H. Player, II / Robert C. Giddens

4328-112