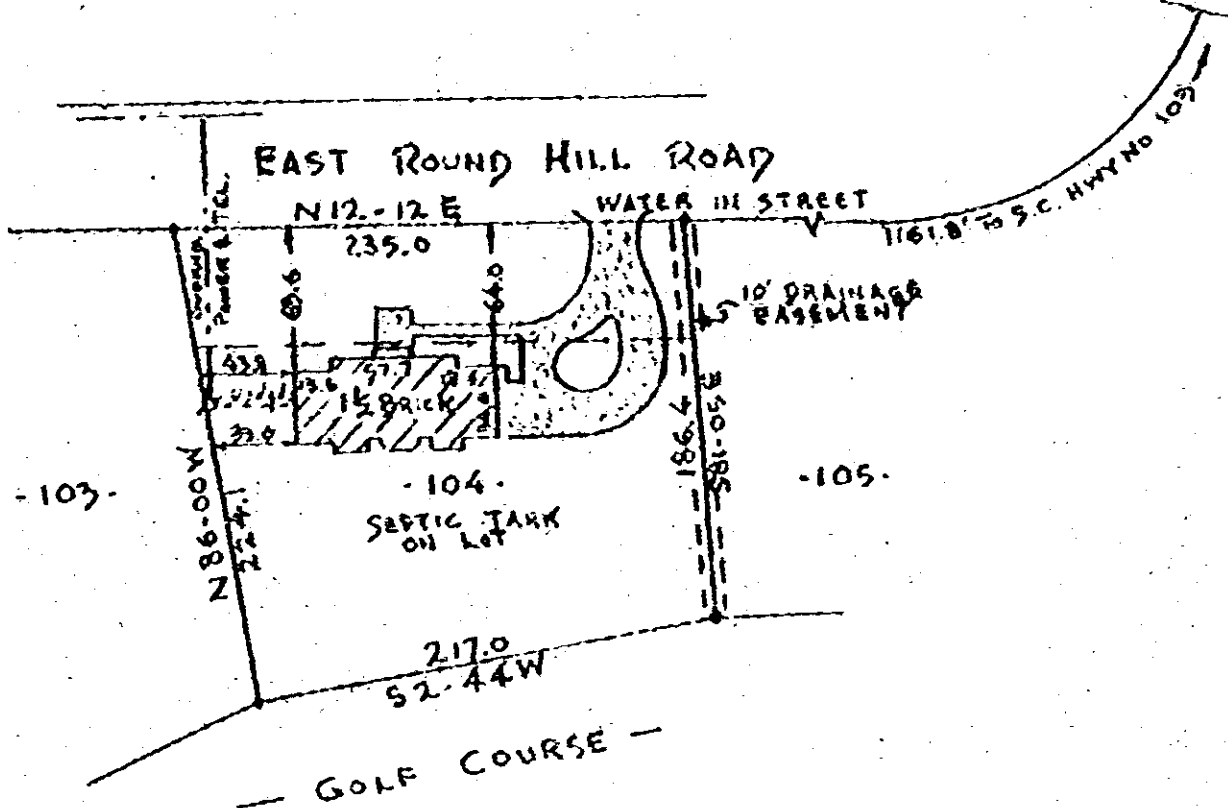
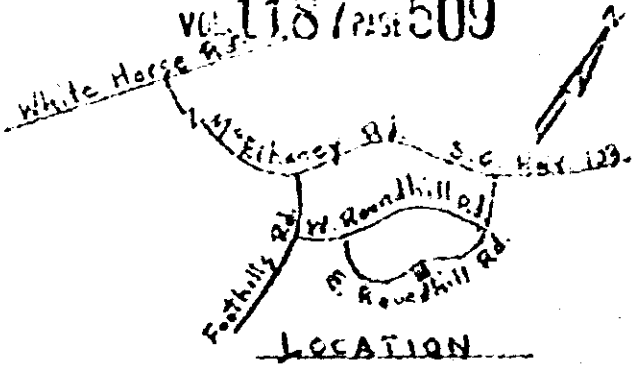
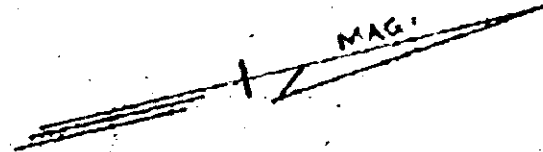

Exhibit "A"

REF. PLAT OF GREENVALLEY ESTATES
FILED IN PLAT BK. QQ PAGE 213

Vol. 1187 Page 509



PROPERTY OF
JAY D. HAAS & JANICE P. HAAS

GREENVILLE COUNTY, S.C.
SCALE 1"=100' APRIL 18, 1983

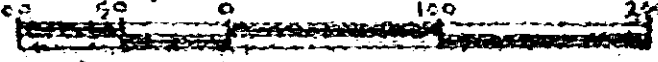

NOTES

ACCORDING TO DEPT. OF H.U.D.
FLOOD HAZARD BOUNDARY MAP H-01-65
SHT. 30 COMMUNITY No. 450089 FOR
GREENVILLE CO., S.C.
THIS PROPERTY IS NOT IN A FLOOD
HAZARD ZONE.

I HEREBY CERTIFY THAT THE MEASUREMENTS
AS SHOWN ARE CORRECT AND THERE ARE
NO ENCROACHMENTS OR PROJECTIONS OTHER
THAN SHOWN.

James D. Cain

P.L.S. No 3320

28808

PIEDMONT ENGINEERS - ARCHITECTS - PLANNERS
GREENVILLE, S.C.

Recorded May 2nd, 1983 at 4:33 P/M

0509

4328 W. 21