

V. M. C. for Greenville
Mar. 23, 1983
XX
21029

filed for record in the office of
the R. M. C. for Greenville
county, S. C. at 1:40 o'clock
A. M. Mar. 23, 19 83
and recorded in Deed Book
1184 at page 886
R. M. C. for G. Co. S. C.

Line or Exchange Line tributary to Blue Ridge (Exchange)
The Property is bounded where the line enters and leaves this property by the property of:
_____ on the _____
and _____ on the _____
Authority P-43429 Classification R45C
Area South Carolina
Approved _____
Title _____

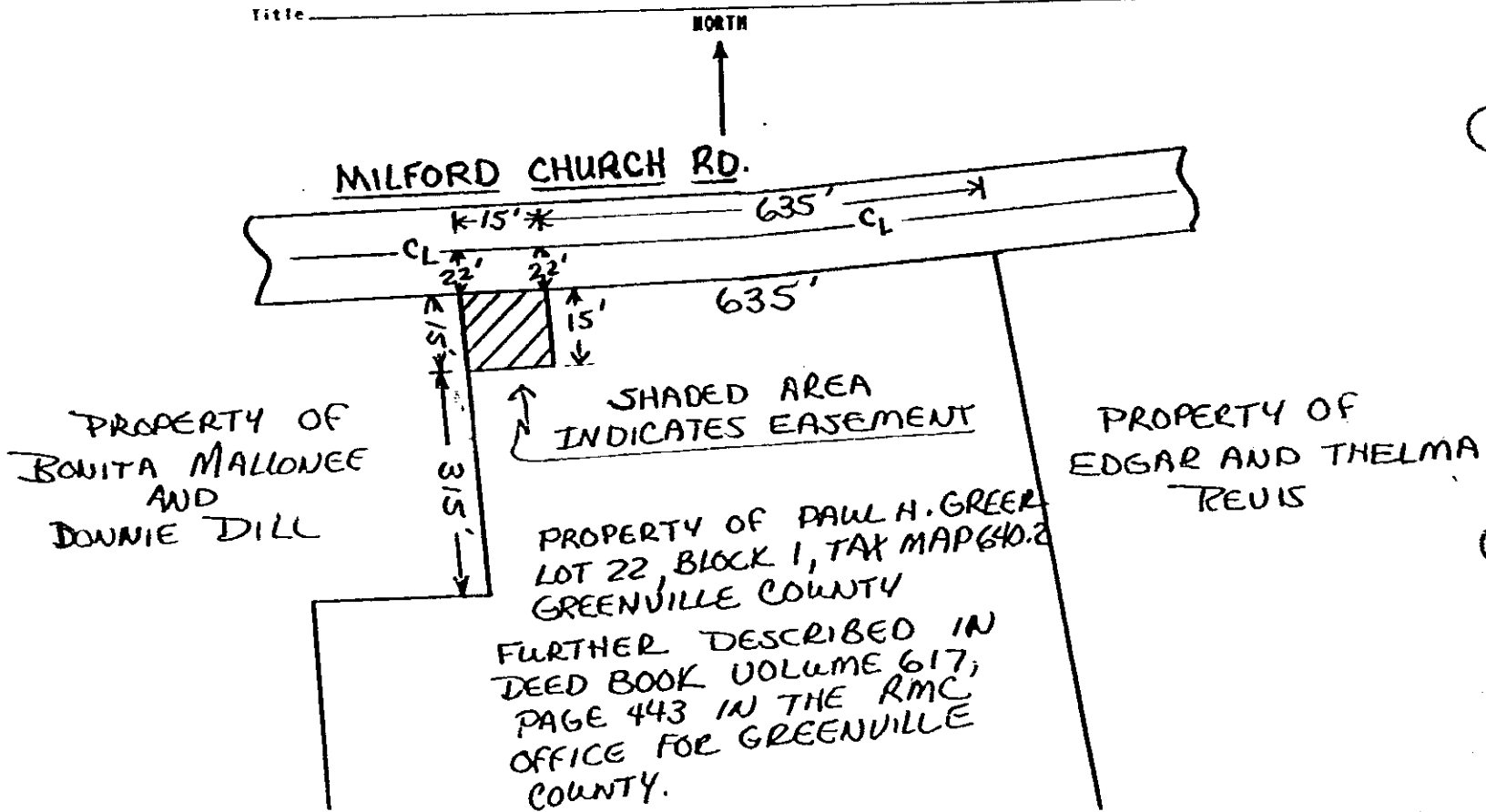

ADDITIONAL TERMS

1. All opened trenches and pits will be restored to prevent erosion.
2. Suitable fence will be placed on pasture sides of easement to contain cattle.

