

South Carolina

Greenville County

Personally appeared before me
Margaret Watson who being duly sworn
says that she saw the above
Named Buffy Siller, sign,
seal and deliver the above written
Contract; and that he with
H.L. Stratter witnessed the
execution thereof.

Sworn to before me this 25th
day of October, A.D., 1982

Larry Frayer
Notary Public for S. C.
My Commission Expires
3-31-92

Margaret R. Watson
Witness

Property located approx 4 miles East of
Williamston S.C. on Big Creek Rd in Greenville
County The property fronts Big Creek Rd 361ft
Runs South 227ft and measures 320ft
across back east to west and back up
from South to North 353ft

9937 x
1775
Notary Public
Greenville County S.C.

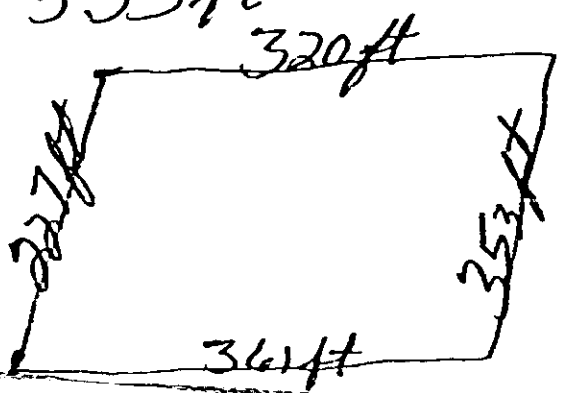

RECORDED OCT 25 1982 at 2:05 P.M.

9937

4328 (IV-2)