

5 1 6

SECOND FLOOR PLAN
FAIRFIELD HOUSE

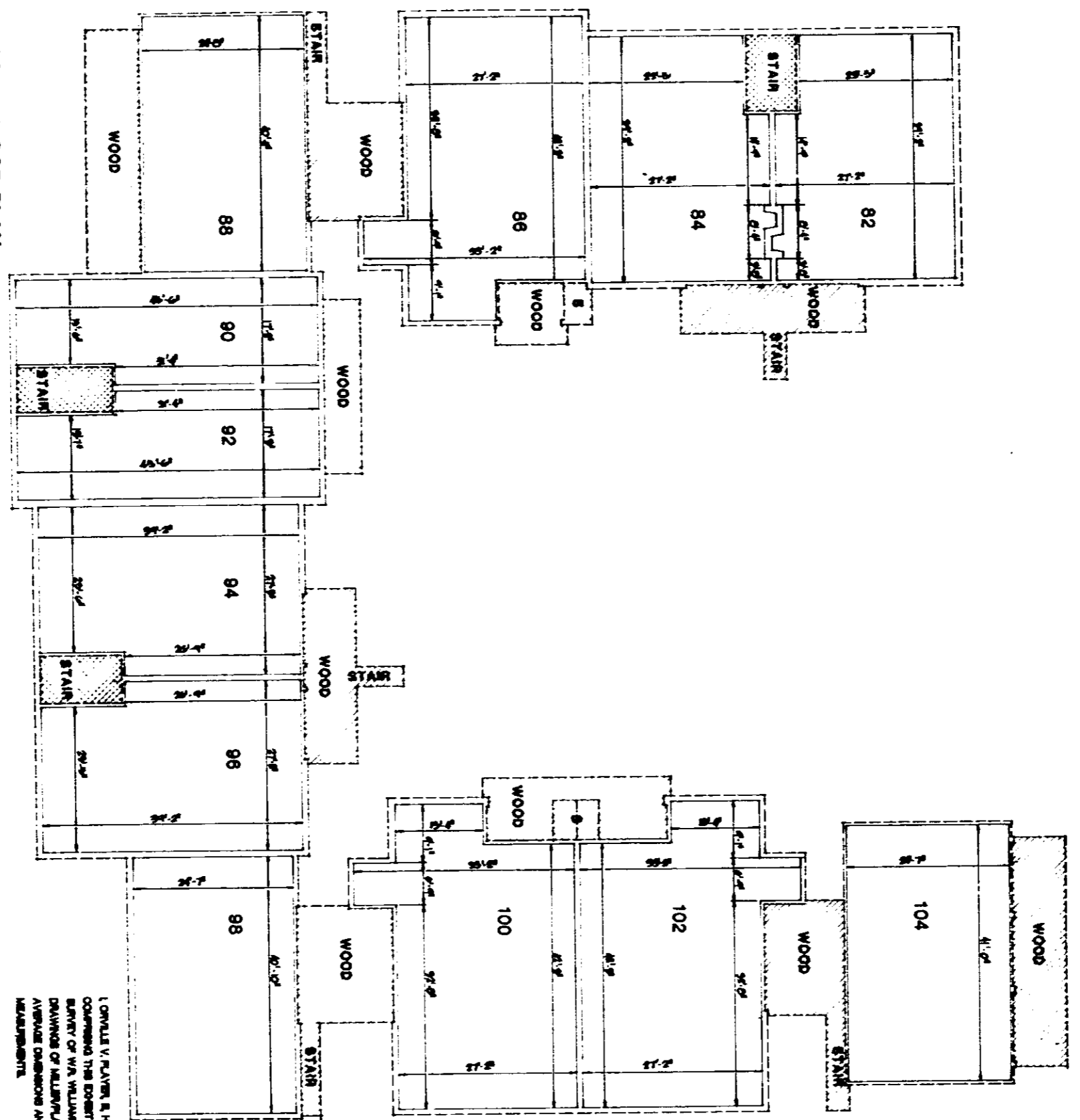

I ORVILLE V. PLAYER, S. HENRY CENTER, THAT THE 18 DRAWINGS CONTAINED HEREIN ARE CORRECT ON THE BASIS OF THE SURVEY OF W.A. WELLS, JR. AND THAT THE ARCHITECTURAL DRAWINGS OF MILLER/PLAYER AND ASSOCIATES, ARCHITECTS ARE AVERAGE DIMENSIONS AND SHOULD NOT BE TAKEN AS EXACT MEASUREMENTS.

ORVILLE V. PLAYER, S.
S.C. REGISTRATION # 1580

LEGEND:

- EXTENSION WALL LINE
- - - UNIT BOUNDARY
- ==== GENERAL COMMON ELEMENTS
- XXXXX LIMITED COMMON ELEMENTS
- PORCH DENOTES COVERED AREA
- * * * DENOTES STORAGE AREA
- CONC. DENOTES CONCRETE SLAB-ON-GRADE CONSTRUCTION
- WOOD DENOTES ABOVE-GRADE WOODEN CONSTRUCTION

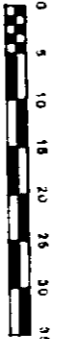

13

RIVERBEND CONDOMINIUMS
HORIZONTAL PROPERTY REGIME
EXHIBIT B

| | |
|---------|----------|
| DATE | 11/11/80 |
| BY | J.B.M. |
| CHECKED | |
| DATE | |
| BY | |

MILLER/PLAYER & ASSOCIATES
ARCHITECTS AND PLANNERS, LTD.
1010 east north street, Greenville, S.C.

James B. Miller, A.L.A. / Orville V. Player, III / Robert C. Cobble



4328 RV 2