

CLEVELAND

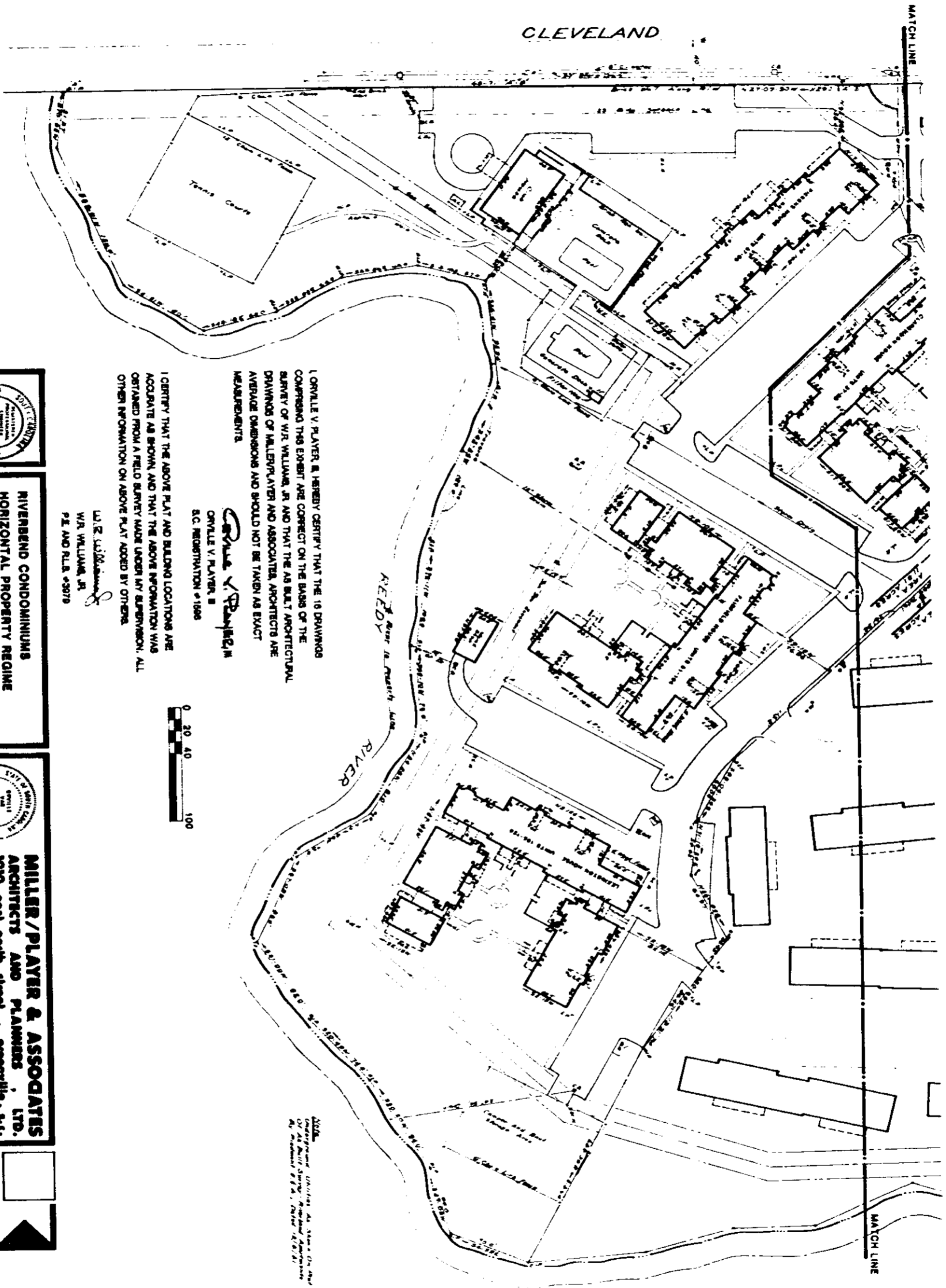

I ORVILLE V. PLAYER, HEREBY CERTIFY THAT THE DRAWINGS COMPRISED THIS EXHIBIT ARE CORRECT ON THE BASIS OF THE SURVEY OF W.R. WILLIAMS, JR. AND THAT THE ARCHITECTURAL DRAWINGS OF MILLER/PLAYER AND ASSOCIATES ARCHITECTS ARE AVERAGE DIMENSIONS AND SHOULD NOT BE TAKEN AS EXACT MEASUREMENTS.

Orville V. Player, Jr.
 ORVILLE V. PLAYER, JR.
 R.C. REGISTRATION # 1998

I CERTIFY THAT THE ABOVE PLAN AND BUILDING LOCATIONS ARE ACCURATE AS SHOWN AND THAT THE ABOVE INFORMATION WAS OBTAINED FROM A FIELD SURVEY MADE UNDER MY SUPERVISION. ALL OTHER INFORMATION ON ABOVE PLAN ADDED BY OTHERS.

W.R. Williams, Jr.
 W.R. WILLIAMS, JR.
 P.E. AND P.L.S. #3878



NOTE:
 INFORMATION CONTAINED ON THESE DRAWINGS IS THE PROPERTY OF MILLER/PLAYER & ASSOCIATES ARCHITECTS AND PLANNERS, LTD. AND IS NOT TO BE REPRODUCED OR TRANSMITTED IN ANY FORM OR BY ANY MEANS, ELECTRONIC OR MECHANICAL, INCLUDING PHOTOCOPYING, RECORDING, OR BY ANY INFORMATION STORAGE AND RETRIEVAL SYSTEM.



RIVERBEND CONDOMINIUMS
 HORIZONTAL PROPERTY REGIME
 EXHIBIT B SHEET 1A



MILLER/PLAYER & ASSOCIATES
 ARCHITECTS AND PLANNERS, LTD.
 1010 east north street, Greenville, S.C.



0132

4328 RV.21