

Name and Post Office Address of Grantor Jackson E. Greene  
Route 3  
Greendale Farms  
Greenville, SC 29609

Toll Line or Exchange Line tributary to Travelers Rest Exchange and Office

The Property is bounded where the line enters and leaves this property by the property of:  
Ledbetter Road on the North  
and Keeler Bridge Road on the West

Authority P-43522 Classification R45C  
Area Greenville District

Approved \_\_\_\_\_  
Title District Manager - Distribution

*36-17*  
*AUG 12 1982*

KEELER BRIDGE ROAD

S-23-102

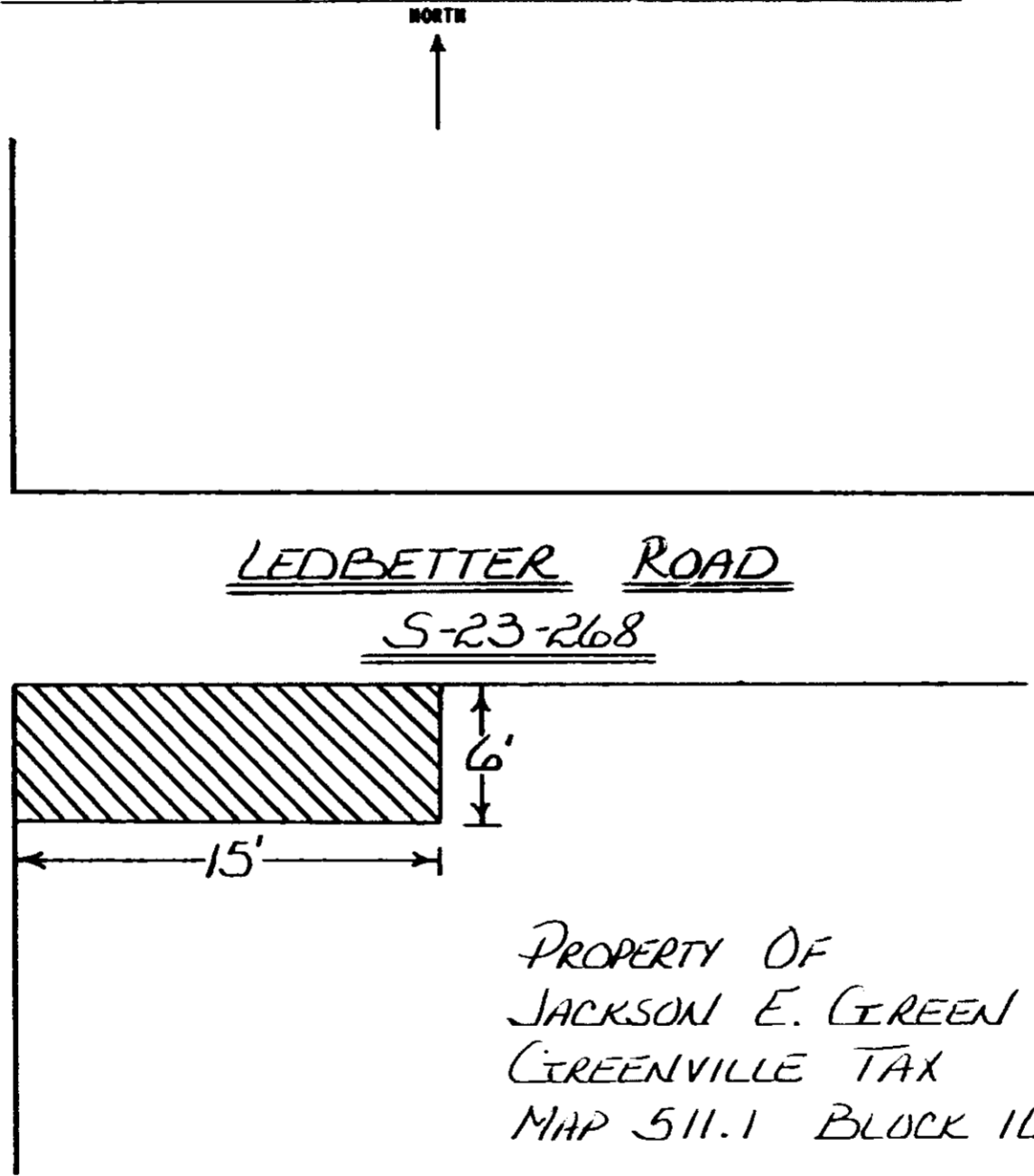

RECORDED 'AUG 12 1982 at 2:49 P.M.

36-17

Filed for record in the office of  
the R. M. C. for Greenville  
county, S. C. at 2:49 o'clock  
P.M. Aug. 12, 1982  
and recorded in Deed Book  
1172 at page 113

R. M. C. for G. Co. S. C.

4328 RV.2