

Vol 1171 04

Name and Post Office Address of Grantor Westminster Company
850 South Pleasantburg Drive
Greenville, South Carolina

Toll Line or Exchange Line tributary to Dial and Toll (Name)
 (Exchange)

The Property is bounded where the line enters and leaves this property by the property of:
Greenville Country Club on the North
 and South Pleasantburg Drive on the East

Authority HF2-8118A Classification 45C
 Area South Carolina

Approved _____
 Title District Manager - Distribution

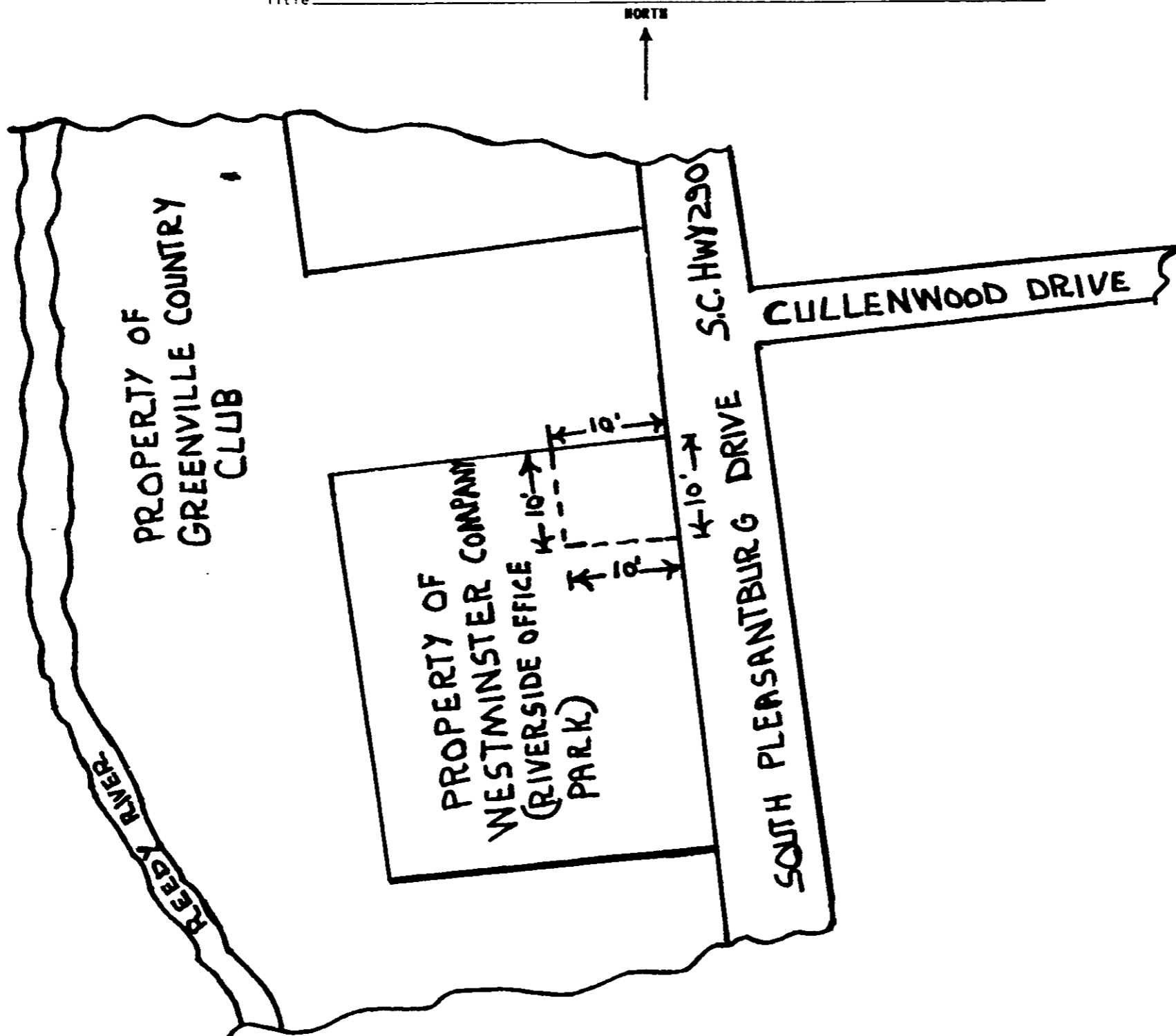

RECORDED AUG 2 1982

at 2:58 P.M.

2694

4328 RV-2