

STA = 75 P.S.I.  
FLOW = 1350 G.P.M.

VOL 1167 PAGE 472

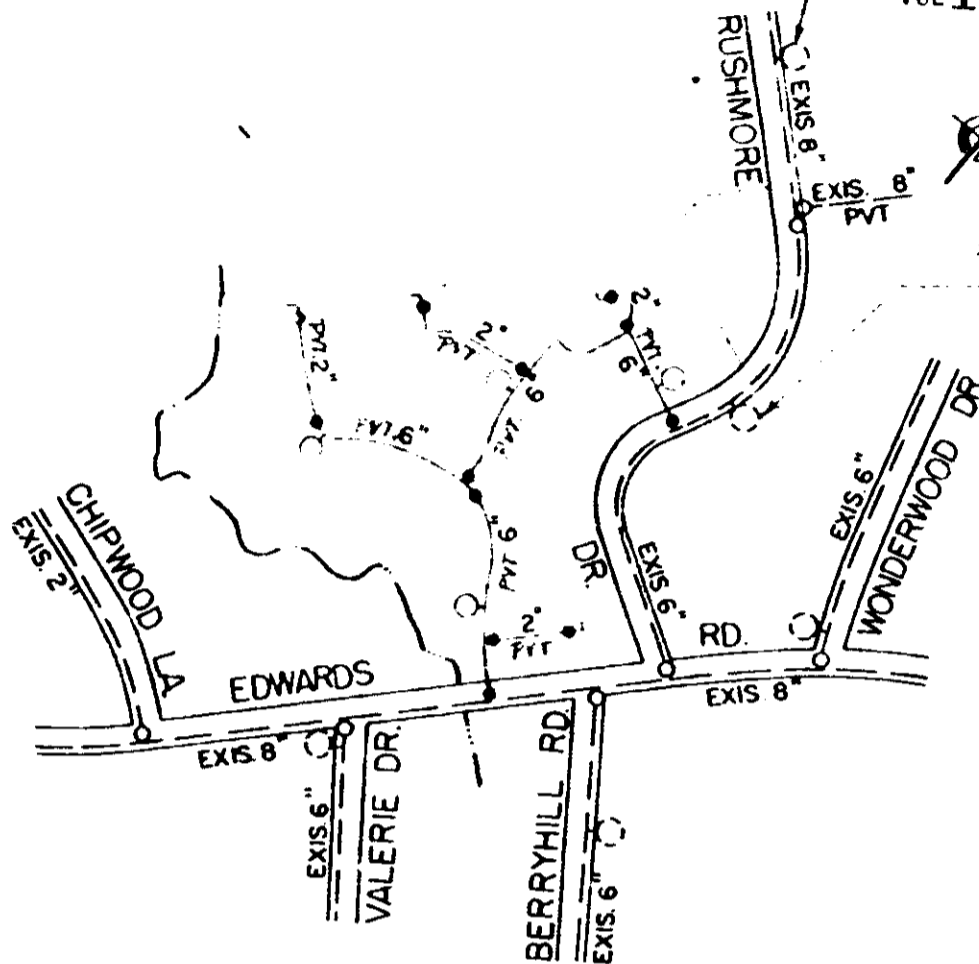

STA. = 75 P.S.I.  
RES. = 67 P.S.I.

NOTE: 6" VALVES OPEN RIGHT, 2" VALVES OPEN LEFT, FIRE HYDRANTS TO BE 3-WAY & OPEN RIGHT.

EASEMENT  
Liberty Life Insurance Co.  
to  
Commissioners of Public Works  
of the City of Greenville, S. C.  
January 12, 1982  
BLK. BOOK P14-2-1.6

**GLENBROOKE TOWNHOMES**  
OCT. 1981 SCALE 1" = 400'

RECORDED **MAY 25 1982** at 2:54 P.M.

26268

0472

4328 112