

Name and File No. _____
 Post Office Address _____
 of Grantor William J. Black & Sherry Vaughn
122 New Dunham Bridge Road
Greenville, S.C. 29611
 Toll _____ (Name) _____
 Line _____
 or _____
 Exchange Line Greenville, S.C. (Exchange) _____
 tributary to _____
 The Property is bounded where the line enters and leaves this property by the property of:
New Dunham Bridge Road on the Northwest
 and Albert Loveland on the Northeast
 Authority C7473 Classification R45C
 Area South Carolina
 Approved _____
 Title District Manager-Distribution

Tax Book #242.2
 Block 2
 Lot 3

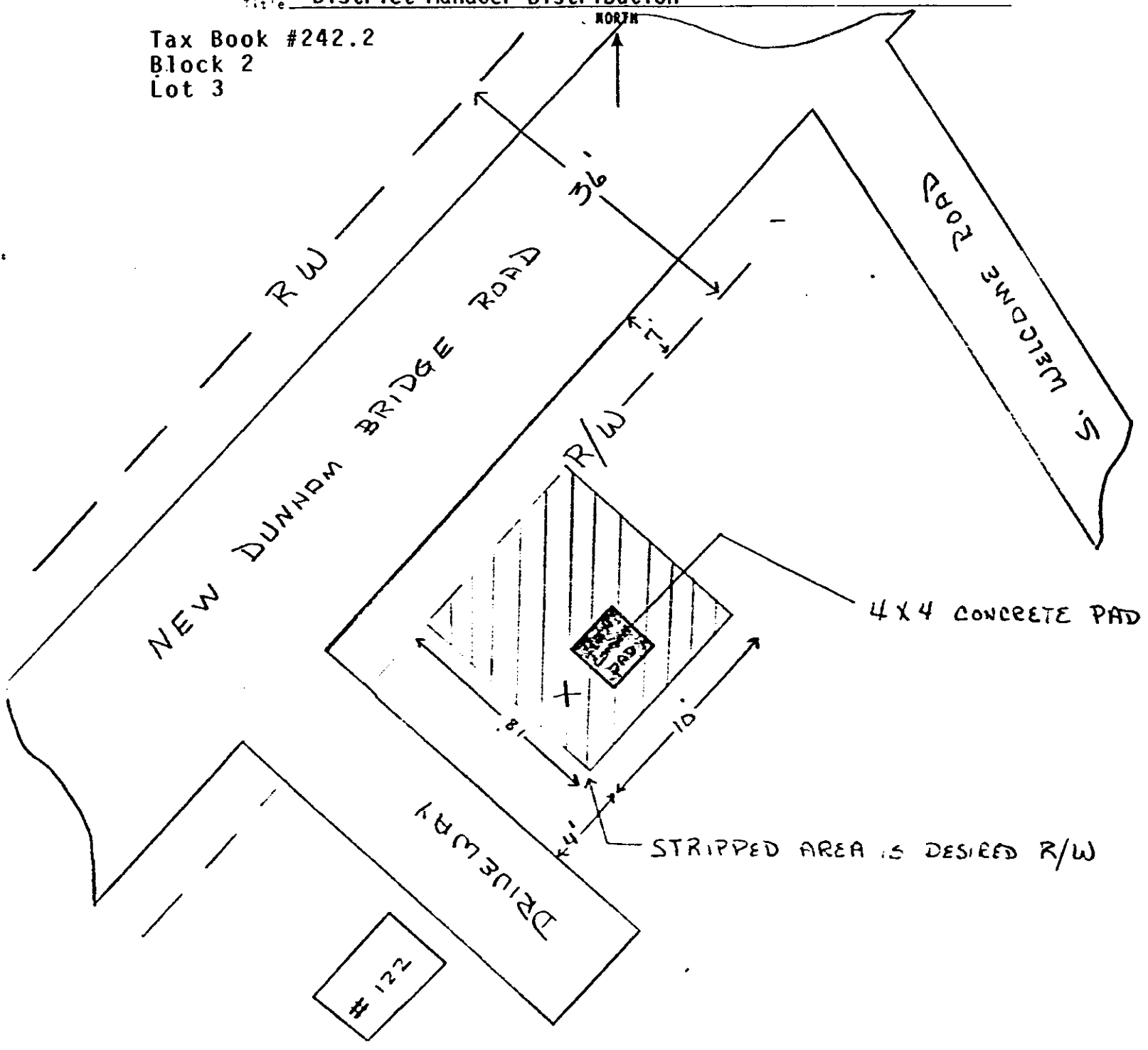

RECORDED MAR 5 1982 at 10:52 A.M. 19826

Filed for record in the office of
 The R. M. C. for Greenville
 County, S. C. at 10:52 o'clock
 A. M. Mar. 5, 19 82
 and recorded in Deed Book
 1163 at page 494
 R. M. C. for G. Co. S. C.

MAR 5 1982
 X
 19826

2428 RV.2
 4328 RV.2