

FOUNDATION - BLDG # 14.10
BACK VENER 14.10

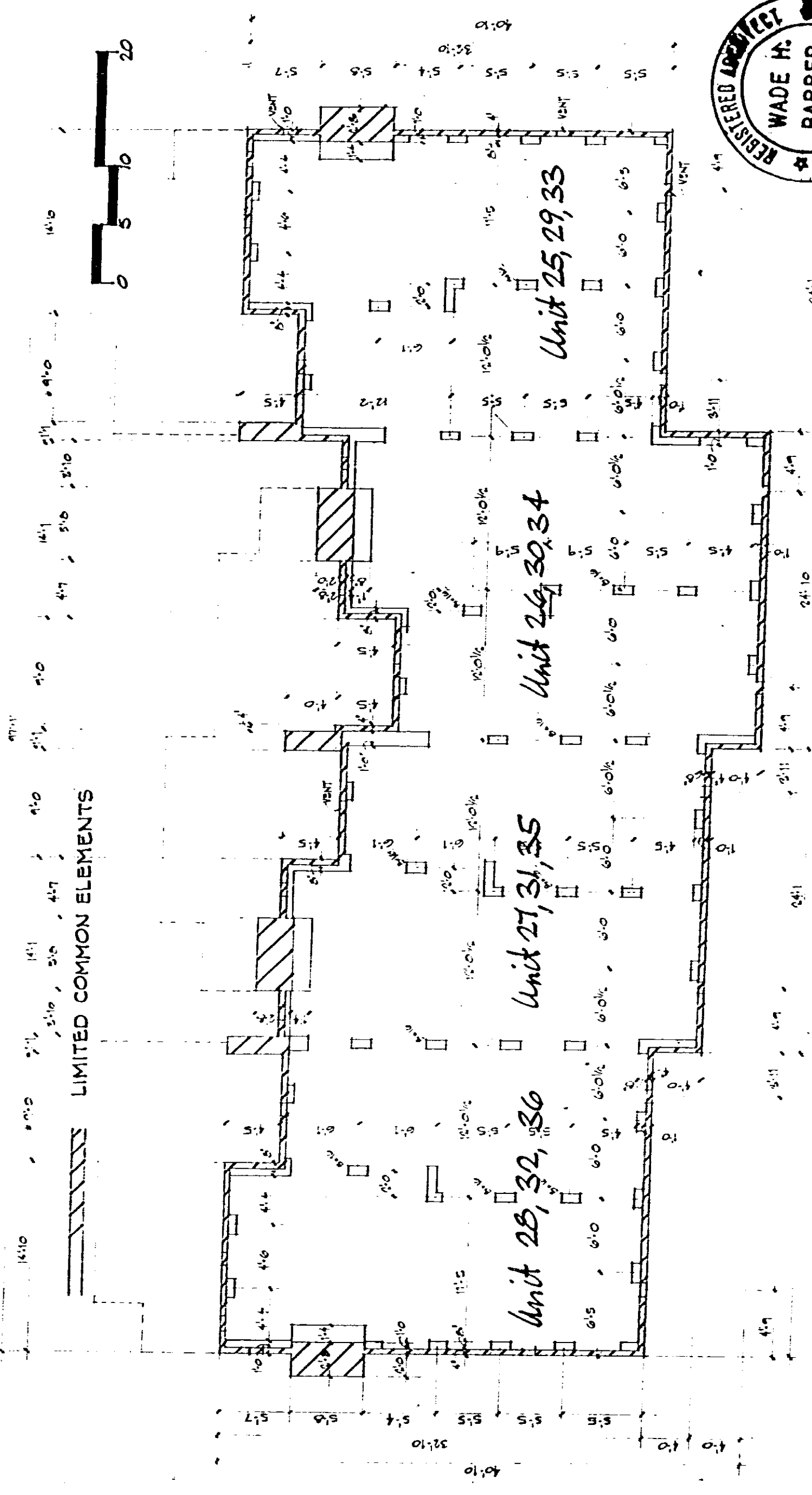

LIMITED COMMON ELEMENTS

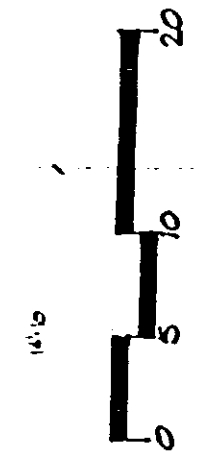

REVISION NOTE: 3/15/81
BUILDING IN CHURN & GITE PLAN TO
HAVE SIDING THEREON. OVERALL
DIMENSIONS SHOWN ON THIS GITE
FOR BLDG #1 TO BE SUBJECT MATTER
LAYOUT SIMILAR TO BLDG #1, 2, 3, 4, 5.

NOTE:
1. BACK VENER BLDG, SEE GITE 167
2. FLOOR ELEVATIONS TO BE ESTABLISHED IN
FIELD BY OWNER
3. SOIL CAPACITY ASSUMED TO BE 2500 PSF
4. VERIFICATION AS READ BY OWNER
5. FOOTINGS TO BE 24" DIA. CONCRETE AT BASE
6. REINFORCEMENT SHALL BE 4# @ 12" ON CENTER
7. MINIMUM 12" DIA. PILES TO BE DRIVEN TO
INSTALL 25' DIA. PILES TO BE DRIVEN TO
INSTALL 25' DIA. PILES TO BE DRIVEN TO

CERTIFICATE

I, Wade H. Barber, do hereby certify that these plans fully depict within reasonable construction tolerances the layout, location, letter identification and dimensions of the buildings and dwellings contained therein.

Wade H. Barber

