

# VILLAGE COURT

WATER & SEWER IN ST R/L 50'

VILLAGE DRIVE

Note:  
Improvements on this lot  
are not in a flood  
hazard area.

LEGEND:  
BOUNDARY OF UNIT [Solid Line]  
LIMITED COMMON ELEMENTS [Hatched Area]

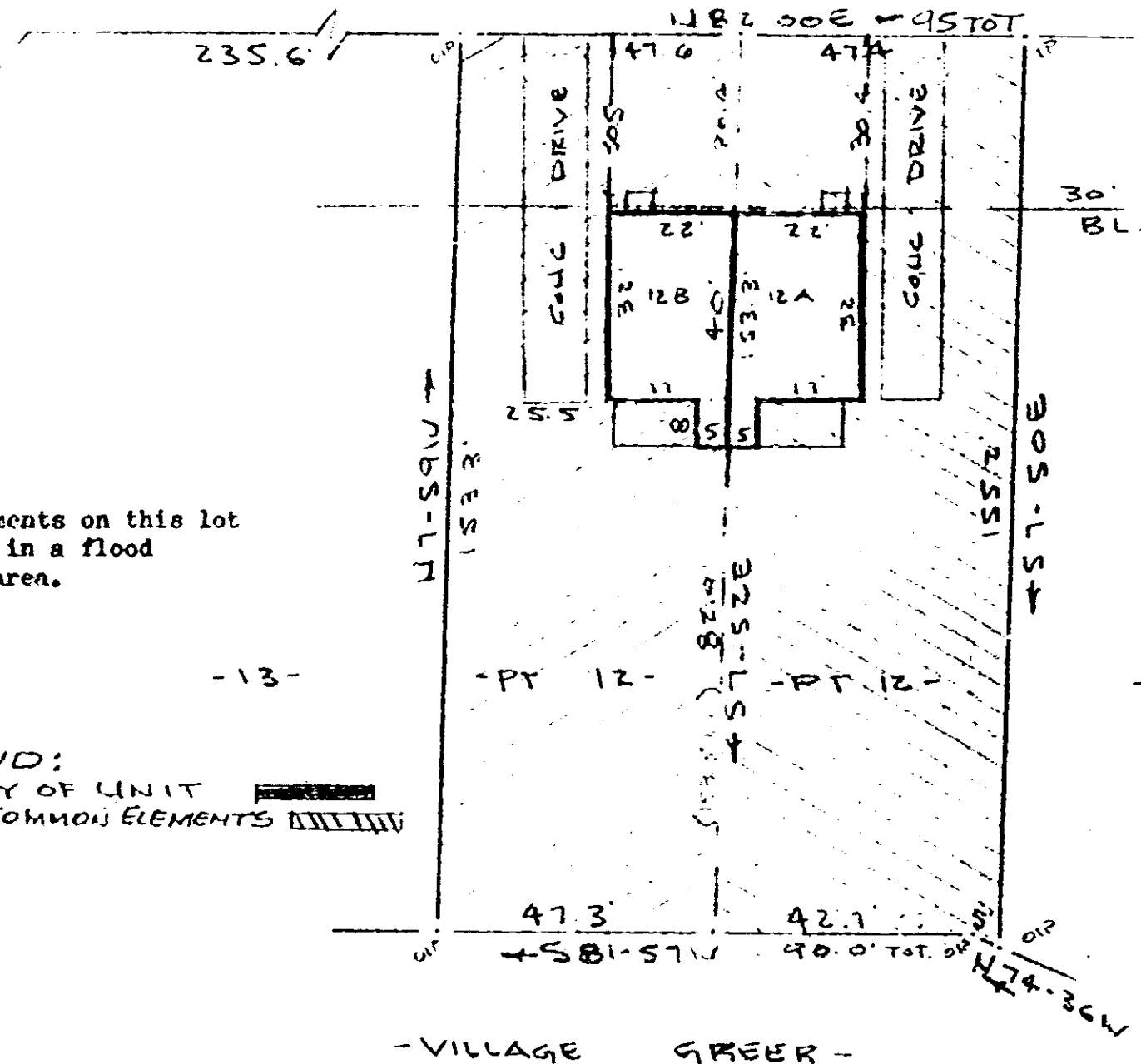

PROPERTY OF  
**HORIZONTAL PROPERTY REGIMED THE VILLAGE TOWNHOUSES No. 12**  
 GREER, GREENVILLE COUNTY, S.C.  
 SCALE: 1" = 30'      5 JUN 81 1981

This is to certify that on the 5th day of June, 1981, I surveyed the property shown on this plat, being known as part of lot 12 VILLAGE GREER and recorded in the RMC Office Greenville County, S. C., in Plat Book " 7 - X " at Page 39 ; and that the property lines, walls and buildings are as shown hereon, and that the walls and buildings located on said lot do not encroach or project on adjacent street or property, and that no adjacent walls or buildings encroach or project on said premises, and no power lines cross this property except as shown hereon.

*R. B. Bruce*  
 R. B. Bruce, RLS #1952

CAROLINA SURVEYING CO.  
 112 Hanly St.  
 Greenville, S. C.

0691

4328 RV-2

231/55

918-S-