

DOROTHY ROSS GRAHAM, ETAL.  
D B 130, PG 334  
(T.O. NO. 7689-2)

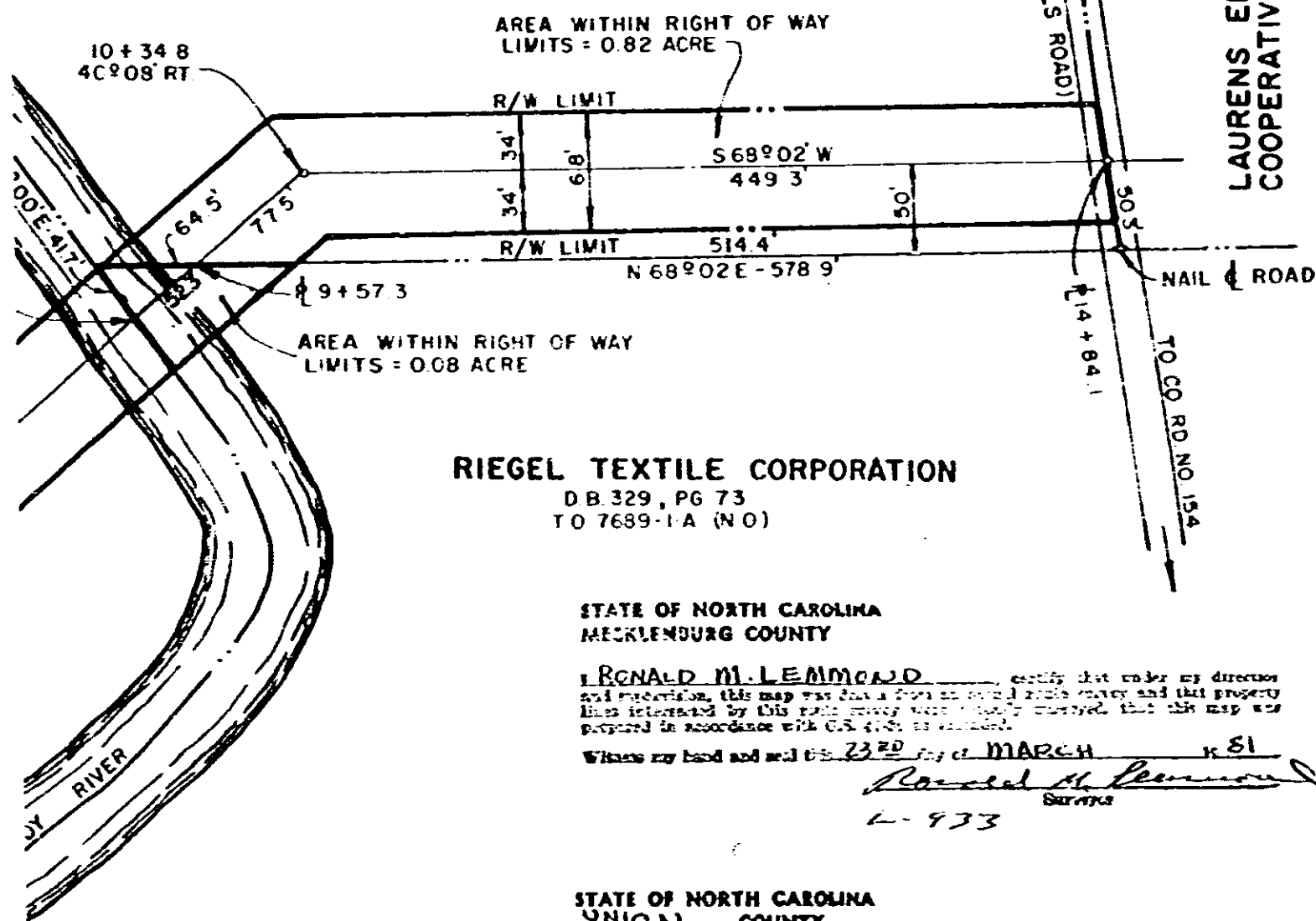

RIEDEL TEXTILE CORPORATION  
D B 329, PG 73  
T O 7689-1-A (N O)

STATE OF NORTH CAROLINA  
MECKLENBURG COUNTY

I, RONALD M. LEMMOND, certify that under my direction and supervision, this map was drawn from an original plat survey and that property lines indicated by this plat survey were actually surveyed, that this map was prepared in accordance with G.S. 41-62 as amended.

Witness my hand and seal this 23<sup>RD</sup> day of MARCH 1981

*Ronald M. Lemmond*  
Surveyor  
L-933

STATE OF NORTH CAROLINA  
UNION COUNTY

I, JOHN W. CROSS, a Notary Public of UNION County, North Carolina, do certify that RONALD M. LEMMOND, maker, personally appeared before me this day and acknowledged the due execution of the foregoing instrument.

Witness my hand and Notarial Seal this 23<sup>RD</sup> day of MARCH

1981

*John W. Cross*  
Notary Public

My Commission Expires September 16, 1985

DUKE POWER COMPANY  
MAP OF  
RIGHTS OF WAY  
FOR

LAURENS ELECTRIC COOPERATIVE  
DEL. NO. 3  
TRANSMISSION LINE  
FORK SHOALS, S.C.  
GREENVILLE COUNTY

RECORDED **MAY 13 1981**  
at 2:26 P.M.

31699

SCALE 1" = 100'  
BOOK NO. 1641

FEBRUARY 25, 1981  
FILE NO 161-82

100100

4328 RV-2