

Name and Post Office Address of Grantor NANNIE ROSS
1011 PARKER RD
GREENVILLE, S.C., 29611

Toll Line or Exchange Line tributary to GREENVILLE, SOUTH CAROLINA (Name) (Exchange)

The Property is bounded where the line enters and leaves this property by the property of:
DENNIS BARNES on the EAST
 and SUMTER STREET on the SOUTH

Authority C-6985 Classification R 45C

Area GREENVILLE, SOUTH CAROLINA

Approved _____

Title _____

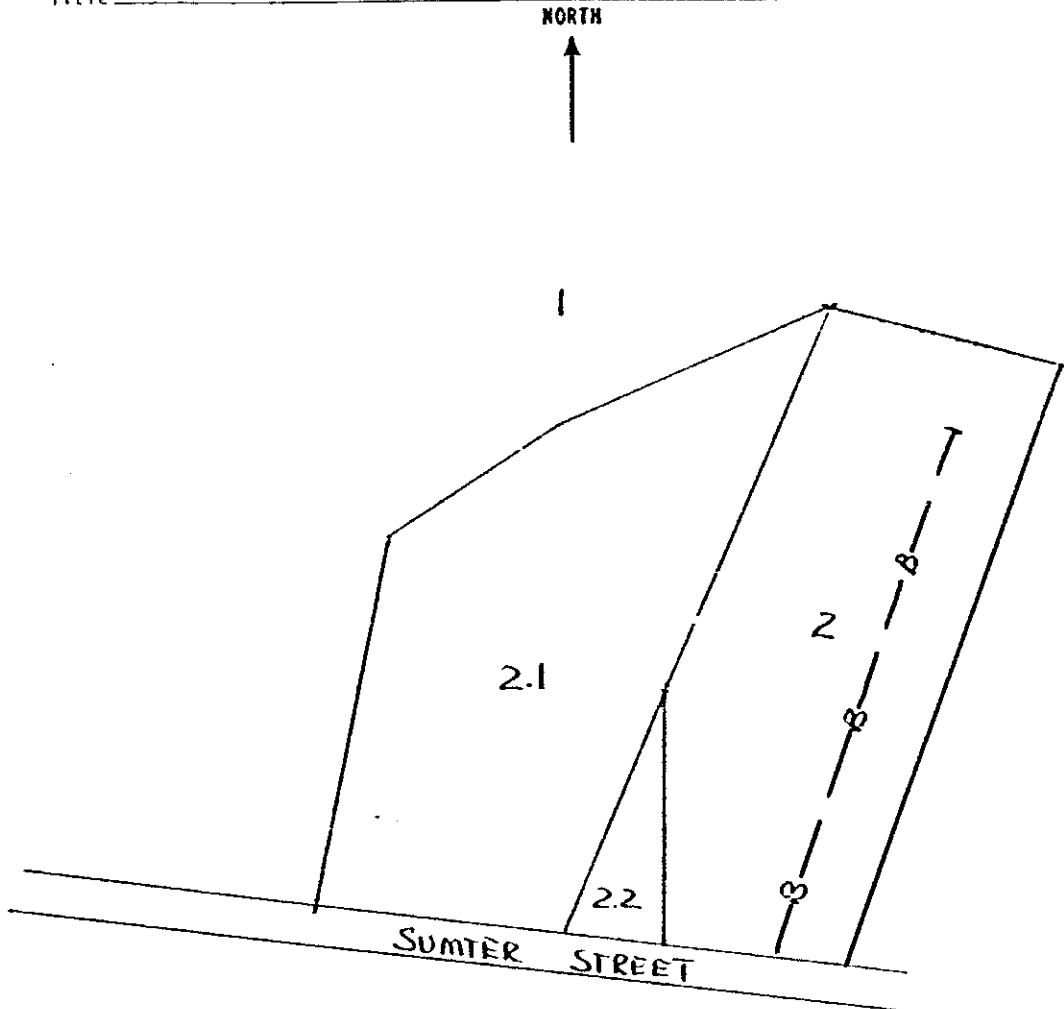

13082
 OCT 27 1980

RECORDED OCT 27 1980 at 11:12 A.M.

13082 X

Filed for record in the office of
 the R. M. C. for Greenville
 Co., S. C. at 11:12 o'clock
 A. M. Oct. 27, 19 80
 and recorded in Deed Book
 1136 at page 223
 R. M. C. for G. Co. S. C.

4328 RV-2

4328 RV-2