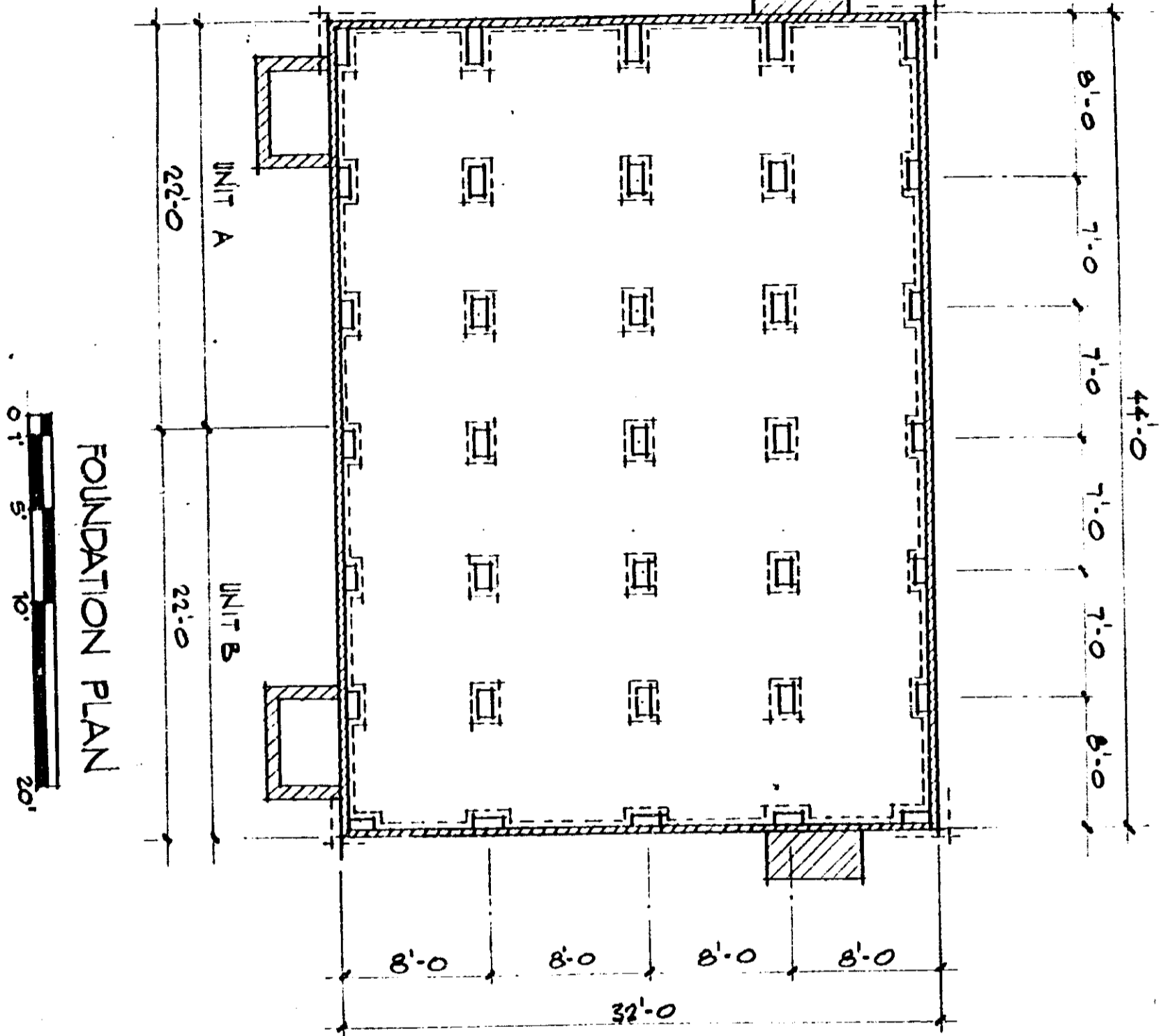

EXHIBIT A

BOOK 1133 PAGE 25



FOUNDATION PLAN

LIMITED COMMON ELEMENTS

CERTIFICATE

I, Wade H. Barber, do hereby certify that these plans fully depict within reasonable construction tolerances the layout, location letter identification, and dimensions of the buildings and dwellings contained therein.

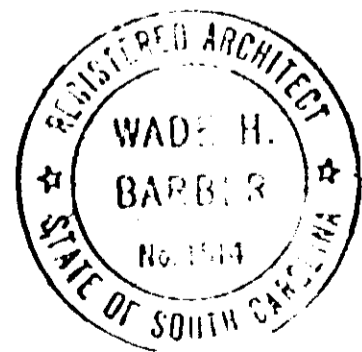

(CONTINUED ON NEXT PAGE)

*Wade Barber*

REV 0.0

4328 RV-2