

0974

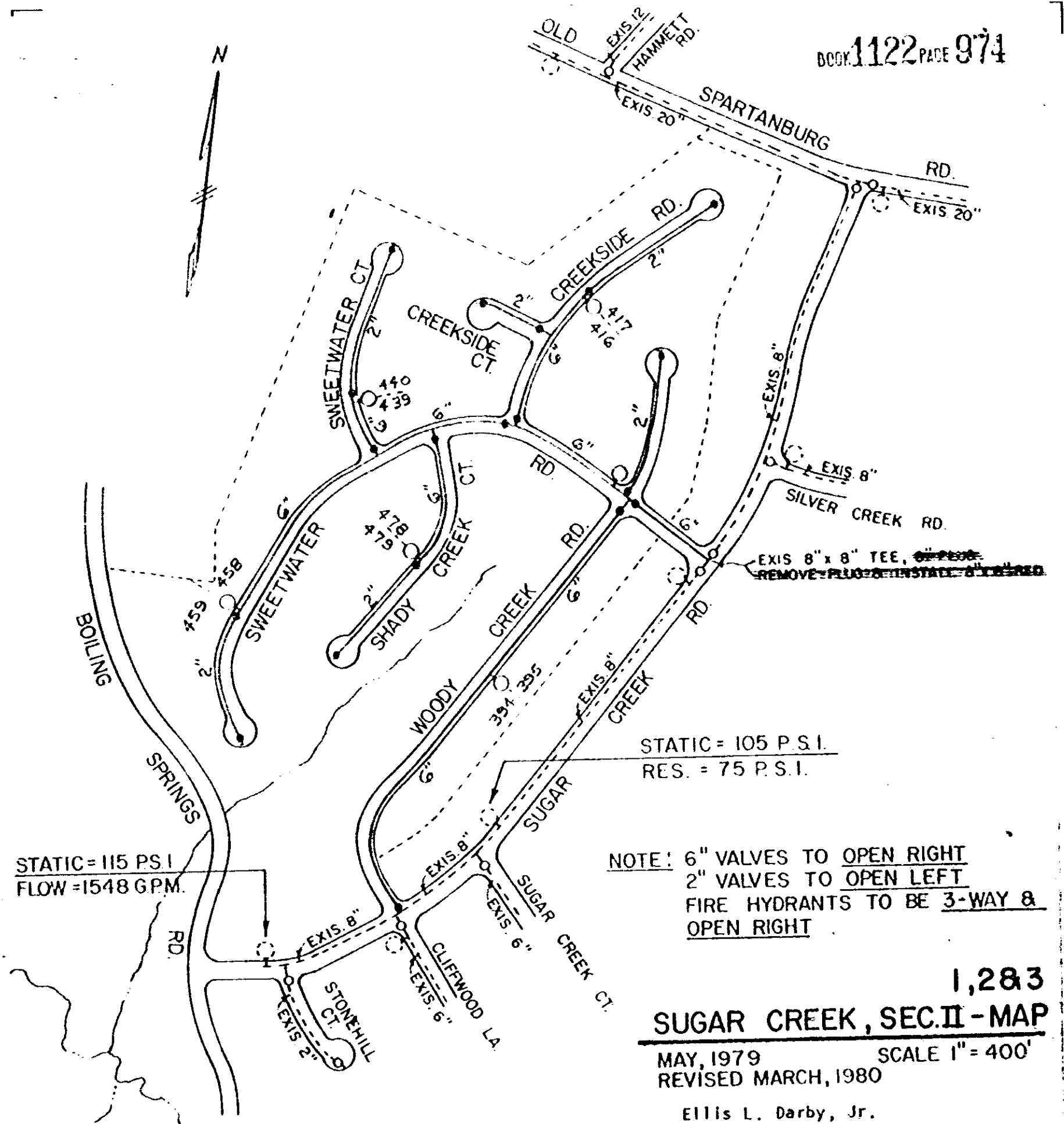

STATIC = 115 P.S.I.
FLOW = 1548 G.P.M.

STATIC = 105 P.S.I.
RES. = 75 P.S.I.

NOTE: 6" VALVES TO OPEN RIGHT
2" VALVES TO OPEN LEFT
FIRE HYDRANTS TO BE 3-WAY & OPEN RIGHT

1,283
SUGAR CREEK, SEC. II - MAP

MAY, 1979 SCALE 1" = 400'
REVISED MARCH, 1980

Ellis L. Darby, Jr.
H. Graham Proffitt, III
John C. Cothran Co., Inc.
to
Commissioners of Public Works
of the City of Greenville, S. C.
March 13, 1980
(Block Book 534.3-1-1, 538.7-1-27,
34 & Pl. 33.1)

Material List:

6" D. I. Pipe	4,750'
2" Galv. Pipe	2,625'
6" Valves	13
2" Valves	12
Fire Hydrants	6

RECORDED **MAR 28 1980**
at 3:06 P.M.

25803

4328 RV-2