

VOL 1074 PAGE 513

Name and Post Office Address of Grantor James M. Hicks  
100 Wilderness Lane  
Greenville, South Carolina

Toll Line or Exchange Line tributary to Woodruff Road Wire Center  
(Name) (Exchange)

The Property is bounded where the line enters and leaves this property by the property of John Douglas on the East

and \_\_\_\_\_ on the \_\_\_\_\_  
Authority 843-1163 Classification 45-C

Area \_\_\_\_\_

Approved \_\_\_\_\_

Title District Engineer

NORTH

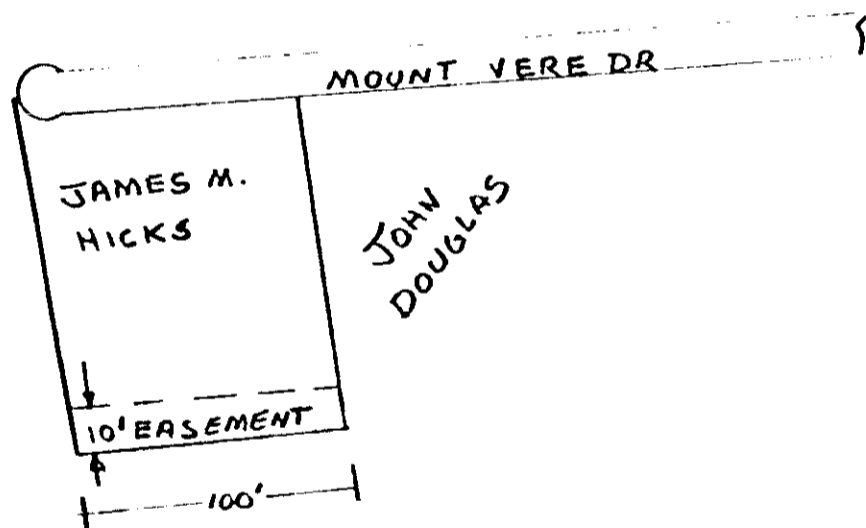

B 7 5 0

4328 RV-2