

ES&B

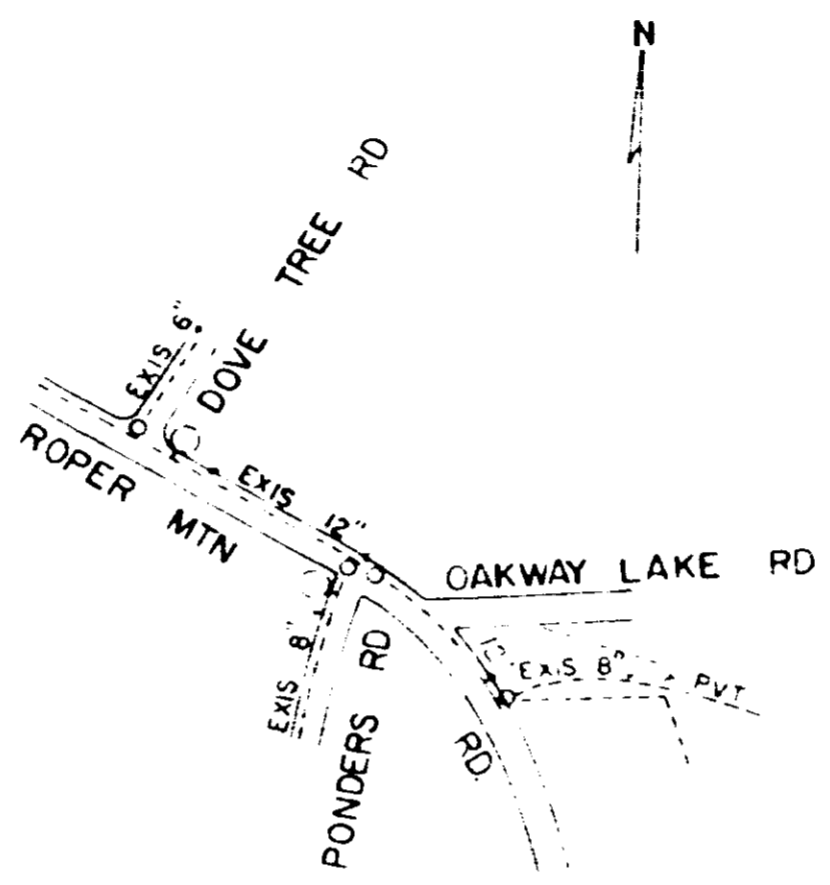

ROPER MOUNTAIN APARTMENTS

MARCH, 1977 SCALE 1" = 400'

This plan shows the layout of the Roper Mountain Apartments. The site is bounded by Roper Mountain to the north and Ponders Road to the south. The plan shows the location of the existing building and the proposed new building. The proposed building is located on the east side of Roper Mountain, between Dove Tree Road and Oakway Lake Road. The plan also shows the location of the parking area and the entrance to the site.

RECORDED AUG 12 1977

At 3:01 P.M.

4864

4328 RV-2