

THE PEOPLES NATIONAL BANK
REF DWG NO 53-174-A

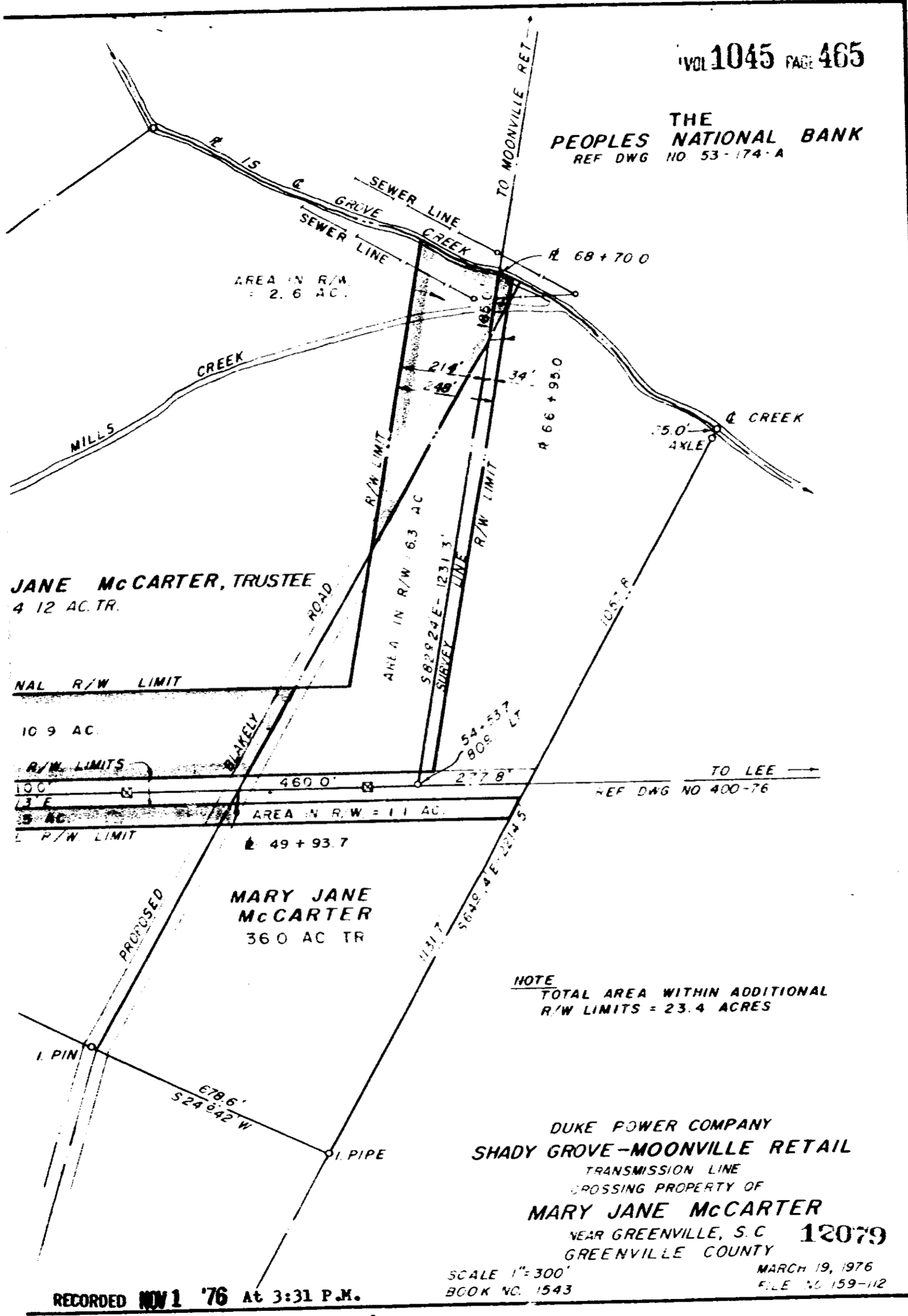

NOTE
TOTAL AREA WITHIN ADDITIONAL
R/W LIMITS = 23.4 ACRES

DUKE POWER COMPANY
SHADY GROVE-MOONVILLE RETAIL
TRANSMISSION LINE
CROSSING PROPERTY OF
MARY JANE McCARTER
NEAR GREENVILLE, S.C. 12079
GREENVILLE COUNTY

RECORDED NOV 1 '76 At 3:31 P.M.

SCALE 1"=300'
BOOK NO. 1543

MARCH 19, 1976
FILE NO. 159-112

4328 (N.2)