

Name and Address  
 Franklin Enterprises, Inc.  
 2320 East North St. Suite RR  
 Greenville, S. C. 29607

Telephone  
 Line  
 Exchange Line Greenville  
 Exchange

The Property is bounded where the line enters and leaves this property by the property of  
Edwards St. on the west side  
Shockley St. on the east side

County 543-2220 Classification 945-C  
 Area Greenville, South Carolina  
 District District Engineer

Right of Way

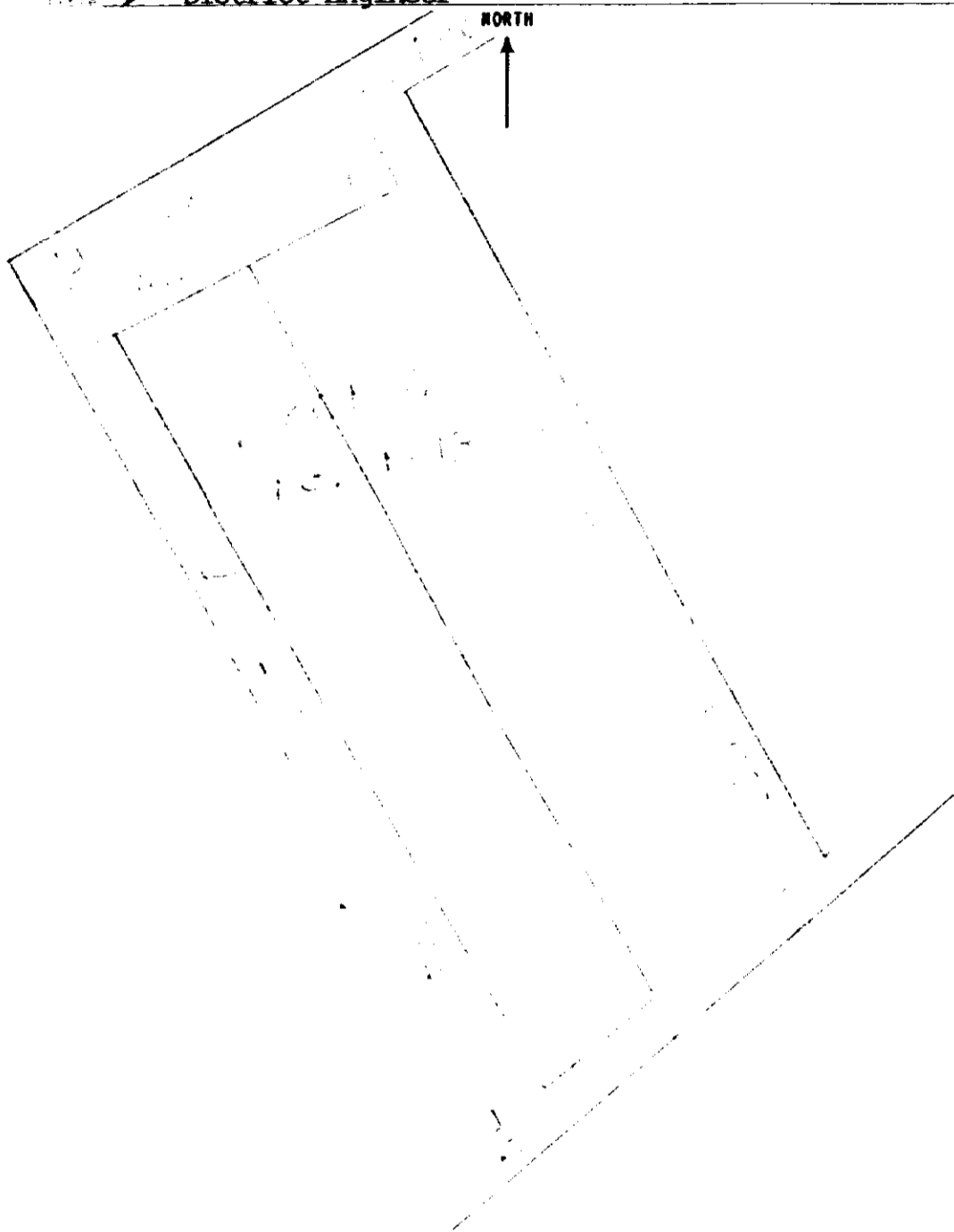

FEB 24 1976  
2:11 PM

*R/W Easement*

*Attn: 1961*

Filed for record in the office of  
 the S. M. C. for Greenville  
 County, S. C. at 10:30 o'clock  
 A. M. Feb. 24, 1976  
 and recorded in Deed Book  
 1032 at page 50

RECORDED FEB 24 '76 At 10:30 A.M.

# 2:11

4328 RW-25