

Name and Post Office Address of Applicant: **William B. Little**  
**4012 Park Road**  
**Charlotte, North Carolina 28209**

Toll Line or Exchange Line tributary to: **Greenville**

The Property is bounded where the line enters and leaves this property by the property of:  
**Montague Road** on the **southeast**  
and **Duncan Chapel Road** on the **northeast**

Authority: **443-1918** Classification: **945-C**

Area: **South Carolina**

Approved: \_\_\_\_\_  
Title: **District Engineer**

0428

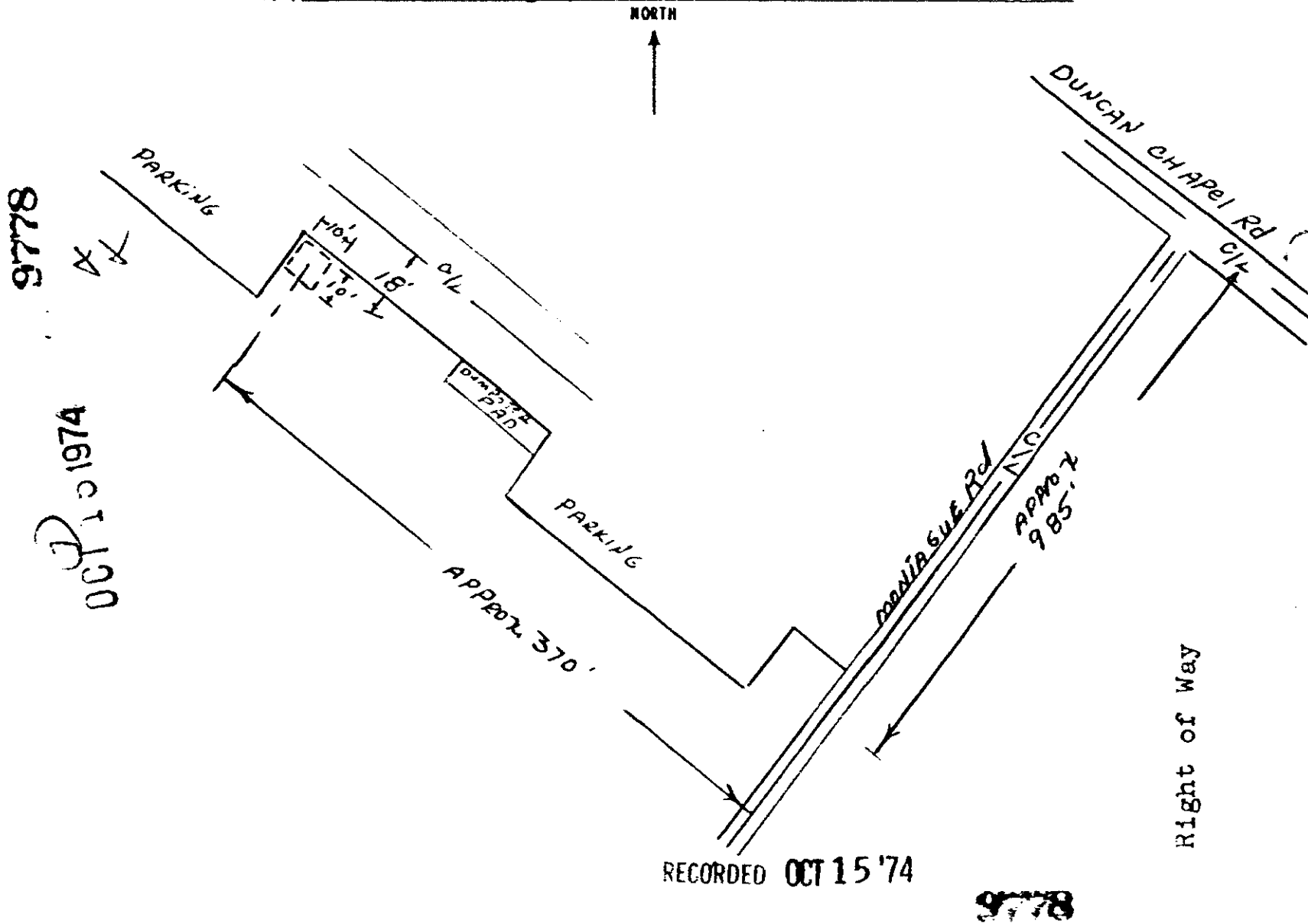

9778  
AZ  
OCT 15 1974

RECORDED OCT 15 '74

9778

Filed for record in the office of the R. M. C. for Greenville county, S. C. at 11:16 o'clock A. M. Oct. 15, 1974, and recorded in Deed Book 1008 at page 427

R. M. C. for G. Co. S. C.

Woodwinds Limited Pts.

TO

Southland Bell Telephone Co

Telephone Co