

# CHARTER OAKS HORIZONTAL PROPERTY REGIME SHEET 1 of 2 GREENVILLE COUNTY, SOUTH CAROLINA

MARCH 25, 1974

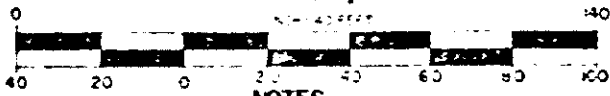

### NOTES

1. Zoning of property, according to Greenville County Zoning Office, is R-M (Residential, Multi-family District). According to Article 6-14.2 of the Greenville County Zoning Ordinance, the building setback line is 15 feet from an exterior property line and 35 feet from a public right-of-way.
2. All dimensions locating buildings on Horizontal Property Regime are at 90°-00' angles to property lines.
3. Parking shows taken from Charter Oaks Site Plan and field survey revisions.
4. All interior and exterior wall angles are 90°-00' angles.

### CERTIFICATE

This is to certify that we surveyed the property shown on this plat, and that the property lines and buildings are as shown hereon, that the buildings located on shown property do not encroach or project on adjacent streets or property, and that no adjacent buildings or walls encroach or project on shown property, and that building locations are correct. We further certify that the floor plans shown on Sheet 2 are correct according to dimensions taken from Charter Oaks Limited construction drawings, furnished by owner.

*R. H. Dickinson*  
Registered Land Surveyor & Professional Engineer # 3531  
Eneright Assoc., Inc.

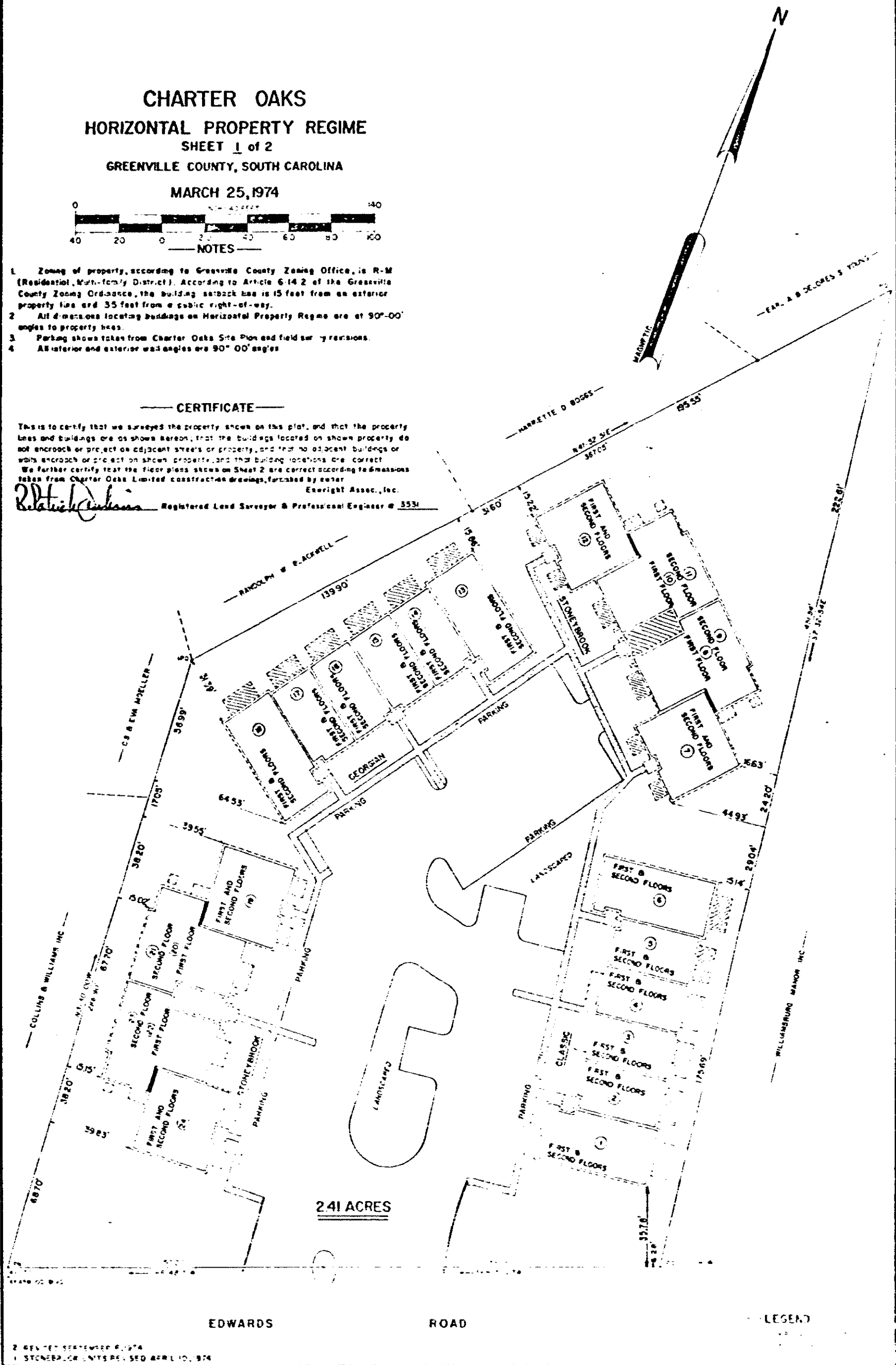

0 2 3 9

4328 RV-2