

0091

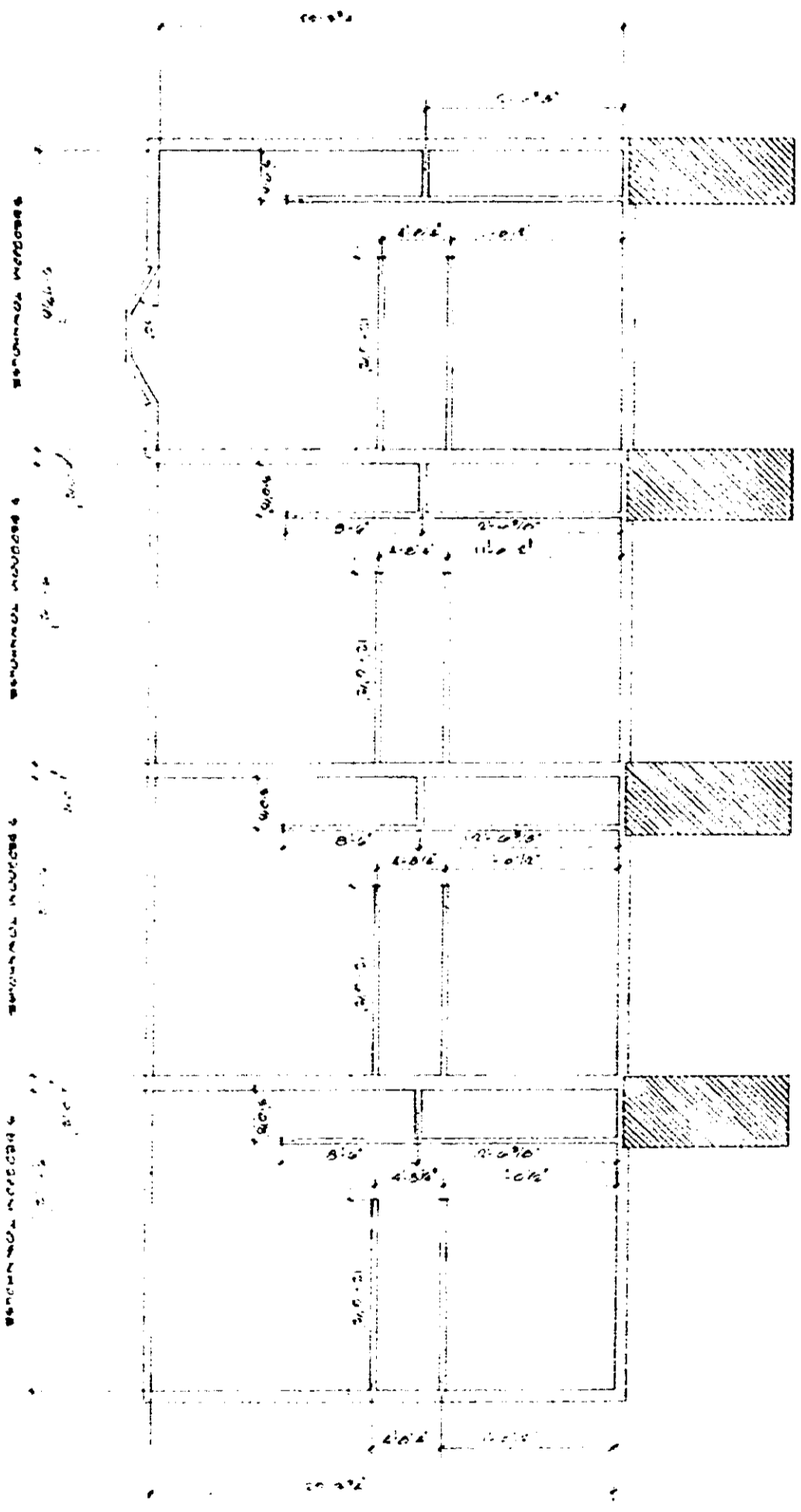

**NOTES**

1. THE BUILDING SHOWN IN THIS PLAN CONSISTS OF FOUR THREE ROOM TOWNHOUSES WITH
2. EACH UNIT CONSISTS OF THE SPACE BOUNDED BY THE INDICATED WALLS AND UNFINISHED
3. WALLS AND CEILING. ALL INTERIOR AND EXTERIOR WALLS ARE TO BE CONCRETE.

**FOUR THREE ROOM TOWNHOUSES**

THE WALLS AND HORIZONTAL PROPERTY BOUNDARY

BOUNDARY OF UNIT  
 COMMON ELEMENTS  
 UNITS COMMON ELEMENTS

**ADJ. TOWN & CERTIFICATE**

I HEREBY CERTIFY THAT TO THE BEST OF MY KNOWLEDGE AND BELIEF THE INFORMATION FURNISHED HEREIN IS TRUE AND CORRECT.

*Asst. City Clerk*  
 CITY OF LOS ANGELES  
 MAY 15 1958

4 2 4 7 5 5 5 5 8

2 1 1 4