

GREENVILLE CO. S. C.

MAY 11 11 34 AM '73

VOL 974 PAGE 421

HORTON, DRAWDY, DILLARD, MARCHBANKS, CHAPMAN & BROWN, P.A., 307 FETTING STREET, GREENVILLE, S. C. 29603

STATE OF SOUTH CAROLINA

R.H.C.

For True Consideration See Affidavit

COUNTY OF GREENVILLE

Book 37 Page 121

5700

Greenville County
Stamps
Paid \$ 3135
Act No. 380 Sec. 1

KNOW ALL MEN BY THESE PRESENTS, that Elva L. Grady

in consideration of Ten Dollars (\$10.00) and other good and valuable considerations the receipt of which is hereby acknowledged, have granted, bargained, sold, and released, and by these presents do grant, bargain, sell and release unto John W. Grady, III, his heirs and assigns, forever:

ALL MY RIGHT, TITLE AND UNDIVIDED INTEREST IN AND TO:

ALL those pieces, parcels or lots of land, together with all buildings and improvements, situate, lying and being on the northeastern side of Hampton Avenue, in the City of Greenville, Greenville County, South Carolina, being shown and designated as Lots 18.1, 19 and 20 in Block 1 on Sheet 18 of the Greenville County Tax Maps and being a portion of property owned by Loula McBee Briggs, William A. Briggs and Henry Briggs, and being more particularly described:

LOT 20: BEGINNING at an iron pin on the northeastern side of Hampton Avenue at the corner of property formerly belonging to Sue D. Gentry and running thence N. 40-10 E. 239.4 feet with Gentry's property to an iron pin on an alley; thence N. 43-12 W., 54 feet to an iron pin in the line of Lot 19; thence with the line of Lot No. 19 (also formerly owned by Loula M. Briggs) S. 40-40 W., 245 feet to an iron pin on Hampton Avenue; thence with the northeastern side of Hampton Avenue, S. 49-20 E., 55.75 feet to an iron pin, the beginning corner, being property conveyed by Loula M. Briggs to William A. Briggs by deed recorded in the RMC Office for said county and state in Deed Book 106, page 554, a small triangular portion of which was conveyed to Loula M. Briggs by deed of Sue D. Gentry, recorded in Deed Book ZZZ, page 1, and originally conveyed to E. Loula McBee (being the same person as Emala Louisa McBee and Loula McBee Briggs) by deeds recorded in the RMC Office for said county and state in Deed Book 00, pages 244 and 246.

LCT 19: BEGINNING at a point on the northeastern side of Hampton Avenue at the corner of Lot 20 above described and running thence with the northeastern side of Hampton Avenue 90.40 feet to a point; thence continuing with said side of Hampton Avenue 10 feet to a point; thence in a northeasterly direction along the side line of lot 18.1 247 feet to a point on the western side of an alley; thence with said alley 10 feet to a point; thence continuing with said alley 90.81 feet to a point on the line of Lot 20 above described; thence with the side line of Lot No. 20 in a southwesterly direction 245 feet to a point on Hampton Avenue, the point of beginning, the same being a 10 foot strip conveyed by deed of Henry Briggs to Loula M. Briggs recorded in Deed Book 200, page 224, and being a portion of property conveyed by deed of Harriett B. McBee, et al, to Loula M. Briggs (then known as Emala Louisa McBee or Loula M. McBee) by deeds recorded in the RMC Office for said county and state in Deed Book 00, page 244 and 246, a portion of said property being shown on a plat of one acre, more or less, recorded in Deed Book 00, page 712. The above mentioned 10 foot strip is a part of the same conveyed by V. E. McBee, Sr., et al to F. B. McBee by deed recorded in Deed Book 000, page 213, and by deed recorded in Deed Book KKK, page 11.

LOT 18.1: BEGINNING at a stone pier on the northeastern side of Hampton Avenue at the corner of property formerly owned by Mrs. Kate Nelson and running thence along said side of Hampton Avenue, N. 47-24 W. 70.25 feet to a point on the line of the above described 10 foot strip; thence N. 40-00 E. along a stone wall 240 feet to a point on an alley; thence along the western side of said alley, S. 53-30 E. 67.3 feet to a point on the line of said 10 foot strip, now a part of Lot No. 19 above described; thence along the line of

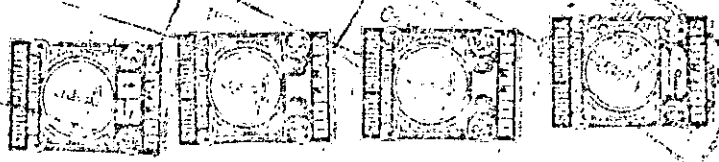

(Continued on next page)