

N.

JEREMIAH PRESTON BATES, ET AL.
REF. DWG. NO. 1-224

WILLIAM EDWARD BATSON, ET AL.

CORA V. COBB

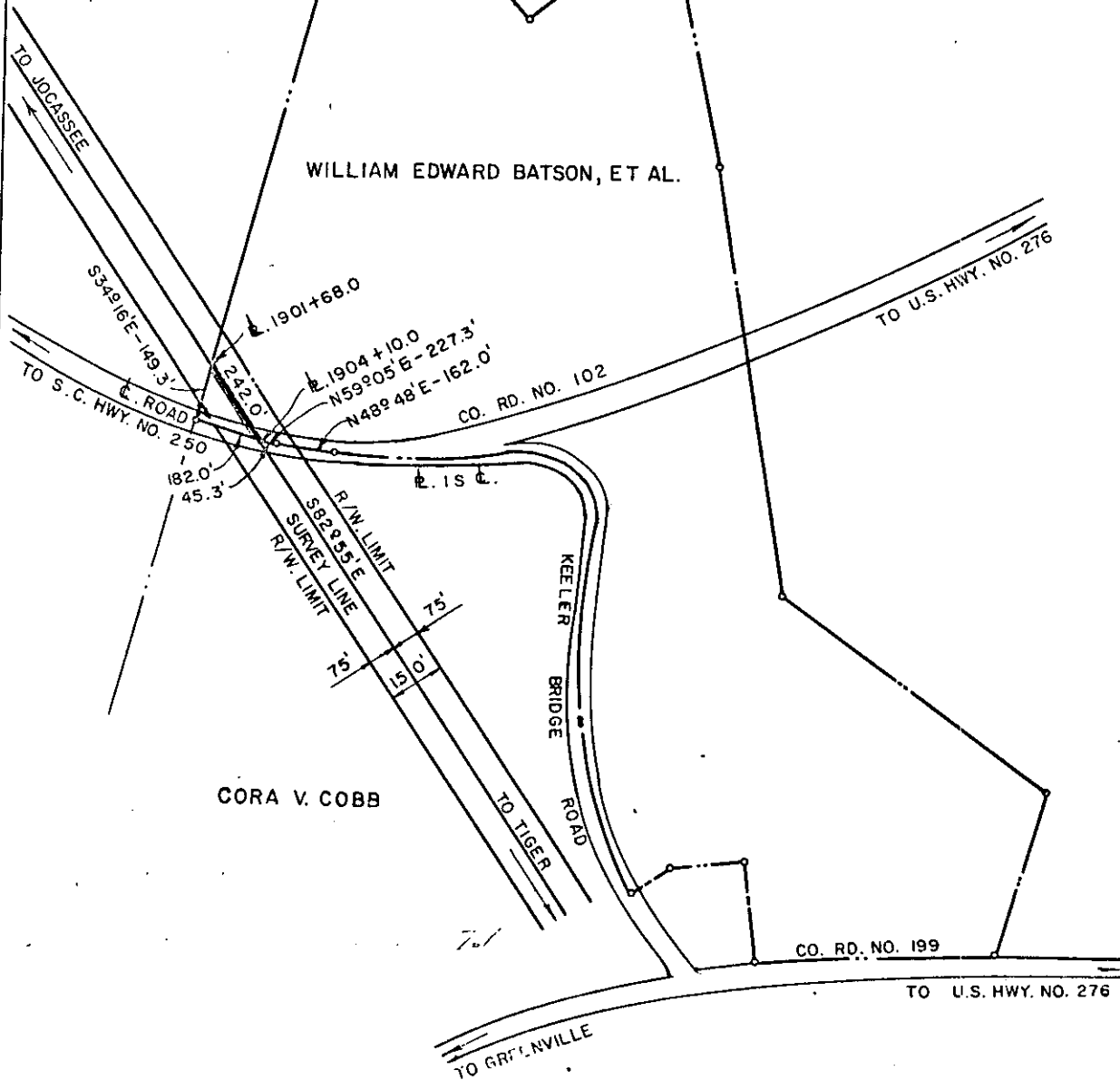

DUKE POWER COMPANY
 JOCASSEE - TIGER
 TRANSMISSION LINE
 CROSSING PROPERTY OF
 WILLIAM EDWARD BATSON, ET AL.
 NEAR MARIETTA, S.C.
 BATES TOWNSHIP
 GREENVILLE COUNTY

Recorded July 16th, 1970 at 12:40 P.M.
 T. O. NO. 7123-61 #1224

SCALE 1" = 400'
 BOOK NO. 114-

MARCH 12, 1970
 FILE NO. 1-212