

43

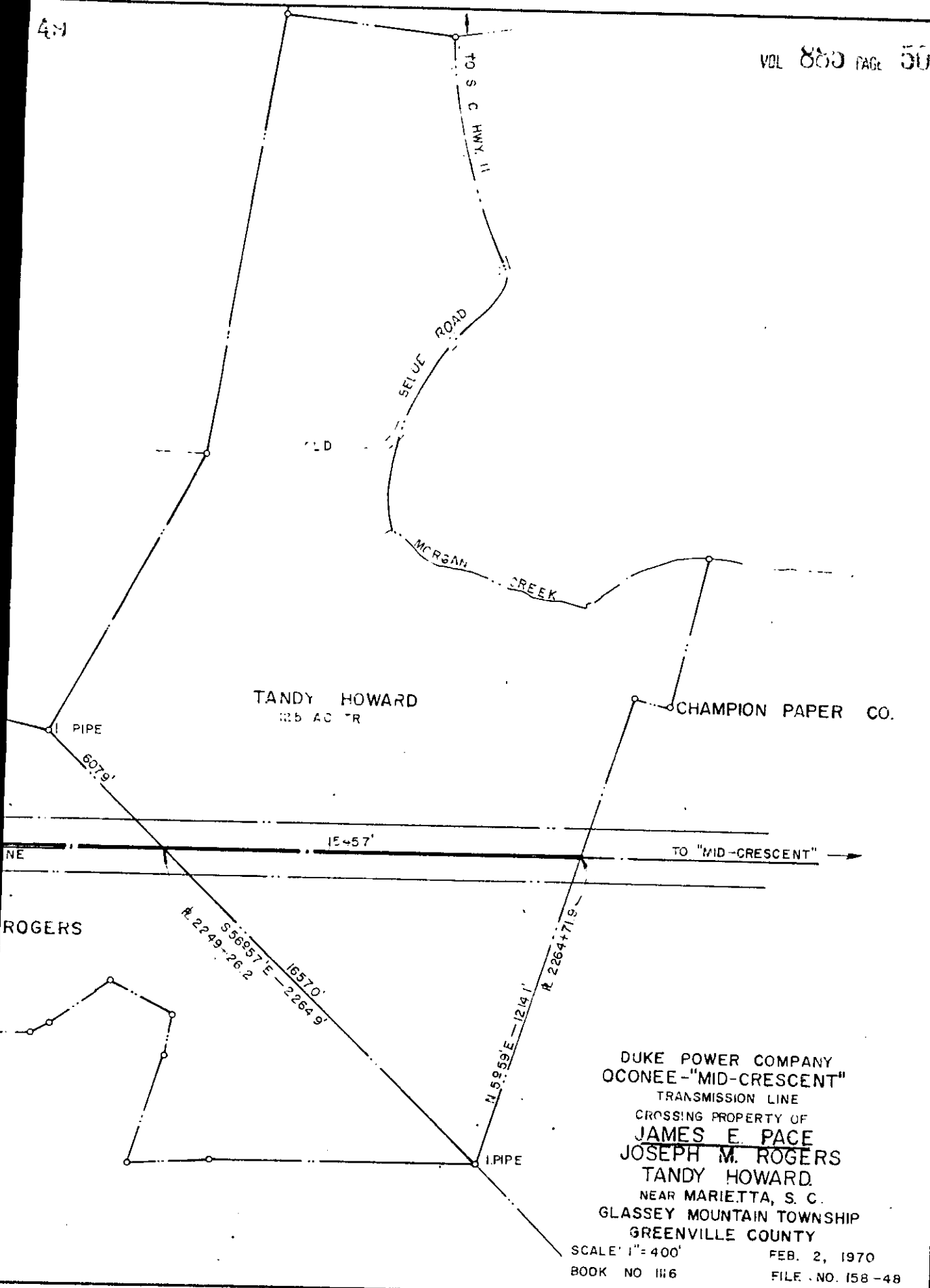

DUKE POWER COMPANY
 OCONEE-"MID-CRESCENT"
 TRANSMISSION LINE
 CROSSING PROPERTY OF
 JAMES E. PACE
 JOSEPH M. ROGERS
 TANDY HOWARD
 NEAR MARIETTA, S. C.
 GLASSEY MOUNTAIN TOWNSHIP
 GREENVILLE COUNTY

SCALE: 1" = 400'
 BOOK NO 116
 FEB. 2, 1970
 FILE NO. 158-48

Recorded February 24th, 1970 at 12:51 P.M. CTS #18636