

BRAMLETTE STREET

EVANS STREET

SOUTHERN WEAVING COMPANY

WEST NINTH STREET

SOUTHERN WEAVING COMPANY

TO GREENVILLE MAN

TO GREENVILLE

NOTE: FOR DETAILS OF SUBSTATION LOT SEE BELOW.

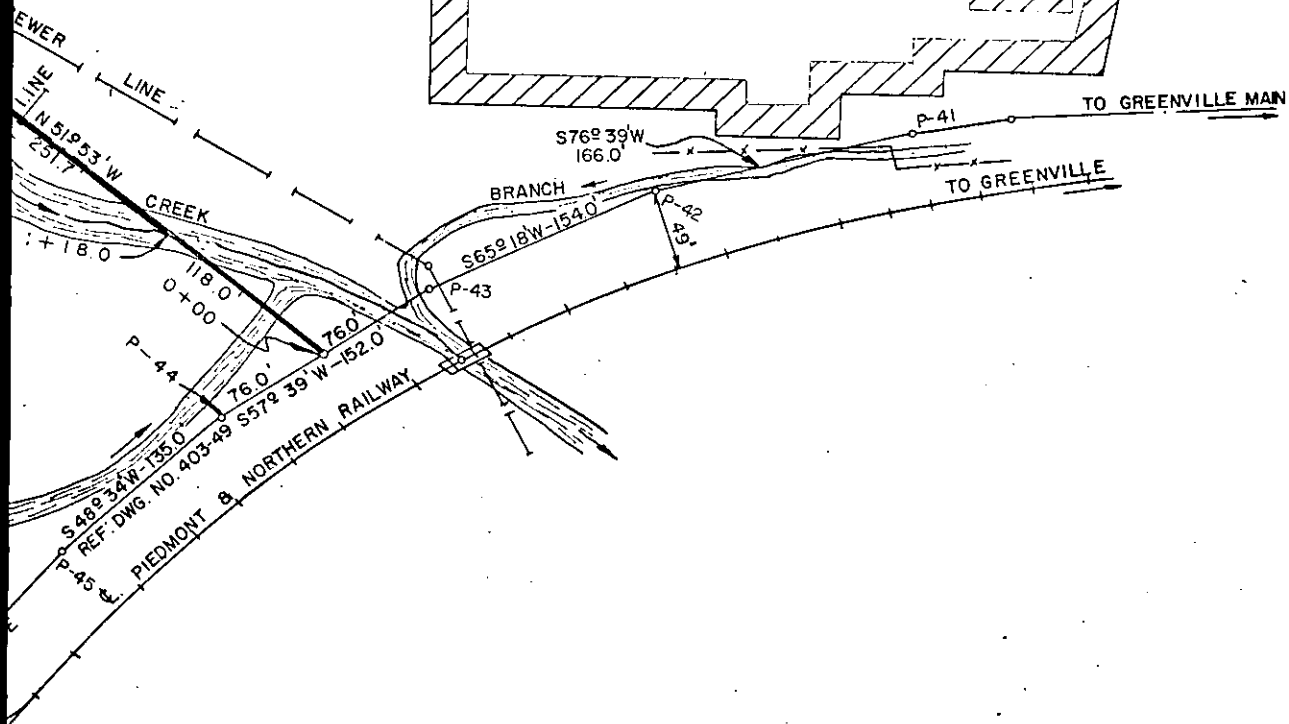

NOTE: REVISED 6-23-69

DUKE POWER COMPANY
 SUBSTATION LOT
 AND
 TRANSMISSION LINE
 LEASED FROM
 AND
 TO SERVE
 SOUTHERN WEAVING COMPANY
 GREENVILLE, S.C.
 GREENVILLE COUNTY

SCALE: 1"=100'
BOOK NO. 1029

MAY 23, 1969
FILE NO. 156-23

Plat Recorded July 14th, 1969 at 9:45 A.M. #984