

ARTHUR H. MOEHLBROCK
REF. DWG. NO. 29-189-A

CRECO INC.

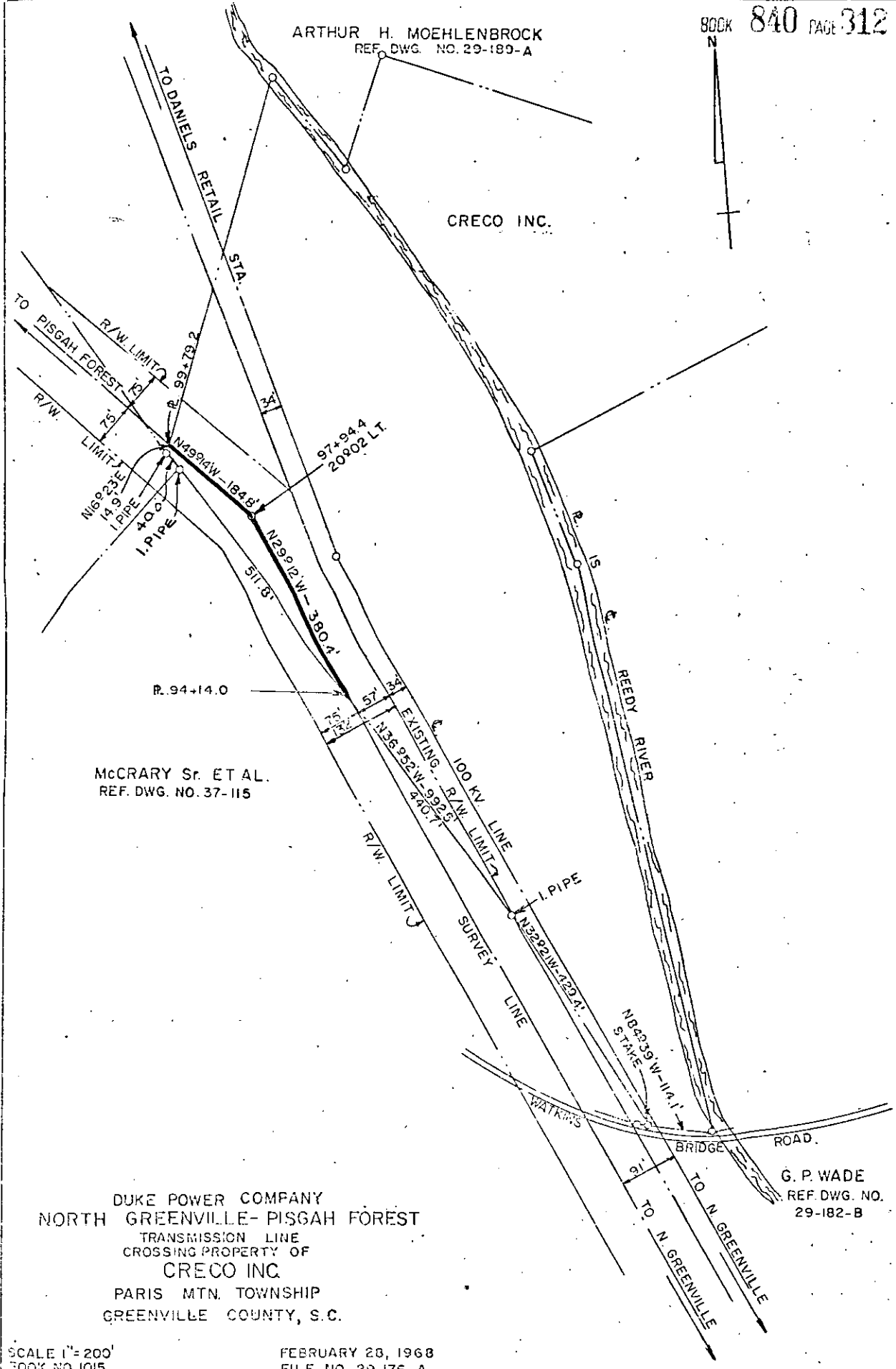

McCARY Sr. ET AL.
REF. DWG. NO. 37-115

G. P. WADE
REF. DWG. NO. 29-182-B

DUKE POWER COMPANY
NORTH GREENVILLE- PISGAH FOREST
TRANSMISSION LINE
CROSSING PROPERTY OF
CRECO INC.
PARIS MTN. TOWNSHIP
GREENVILLE COUNTY, S.C.

SCALE 1" = 200'
BOOK NO. 1015

FEBRUARY 23, 1968
FILE NO. 29-176-A

Recorded March 26, 1968 At 4:38 P.M. # 25027