

W. H. WILLIMON, ESTATE
REF: DWG. NO. 34-145

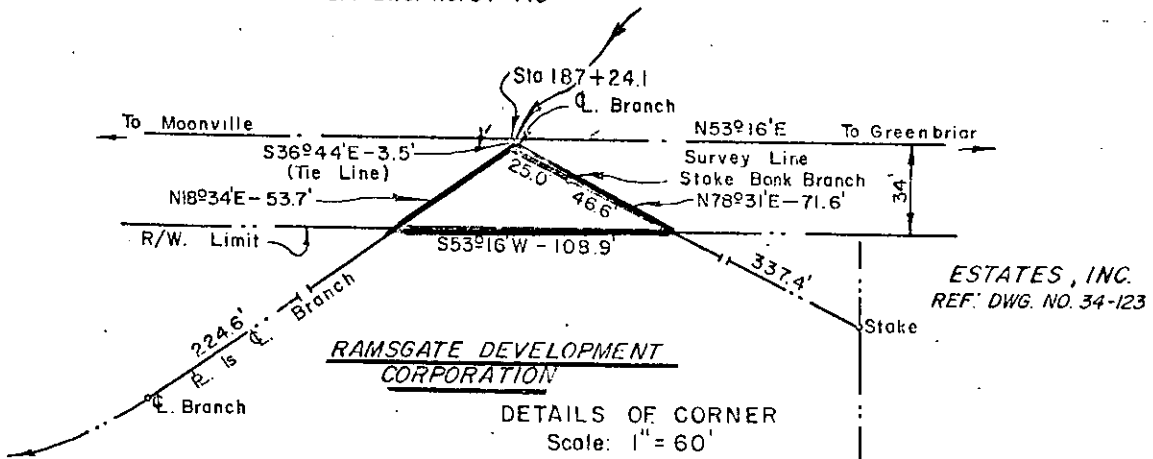

J. G. LEATHERWOOD
REF: DWG. NO. 34-134

W. H. WILLIMON, ESTATE
REF: DWG. NO. 34-145

For Details Of
Corner See Above
R/W. Limit

ESTATES, INC.
REF: DWG. NO. 34-123

DAVID J. ADAMS
REF: DWG. NO. 34-126

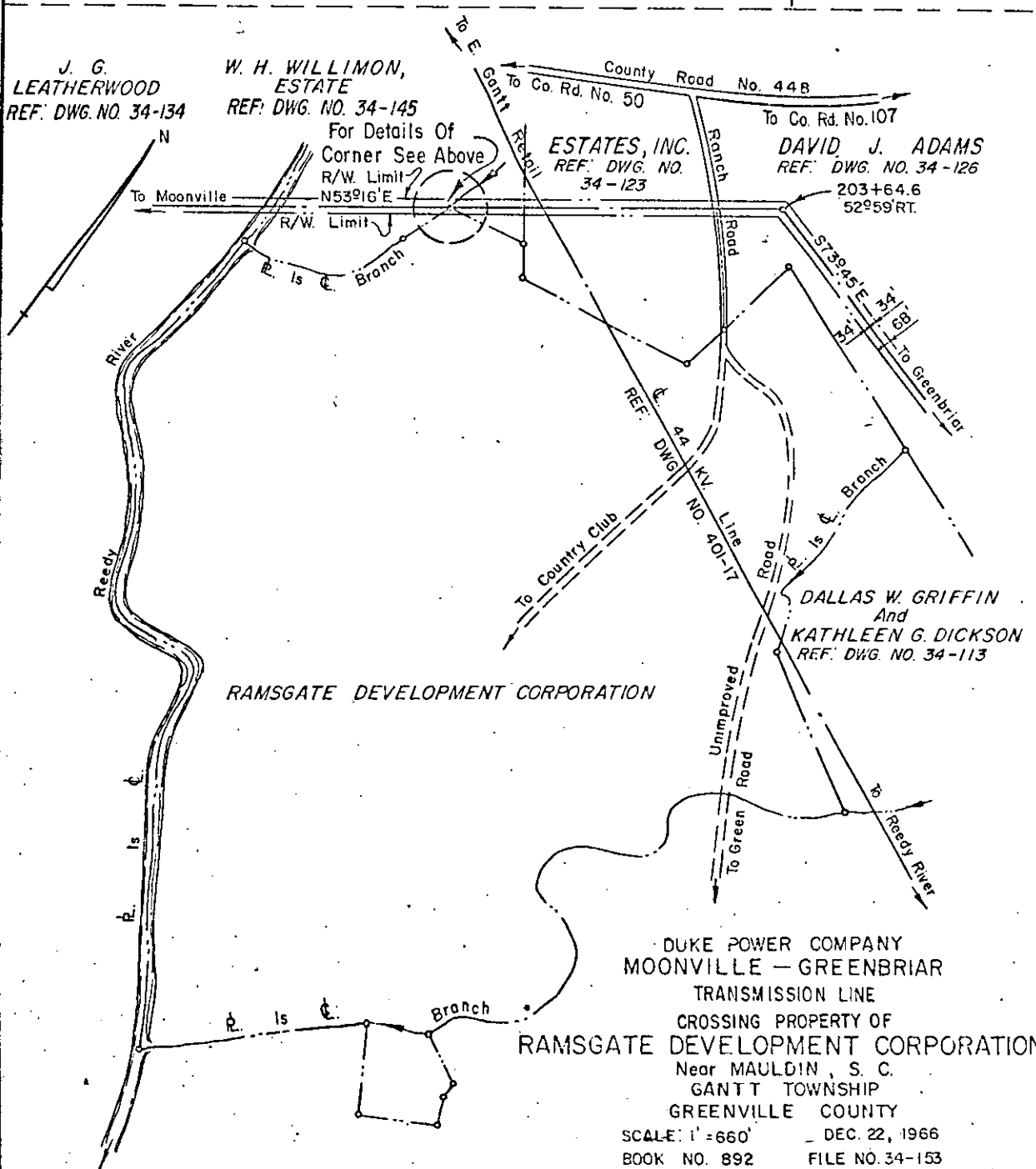

Recorded October 2, 1967 At 2:33 P.M. # 9755