

LINDE COMPANY DIV. OF UNION CARBIDE CORP.
"GREENVILLE PLANT, KEMET DEPT. LINDE COMPANY"

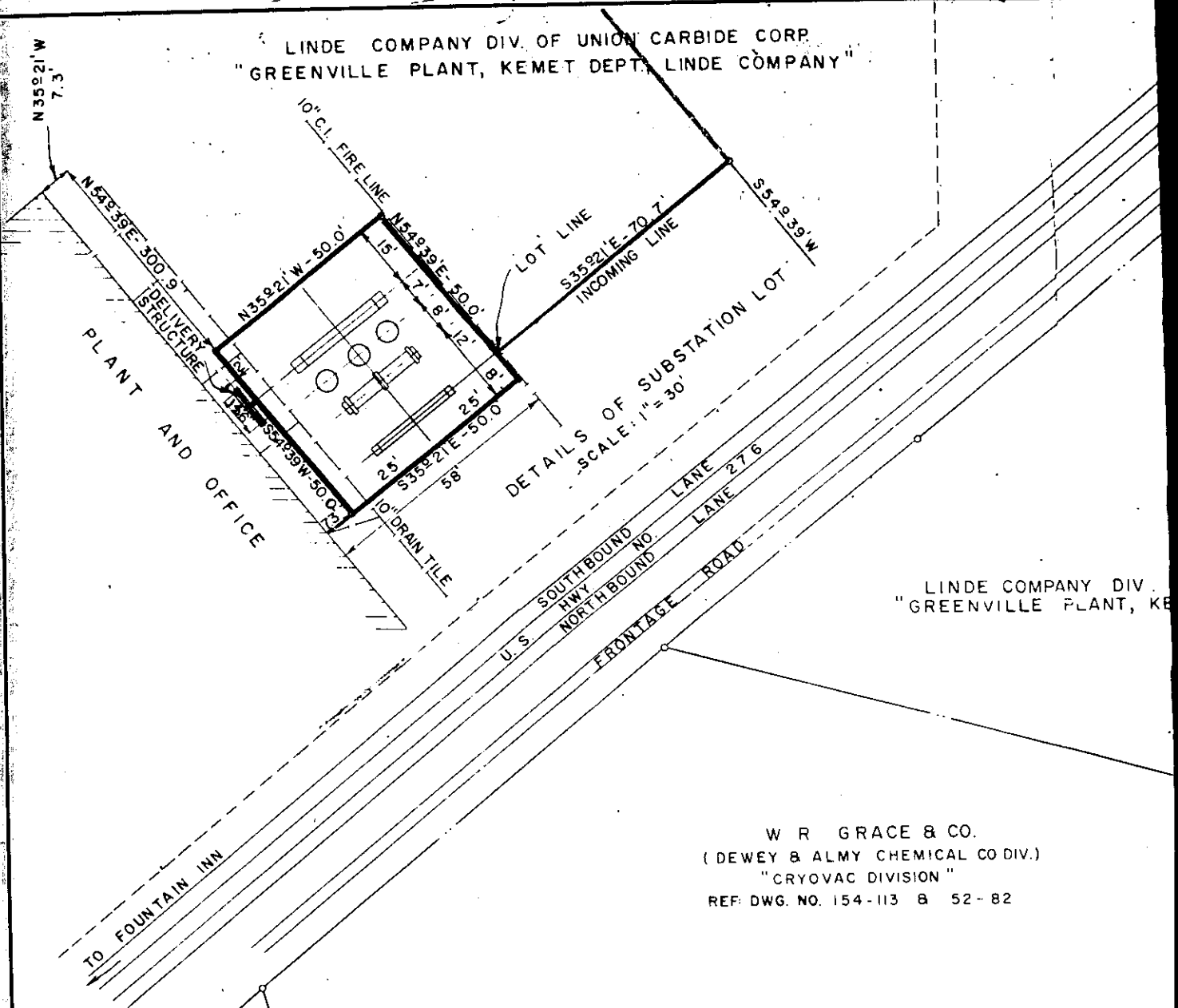

LINDE COMPANY DIV.
"GREENVILLE PLANT, KE

W R GRACE & CO.
(DEWEY & ALMY CHEMICAL CO DIV.)
"CRYOVAC DIVISION"
REF DWG. NO. 154-113 B 52-82

CLYDE C. GARRETT

Recorded January 10th., 1966 At 9:30 A.M. # 20320

record