

R/W OF RAILROADS, PERIMETER ROAD
TO NEWLON INDUSTRIAL INC.

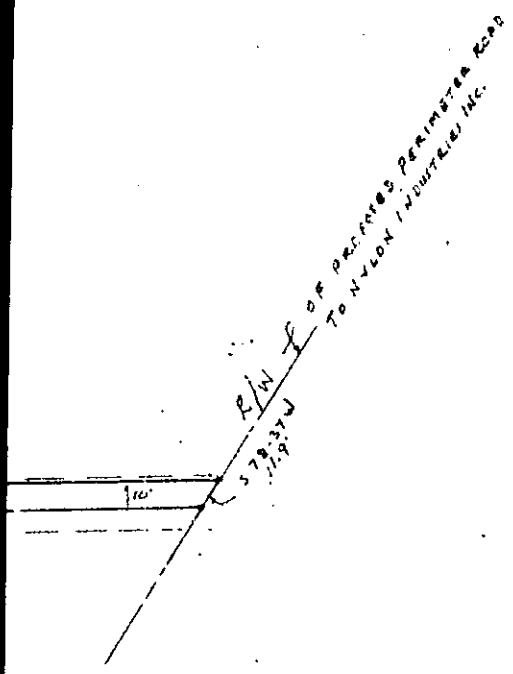

AD (APPROX. S.C. HWY. 146)
TO I-85

SURVEYED BY R.K. GUY BELL - RES.
AND H.C. CLARKSON - RES.

dated July 24, 1964 At 4:07 P.M. # 2972

27-64