

17. 258

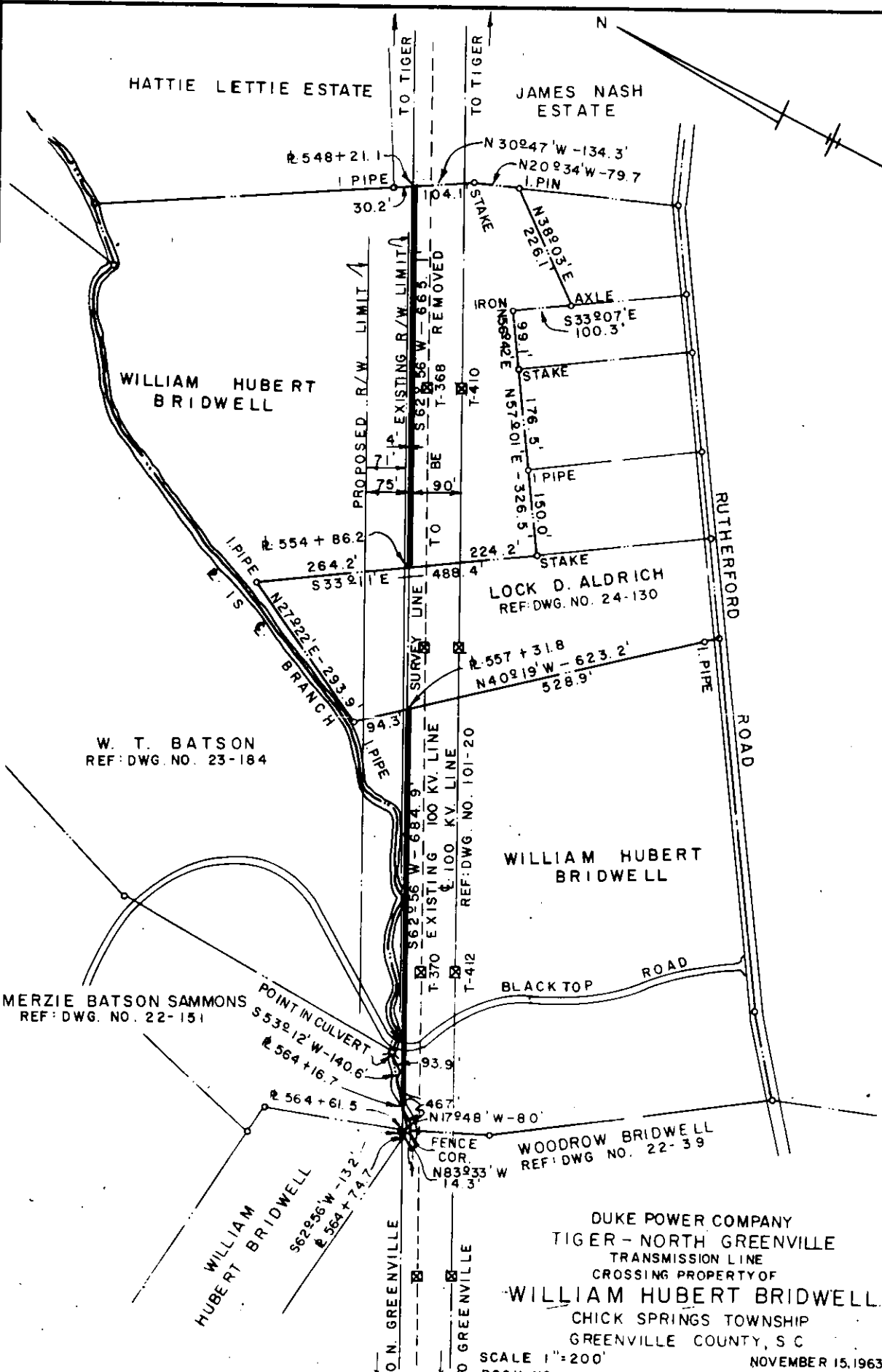

DUKE POWER COMPANY
 TIGER - NORTH GREENVILLE
 TRANSMISSION LINE
 CROSSING PROPERTY OF
WILLIAM HUBERT BRIDWELL
 CHICK SPRINGS TOWNSHIP
 GREENVILLE COUNTY, S C

SCALE 1" = 200'
 BOOK NO. 627
 NOVEMBER 15, 1963
 FILE NO. 24-197

Recorded December 20, 1963 At 4:43 P.M. # 17943